



Ffordd Cadfan, offers in excess of £190,000

- 3 bedroom mid-terraced townhouse
- Driveway to the front
- Well-presented throughout
- Council Tax Band D
- Viewing Highly recommended
- EPC Rating: B



 3
  1
  1



About the property

Spacious & Well-Presented Three-Bedroom Townhouse in Ffordd Cadfan, Brackla

Situated in the sought-after Ffordd Cadfan development in Brackla, this modern three-bedroom, three-storey mid-terrace townhouse offers spacious and contemporary living in a prime location.

The property welcomes you with a bright entrance hallway, leading into a stylish open-plan lounge, kitchen, and dining area, perfect for modern family life and entertaining. A separate downstairs cloakroom adds to the convenience of the ground floor.

To the first floor, you'll find two well-proportioned bedrooms and a family bathroom, while the impressive master suite occupies the entire second floor, providing a private and tranquil retreat.

Externally, the property benefits from off-road parking to the front and a spacious enclosed rear garden, ideal for outdoor enjoyment.



Accommodation

Entrance Hall

Open Plan Lounge/Kitchen/Diner

22' 2" max x 12' 2" max (6.76m max x 3.71m max)

Cloakroom

First Floor

Landing

Bedroom Two

12' 1" x 5' 11" (3.68m x 1.80m)

Bedroom Three

12' 2" max x 7' 10" max (3.71m max x 2.39m max)

Second Floor

Bedroom One

20' 10" max x 8' 9" max (6.35m max x 2.67m max)

01656 657201

bridgend@peteralan.co.uk

Floorplan

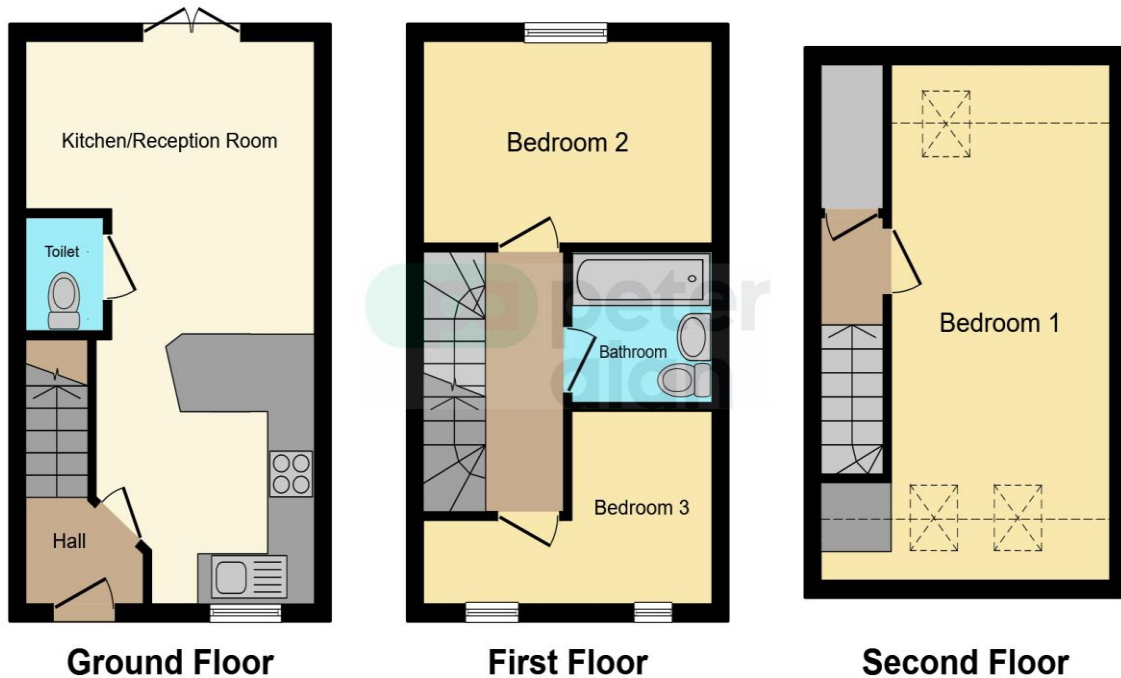

This floor plan is for illustrative purposes only. It is not drawn to scale. Any measurements, floor areas (including any total floor area), openings and orientation are approximate. No details are guaranteed, they cannot be relied upon for any purpose and they do not form part of any agreement. No liability is taken for any error, omission or misstatement. A party must rely upon its own inspection(s). Powered by www.focalagent.com

Important Information

Note while we endeavour to make our sales details accurate and reliable, if there is any point which is of particular interest to you, please contact the office and we will be pleased to confirm the position for you. We have not personally tested any apparatus, equipment, fixtures, fittings or services and cannot verify they are in working order or fit for their purposes. Nothing in these particulars is intended to indicate that carpets or curtains, furnishings or fittings, electrical goods (whether wired or not). Gas fires or light fittings or any other fixtures not expressly included form part of the property offered for sale. This computer generated Floorplan, if applicable, is intended as a general guide to the layout and design of the property. It is not to scale and should not be relied upon for dimensions. Tenure: We cannot confirm the tenure of the property as we have not had access to the legal documents. The buyer is advised to obtain verification from their solicitor or surveyor.

Peter Alan Limited is registered in England and Wales under company number 2073153, Registered Office is Cumbria House, 16-20 Hockliffe Street, Leighton Buzzard, Bedfordshire, LU7 1GN. VAT Registration Number is 500 2481 05. For activities relating to regulated mortgages and non-investment insurance contracts, Peter Alan Limited is an appointed representative of Connells Limited which is authorised and regulated by the Financial Conduct Authority. Connells Limited's Financial Services Register number is 302221. Most buy-to-let

pa peter
alan