



Flat 8 Park Street, £140,000

- 2 Bedroom Ground Floor Apartment
- Allocated Parking Space
- Master with Ensuite
- Council Tax Band - D
- Walking distance to Town Centre
- EPC Rating: C



01656 657201
bridgend@peteralan.co.uk



About the property

This 2-bedroom flat, currently listed for sale, offers a unique blend of comfort, convenience and modern living in a sought-after location. The property is neutrally decorated, providing a blank canvas for you to personalise and create your ideal living space.

The accommodation comprises of a spacious, open-plan living room that seamlessly merges with the kitchen and diner, offering the perfect setting for entertaining or relaxing. The kitchen comes fully fitted with modern conveniences, making meal preparation a breeze. The reception room is a welcoming space that's perfect for unwinding after a long day.

The property offers two well-proportioned bedrooms. The master bedroom is a delightful retreat with built-in wardrobes, providing ample storage space. The second bedroom is equally spacious and can comfortably accommodate a double bed. The property also benefits from two bathrooms, one of which is an en-suite to the master bedroom, ensuring privacy and convenience.

The flat is situated in a location that offers easy access to public transport links, local amenities and nearby parks. The area is also popular for its clean and tidy communal areas, and the flat comes with an allocated



Accommodation

Entrance Hall

Lounge/Diner

Kitchen

Bedroom One

Ensuite

Bedroom Two

Bathroom

01656 657201

bridgend@peteralan.co.uk

Floorplan

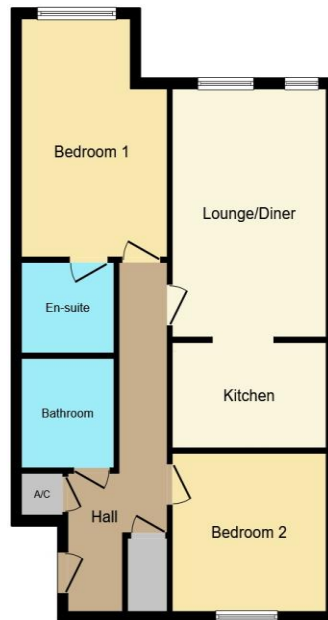

Floor Plan

Floor area 67.8 sq.m. (729 sq.ft.)

TOTAL: 67.8 sq.m. (729 sq.ft.)

This floor plan is for illustrative purposes only. It is not drawn to scale. Any measurements, floor areas (including any total floor area), openings and orientations are approximate. No details are guaranteed, they cannot be relied upon for any purpose and do not form any part of any agreement. No liability is taken for any error, omission or misstatement. A party must rely upon its own inspection(s). Powered by www.Propertybox.io



Important Information

Note while we endeavour to make our sales details accurate and reliable, if there is any point which is of particular interest to you, please contact the office and we will be pleased to confirm the position for you. We have not personally tested any apparatus, equipment, fixtures, fittings or services and cannot verify they are in working order or fit for their purposes. Nothing in these particulars is intended to indicate that carpets or curtains, furnishings or fittings, electrical goods (whether wired or not). Gas fires or light fittings or any other fixtures not expressly included form part of the property offered for sale. This computer generated Floorplan, if applicable, is intended as a general guide to the layout and design of the property. It is not to scale and should not be relied upon for dimensions. Tenure: We cannot confirm the tenure of the property as we have not had access to the legal documents. The buyer is advised to obtain verification from their solicitor or surveyor.

Peter Alan Limited is registered in England and Wales under company number 2073153, Registered Office is Cumbria House, 16-20 Hockliffe Street, Leighton Buzzard, Bedfordshire, LU7 1GN. VAT Registration Number is 500 2481 05. For activities relating to regulated mortgages and non-investment insurance contracts, Peter Alan Limited is an appointed representative of Connells Limited which is authorised and regulated by the Financial Conduct Authority. Connells Limited's Financial Services Register number is 302221. Most buy-to-let

