



## Trem Gwlad Yr Haf, £285,000

- Four Bedrooms
- Garage
- Semi-Detached
- Ensuite to Master
- Sought After Location
- EPC Rating: B



 4  2  1





## About the property

Located in the sought after estate of Parc Dderwen, is this four bedroom semi-detached property benefitting from off street parking and a garage!!! This property is within a short drive from all local amenities as well as the McArthur Glen Outlet, Bridgend Town Centre, Coity Castle and the M4 Corridor!!! Internally the property comprises entrance hall, kitchen, lounge and downstairs wc. To the first floor are three bedrooms and a family bathroom. To the second floor is master bedroom with ensuite. To the rear of the property is a lovely sized laid to lawn garden with side/back access to parking and garage. Viewings are highly recommended for this property. To book call 01656657201 or book via our website [www.peteralan.co.uk](http://www.peteralan.co.uk).





## Accommodation

### Entrance Hall

Enter via uPVC door. Access to kitchen, lounge and wc. Tiled flooring. Storage cupboard. Stairs to first floor.

### Kitchen

9' 4" x 14' 2" ( 2.84m x 4.32m )

Fitted with matching wall and base units with worktop space over. Insert 1 1/2 stainless steel sink with mixer tap. Space for appliances. Integrated oven/hob. Tiled floor and backsplash. uPVC double glazed bay window.

### Lounge

16' 2" x 11' 7" ( 4.93m x 3.53m )

Laminate flooring. uPVC double glazed windows and doors to garden.

### Downstairs Cloakroom

Fitted with two piece suite comprising wash hand basin and wc. Tiled floor. uPVC double glazed window.

### Landing

Access to three bedrooms and family bathroom. Fitted carpet. Storage cupboard.

### Bedroom Two

9' 3" x 12' 1" ( 2.82m x 3.68m )

Fitted carpet, uPVC double glazed window.

### Bedroom Three

9' 8" x 14' ( 2.95m x 4.27m )

Laminate flooring. uPVC double glazed window.

### Bedroom Four

6' 8" x 6' 5" ( 2.03m x 1.96m )

Laminate flooring. uPVC double glazed window.

### Bathroom

Fitted with three piece suite comprising bath with shower over, wash hand basin and wc. Tiles. uPVC double glazed window.

### Landing

Access to master bedroom with ensuite. Fitted carpet.

### Master Bedroom

22' 1" x 10' ( 6.73m x 3.05m )

Laminate flooring. uPVC double glazed windows. Built in wardrobes. Access to ensuite.

### Ensuite

Fitted with three piece suite comprising shower, wash hand basin and wc. Tiles, uPVC double glazed window.

### Rear Garden

Patio area and the rest laid to lawn. Side/back access.

01656 657201

bridgend@peteralan.co.uk

## Floorplan

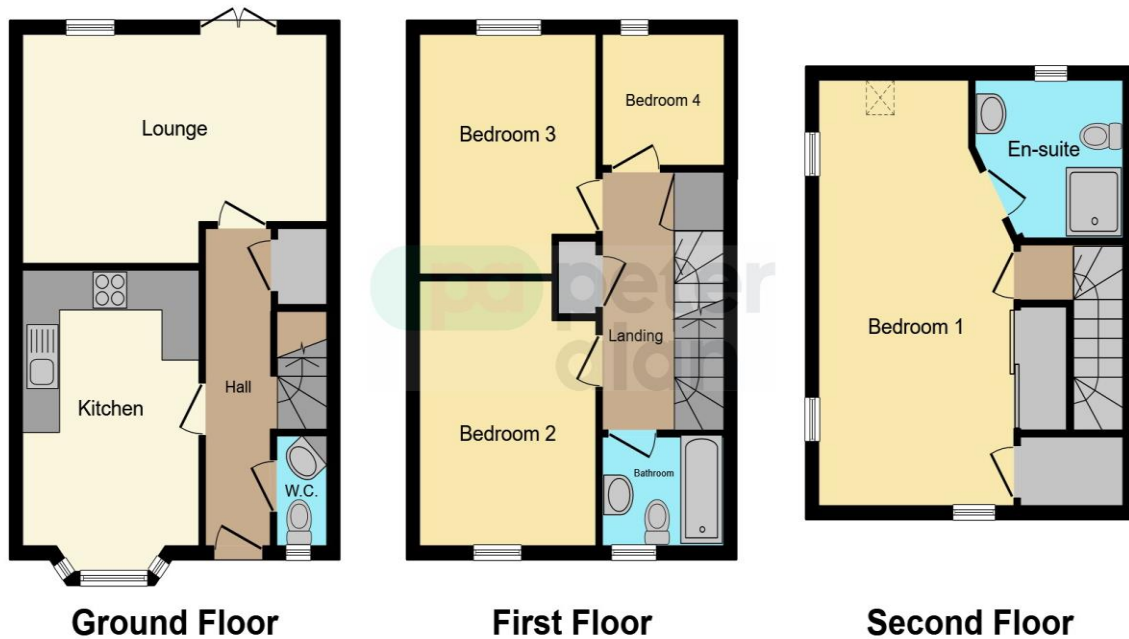

This floorplan is for illustrative purposes only and is not drawn to scale. Measurements, floor-areas, openings and orientations are approximate. They should not be relied upon for any purpose and do not form any part of an agreement. No liability is taken for any error or mis-statement. All parties must rely on their own inspections.

## Important Information

Note while we endeavour to make our sales details accurate and reliable, if there is any point which is of particular interest to you, please contact the office and we will be pleased to confirm the position for you. We have not personally tested any apparatus, equipment, fixtures, fittings or services and cannot verify they are in working order or fit for their purposes. Nothing in these particulars is intended to indicate that carpets or curtains, furnishings or fittings, electrical goods (whether wired or not). Gas fires or light fittings or any other fixtures not expressly included form part of the property offered for sale. This computer generated Floorplan, if applicable, is intended as a general guide to the layout and design of the property. It is not to scale and should not be relied upon for dimensions. Tenure: We cannot confirm the tenure of the property as we have not had access to the legal documents. The buyer is advised to obtain verification from their solicitor or surveyor.

Peter Alan Limited is registered in England and Wales under company number 2073153, Registered Office is Cumbria House, 16-20 Hockliffe Street, Leighton Buzzard, Bedfordshire, LU7 1GN. VAT Registration Number is 500 2481 05. For activities relating to regulated mortgages and non-investment insurance contracts, Peter Alan Limited is an appointed representative of Connells Limited which is authorised and regulated by the Financial Conduct Authority. Connells Limited's Financial Services Register number is 302221. Most buy-to-let