



Llewellyn Street, offers over £93,000

- NO CHAIN
- Three Bedrooms
- Project Property
- Rural Location
- Three Storey
- EPC Rating: C



 3  2  2



About the property

Located in the sought after village of Nantymoel is this three bedroom mid-terrace property being sold with NO ONGOING CHAIN! Perfect project property for anyone looking for their first starter home or next investment!!!

Accommodation

Entrance Hall

Enter via wooden door. Access to lounge and stairs to second floor,

Lounge

11' 8" x 11' (3.56m x 3.35m)

Laminate flooring. uPVC window.

Bedroom Three

11' 6" x 10' 2" (3.51m x 3.10m)

Fitted carpet,



Wc

Fitted with two piece suite comprising wash hand basin and wc. uPVC window.

Kitchen/dining Area

14' 4" x 19' 9" (4.37m x 6.02m)

Fitted with matching wall and base units with worktop space over. Insert stainless steel sink with mixer tap. Space for all appliances. uPVC window and door. Storage cupboard.

Landing

Access to bedrooms and bathroom.

Master Bedroom

15' 5" x 9' 8" (4.70m x 2.95m)

Fitted carpet. uPVC window.

Bedroom Three

9' 2" x 11' 6" (2.79m x 3.51m)

Fitted carpet. uPVC window.

Bathroom

Fitted with three piece suite comprising bath with shower over, wash hand basin and wc.

Floorplan

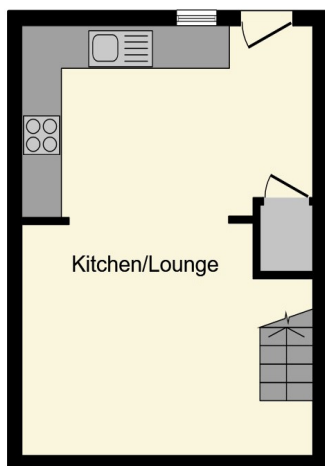

Lower Ground Floor

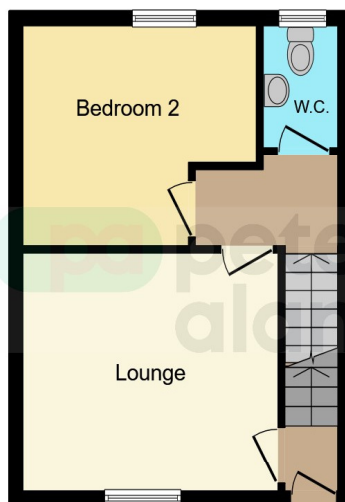

Ground Floor

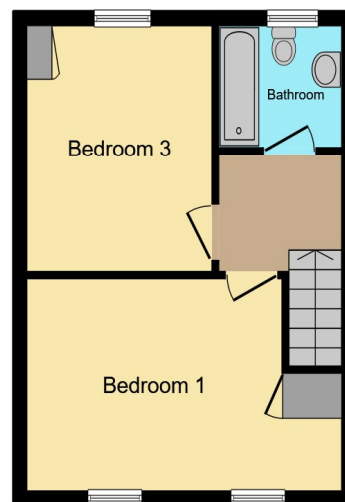

First Floor

This floorplan is for illustrative purposes only and is not drawn to scale. Measurements, floor-areas, openings and orientations are approximate. They should not be relied upon for any purpose and do not form any part of an agreement. No liability is taken for any error or mis-statement. All parties must rely on their own inspections.

Important Information

Note while we endeavour to make our sales details accurate and reliable, if there is any point which is of particular interest to you, please contact the office and we will be pleased to confirm the position for you. We have not personally tested any apparatus, equipment, fixtures, fittings or services and cannot verify they are in working order or fit for their purposes. Nothing in these particulars is intended to indicate that carpets or curtains, furnishings or fittings, electrical goods (whether wired or not), Gas fires or light fittings or any other fixtures not expressly included form part of the property offered for sale. This computer generated Floorplan, if applicable, is intended as a general guide to the layout and design of the property. It is not to scale and should not be relied upon for dimensions. Tenure: We cannot confirm the tenure of the property as we have not had access to the legal documents. The buyer is advised to obtain verification from their solicitor or surveyor.

Peter Alan Limited is registered in England and Wales under company number 2073153, Registered Office is Cumbria House, 16-20 Hockliffe Street, Leighton Buzzard, Bedfordshire, LU7 1GN. VAT Registration Number is 500 2481 05. For activities relating to regulated mortgages and non-investment insurance contracts, Peter Alan Limited is an appointed representative of Connells Limited which is authorised and regulated by the Financial Conduct Authority. Connells Limited's Financial Services Register number is 302221. Most buy-to-let