



Overdene, offers in excess of £190,000

- Perfect for families and first-time buyers
- Driveway available to rear garden.
- Nearby schools and amenities
- Modern, efficient kitchen
- Three generous bedrooms
- Immaculate semi-detached house
- Prime sought-after location
- EPC Rating: C



 3
  1
  1



About the property

We are delighted to bring to the market this immaculate semi-detached house for sale, perfect for families and first-time buyers alike. Boasting a prime location in a much sought-after area, the property offers ample accessibility to public transport links, local amenities, and several nearby schools.

This beautiful house presents an abundance of salient features that elegantly enhance the living experience. It encompasses a delightful reception room where you can host and entertain, and a well-equipped, highly efficient kitchen that positively encourages culinary exploration.

Upstairs, you'll find three generously-proportioned bedrooms offering plenty of space for rest and relaxation. Further complementing the interior is a well-appointed bathroom, ensuring everyone's needs are well catered for.

Externally, the property is just as striking. It boasts a private garden offering a tranquil spot for outdoor enjoyment throughout the seasons. In addition, the accommodation benefits from parking facilities, making it even more convenient for the residents.



Accommodation

Entrance Hallway

Lounge / Dining Room

19' 6" x 11' 4" Max (5.94m x 3.45m Max)

Kitchen

19' 6" x 11' 1" Max (5.94m x 3.38m Max)

Bedroom One

8' 8" Max x 13' 4" Max (2.64m Max x 4.06m Max)

Bedroom Two

10' 4" x 11' 4" Max (3.15m x 3.45m Max)

Bedroom Three

10' 8" x 6' 2" (3.25m x 1.88m)

Outside

01495 231199

blackwood@peteralan.co.uk

Floorplan

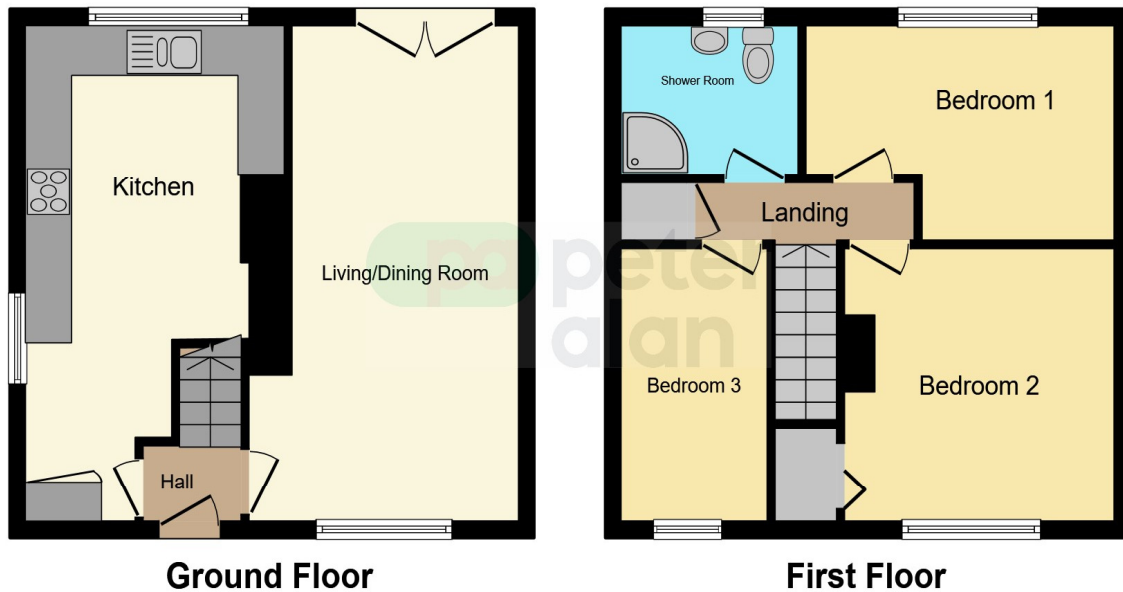

This floor plan is for illustrative purposes only. It is not drawn to scale. Any measurements, floor areas (including any total floor area), openings and orientation are approximate. No details are guaranteed, they cannot be relied upon for any purpose and they do not form part of any agreement. No liability is taken for any error, omission or misstatement. A party must rely upon its own inspection(s). Powered by www.focalagent.com



Important Information

Note while we endeavour to make our sales details accurate and reliable, if there is any point which is of particular interest to you, please contact the office and we will be pleased to confirm the position for you. We have not personally tested any apparatus, equipment, fixtures, fittings or services and cannot verify they are in working order or fit for their purposes. Nothing in these particulars is intended to indicate that carpets or curtains, furnishings or fittings, electrical goods (whether wired or not). Gas fires or light fittings or any other fixtures not expressly included form part of the property offered for sale. This computer generated Floorplan, if applicable, is intended as a general guide to the layout and design of the property. It is not to scale and should not be relied upon for dimensions. Tenure: We cannot confirm the tenure of the property as we have not had access to the legal documents. The buyer is advised to obtain verification from their solicitor or surveyor.

Peter Alan Limited is registered in England and Wales under company number 2073153, Registered Office is Cumbria House, 16-20 Hockliffe Street, Leighton Buzzard, Bedfordshire, LU7 1GN. VAT Registration Number is 500 2481 05. For activities relating to regulated mortgages and non-investment insurance contracts, Peter Alan Limited is an appointed representative of Connells Limited which is authorised and regulated by the Financial Conduct Authority. Connells Limited's Financial Services Register number is 302221. Most buy-to-let