



Greenfield Terrace, £275,000

- council tax band E
- Well Presented
- Detached annex in the grounds
- En-suite bathroom to master
- Great location
- EPC Rating: D



 3  1  2



About the property

Situated with a picturesque setting just a few miles north of Blackwood, this 4 bedroom bungalow has been immaculately restored to benefit from a conservatory, en-suite bathroom, and mature garden backing onto fields. Suited for buyers looking for style and perfection, call us today to view!





Accommodation

Hallway

Laminated wood flooring, radiator, door leading into the living room, doors leading to other rooms.

Living Room

20' 8" x 11' 7" (6.30m x 3.53m)

Laminated wood flooring, two central heating radiators, feature electric fire place with surround, double glazed patio door to the front with window surround

Kitchen/Family Sitting Room

16' 5" x 11' 5" (5.00m x 3.48m)

Ceramic tiled flooring, radiator, two double glazed windows to the rear, obscured double glazed barn door to the rear, range of wall and base units with hardwood worktop over, inset Belfast sink with mixer tap, Range cooker with cooker hood, spot lights, space for washing machine.

Family Sitting Room

Ceramic tiled flooring, radiator, double glazed bay window to the front, spot lights, door leading into the conservatory.

Conservatory

11' 7" x 11' 1" (3.53m x 3.38m)

Ceramic tiled flooring, central heating radiator, surrounding double glazed windows, double glazed patio doors to the rear accessing the garden.

Bathroom

Tiled flooring, radiator, window to the rear, wash hand basin with vanity unit, wc with vanity unit, P-shaped bath with over head shower and shower screen, spot lights, chrome towel radiator.

Bedroom One

11' 5" x 9' 11" (3.48m x 3.02m)

Laminated wood flooring, radiator, built in wardrobes, double glazed window to the rear, door accessing the en-suite.

En-Suite

Tiled flooring, radiator, obscured double glazed window to the rear, wash hand basin with vanity unit, wc with vanity unit, bath w, partial splash back tiling, extractor fan, spot lights.

Bedroom Two

01495 231199

blackwood@peteralan.co.uk

Floorplan

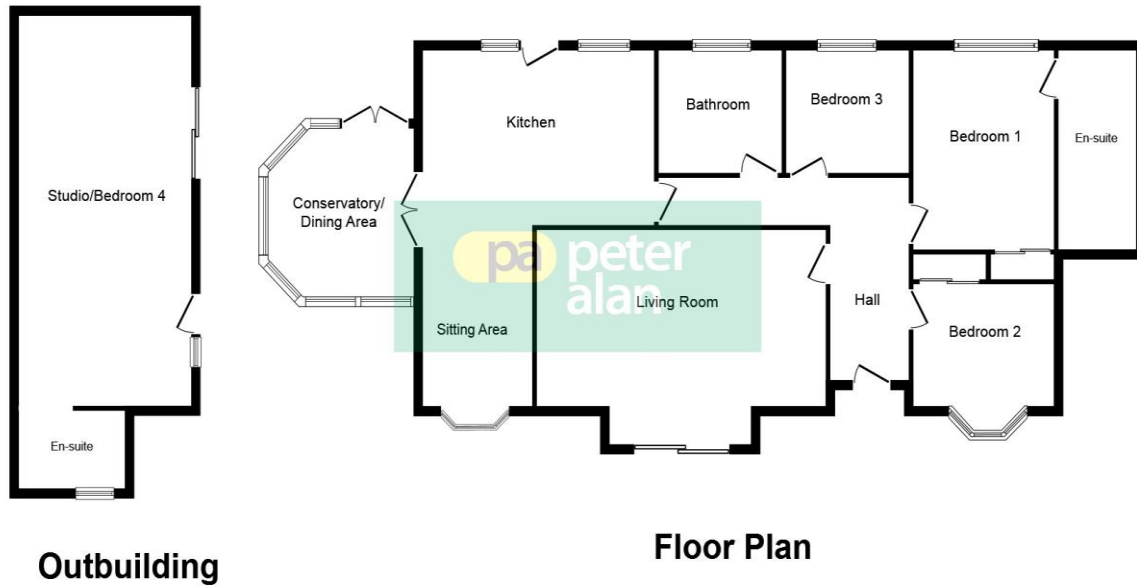

This plan is for illustration purposes only and may not be representative of the property. Plan not to scale.

Powered by audioagent.com

Important Information

Note while we endeavour to make our sales details accurate and reliable, if there is any point which is of particular interest to you, please contact the office and we will be pleased to confirm the position for you. We have not personally tested any apparatus, equipment, fixtures, fittings or services and cannot verify they are in working order or fit for their purposes. Nothing in these particulars is intended to indicate that carpets or curtains, furnishings or fittings, electrical goods (whether wired or not). Gas fires or light fittings or any other fixtures not expressly included form part of the property offered for sale. This computer generated Floorplan, if applicable, is intended as a general guide to the layout and design of the property. It is not to scale and should not be relied upon for dimensions. Tenure: We cannot confirm the tenure of the property as we have not had access to the legal documents. The buyer is advised to obtain verification from their solicitor or surveyor.

Peter Alan Limited is registered in England and Wales under company number 2073153, Registered Office is Cumbria House, 16-20 Hockliffe Street, Leighton Buzzard, Bedfordshire, LU7 1GN. VAT Registration Number is 500 2481 05. For activities relating to regulated mortgages and non-investment insurance contracts, Peter Alan Limited is an appointed representative of Connells Limited which is authorised and regulated by the Financial Conduct Authority. Connells Limited's Financial Services Register number is 302221. Most buy-to-let