



Y Rhodfa, ##Invalid offers in excess of £300,000

- COUNCIL TAX BAND E
- WATER FRONT
- PARKING TO FRONT
- LANDSCAPED, LOW MAINTENANCE GARDEN
- FAMILY BATHROOM, ENSUITE & CLOAKROOM
- EPC Rating: B



 3
  1
  1



About the property

WATER FRONT - 3 BEDROOMS - SPACE FOR HOME OFFICE. Comprising of hallway, kitchen, study, cloakroom, first floor landing, bedroom one with ensuite, living room, second floor landing, bedroom two and three, family bathroom, a landscaped low maintenance rear garden and allocated parking to the front.

Accommodation

Entrance Hall

Wood effect laminate, radiator, stairs to first floor, doors to kitchen, study and cloakroom.

Study

9' 8" x 8' 8" (2.95m x 2.64m)

Window to front with fitted shutters, carpet, radiator.

Kitchen

12' 9" x 12' 8" (3.89m x 3.86m)

Window to rear, doors to rear garden, wall and base units, oven and hob, sink and drainer, space for fridge freezer, washing machine and dishwasher, radiator, tiled floor, space for dining table, storage cupboard.

Cloakroom

Wood effect laminate, wc, sink, radiator.



First Floor Landing

Carpet, door to living room and bedroom one.

Living Room

12' 9" x 9' 1" (3.89m x 2.77m)

Window to front with fitted shutters, carpet, radiator.

Bedroom One

12' 9" x 9' 5" (3.89m x 2.87m)

Two windows to rear, carpet, radiator, door to ensuite.

Ensuite

Shower cubicle, wc, sink, radiator, vinyl floor.

Second Floor Landing

Carpet, doors to bedroom one and two and family bathroom

Bedroom Two

10' 2" x 12' 8" (3.10m x 3.86m)

Two windows to front, radiator, carpet.

01446 733224

barry@peteralan.co.uk

Floorplan

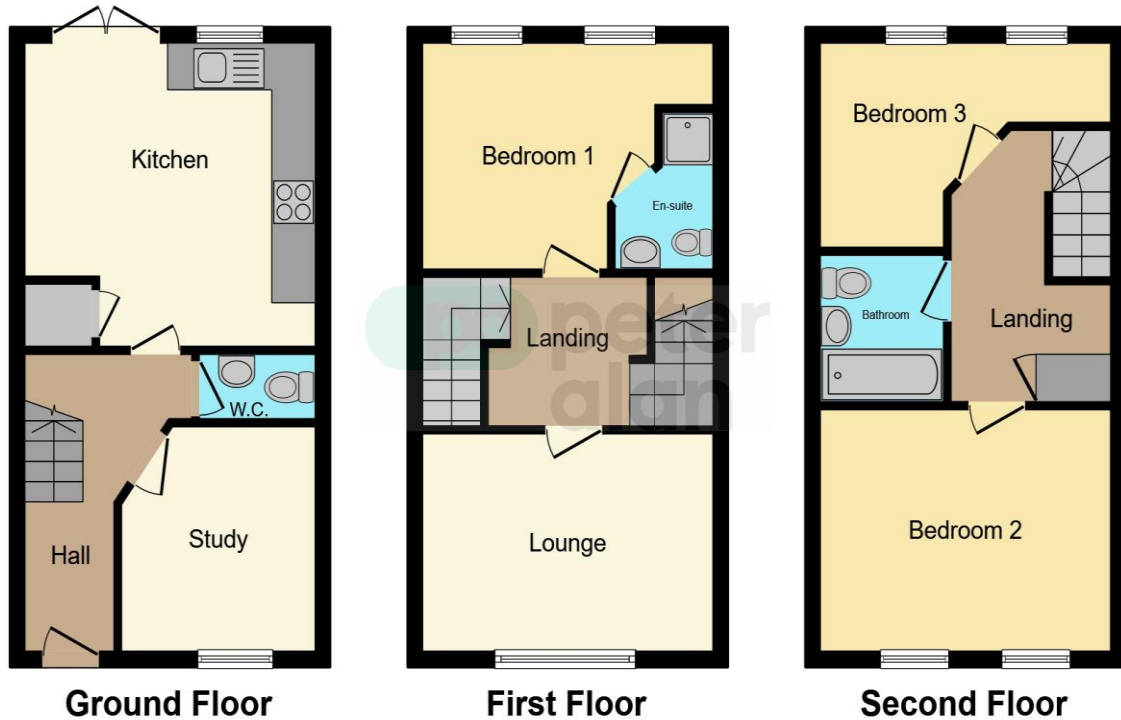

This floor plan is for illustrative purposes only. It is not drawn to scale. Any measurements, floor areas (including any total floor area), openings and orientation are approximate. No details are guaranteed, they cannot be relied upon for any purpose and they do not form part of any agreement. No liability is taken for any error, omission or misstatement. A party must rely upon its own inspection(s). Powered by www.focalagent.com

Important Information

Note while we endeavour to make our sales details accurate and reliable, if there is any point which is of particular interest to you, please contact the office and we will be pleased to confirm the position for you. We have not personally tested any apparatus, equipment, fixtures, fittings or services and cannot verify they are in working order or fit for their purposes. Nothing in these particulars is intended to indicate that carpets or curtains, furnishings or fittings, electrical goods (whether wired or not). Gas fires or light fittings or any other fixtures not expressly included form part of the property offered for sale. This computer generated Floorplan, if applicable, is intended as a general guide to the layout and design of the property. It is not to scale and should not be relied upon for dimensions. Tenure: We cannot confirm the tenure of the property as we have not had access to the legal documents. The buyer is advised to obtain verification from their solicitor or surveyor.

Peter Alan Limited is registered in England and Wales under company number 2073153, Registered Office is Cumbria House, 16-20 Hockliffe Street, Leighton Buzzard, Bedfordshire, LU7 1GN. VAT Registration Number is 500 2481 05. For activities relating to regulated mortgages and non-investment insurance contracts, Peter Alan Limited is an appointed representative of Connells Limited which is authorised and regulated by the Financial Conduct Authority. Connells Limited's Financial Services Register number is 302221. Most buy-to-let