



Greenmeadow Way, offers over £485,000

- FOUR BEDROOM 'HEYDON' STYLE DETACHED HOME
- FAMILY BATHROOM, TWO EN SUITES AND CLOAKROOM
- DETACHED DOUBLE GARAGE
- LANDSCAPED GARDEN WITH OUTSIDE BAR, PIZZA OVER AND PERGOLA
- OPEN PLAN KITCHEN/DINER
- SEA VIEWS



 4  2  2



About the property

FOUR BEDROOM DETACHED - LANDSCAPED GARDEN WITH PIZZA OVEN, BAR & PERGOLA - SEA VIEWS - DOUBLE GARAGE AND DRIVEWAY Excellent access for all commuters and in walking distance of the village facilities include shops, schools, train links, beaches and superb coastal walks *Call 01446 733224*

Accommodation

Entrance Hall

Tiled floor, radiator, under stairs storage, stairs to first floor and doors to cloakroom, living room and kitchen/diner.

Cloakroom

Continuation of tiled floor, wc, wash hand basin, radiator.

Study

7' 8" x 9' (2.34m x 2.74m)

Window to front, wood effect laminate, radiator.

Lounge

22' 9" Max x 12' 9" (6.93m Max x 3.89m)

Bay window to front and side, doors to garden, wood effect flooring, media wall with feature fireplace. radiator.

Kitchen/Diner

21' 9" x 11' 3" (6.63m x 3.43m)



Window to rear and doors to garden, wall and base unite, double oven, hob and extractor, integrated fridge freezer and dishwasher. Sink and drainer, tiled floor, radiator.

Utility Room

5' 9" x 5' 6" (1.75m x 1.68m)

Door to garden, sin and drainer, space and plumbing for washing aching and tumble drier.

Bedroom 1

12' 4" x 11' 5" (3.76m x 3.48m)

Window to rear, carpet, radiator, two built in wardrobes, door to en suite

Ensuite

Window to rear, bath, shower cubicle, wash hand basin, wc, tiled floor and part tiled walls

Bedroom 2

11' 3" x 10' (3.43m x 3.05m)

Window to rear, wood effect laminate, radiator, built in wardrobe, door to en suite



Ensuite

Window to rear, wc, wash hand basin, shower, radiator, wood effect laminate, part tiled walls.

01446 733224

barry@peteralan.co.uk

Floorplan

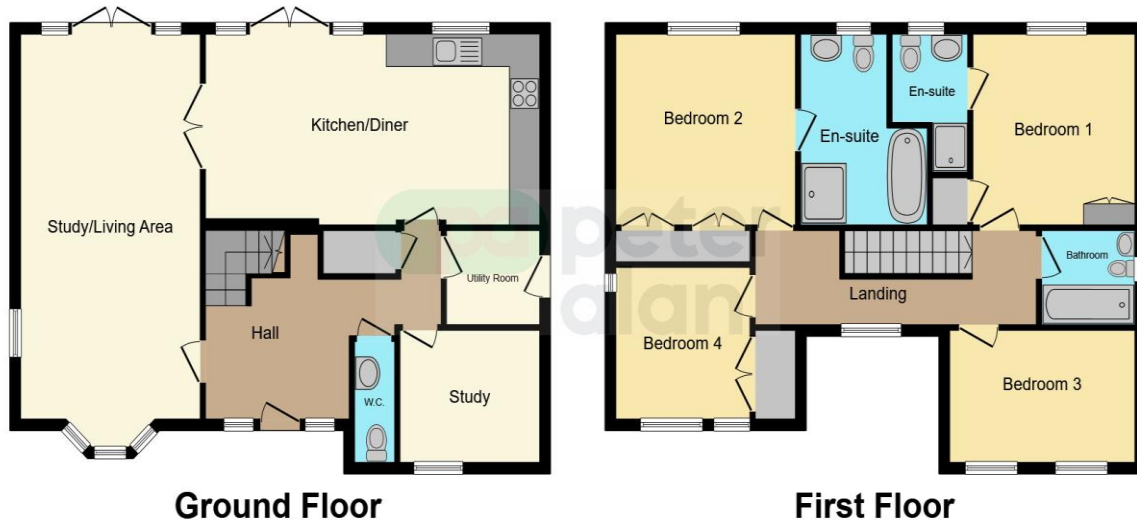

This floor plan is for illustrative purposes only. It is not drawn to scale. Any measurements, floor areas (including any total floor area), openings and orientation are approximate. No details are guaranteed, they cannot be relied upon for any purpose and they do not form part of any agreement. No liability is taken for any error, omission or misstatement. A party must rely upon its own inspection(s). Powered by www.focalagent.com

Important Information

Note while we endeavour to make our sales details accurate and reliable, if there is any point which is of particular interest to you, please contact the office and we will be pleased to confirm the position for you. We have not personally tested any apparatus, equipment, fixtures, fittings or services and cannot verify they are in working order or fit for their purposes. Nothing in these particulars is intended to indicate that carpets or curtains, furnishings or fittings, electrical goods (whether wired or not). Gas fires or light fittings or any other fixtures not expressly included form part of the property offered for sale. This computer generated Floorplan, if applicable, is intended as a general guide to the layout and design of the property. It is not to scale and should not be relied upon for dimensions. Tenure: We cannot confirm the tenure of the property as we have not had access to the legal documents. The buyer is advised to obtain verification from their solicitor or surveyor.

Peter Alan Limited is registered in England and Wales under company number 2073153, Registered Office is Cumbria House, 16-20 Hockliffe Street, Leighton Buzzard, Bedfordshire, LU7 1GN. VAT Registration Number is 500 2481 05. For activities relating to regulated mortgages and non-investment insurance contracts, Peter Alan Limited is an appointed representative of Connells Limited which is authorised and regulated by the Financial Conduct Authority. Connells Limited's Financial Services Register number is 302221. Most buy-to-let