



## Ty Camlas Y Rhodfa, guide price £160,000

- DIRECT WATER VIEWS
- COUNCIL TAX D
- PRIVATE BALCONY
- 2 DOUBLE BEDROOMS
- EN SUITE & FAMILY BATHROOM
- SEPARATE KITCHEN/ DINER - LIVING ROOM
- EPC Rating: C



 2  2  1



## About the property

TOP FLOOR \*NEW BOILER\* - Briefly comprising of communal entrance, stairs ascending to upper floors, inner hallway, living room, private balcony, kitchen/ diner, 2 double bedrooms, en suite to master, family bathroom, 2 under-croft parking spaces.

## Accommodation

### Entrance

### Inner Hallway

Wall mounted telecom, fitted carpet, power points, radiator, fitted storage cupboard, fitting airing cupboard, glazed window to rear aspect.

### Living/ Dining Room

18' 3" x 13' 11" ( 5.56m x 4.24m )

T.V. point, power points, radiator, fitted carpet, glazed doors to Balcony with \*DIRECT WATER VIEWS\*

### Balcony

Plenty of space for table and chairs, DIRECT WATER VIEWS.

### Kitchen/ Breakfast Room

10' 1" x 8' 2" ( 3.07m x 2.49m )





Matching wall and base units with complimentary work tops, inset sink, drain and mixer tap, inset gas hob, oven and cooker hood, washing machine and fridge freezer to remain, power points, splash back tiled areas, cushioned vinyl flooring, glazed window to rear aspect.

### Bedroom One

13' 1" Max x 12' 4" Max ( 3.99m Max x 3.76m Max )

Fitted wardrobes to remain, fitted carpet, power points, radiator, glazed window to front aspect, door leading into En Suite;-

### En Suite

W.C., wash hand basin, shower cubicle, splash back tiled areas, shaving power points, radiator, glazed window to front aspect.

### Bedroom Two

9' 8" x 9' 5" ( 2.95m x 2.87m )

Fitted carpet, power points, radiator, glazed window to rear aspect.

### Family Bathroom

W.C., wash hand basin , bath, splash back tiled areas, shaving power points, radiator, glazed window to rear.

### Outside

### Parking

2 Undercroft parking spaces.

01446 733224

barry@peteralan.co.uk

## Floorplan

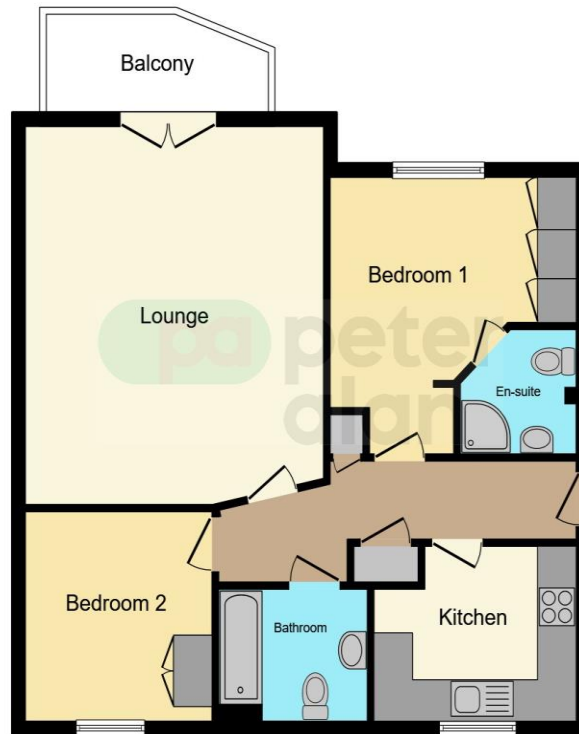

This floor plan is for illustrative purposes only. It is not drawn to scale. Any measurements, floor areas (including any total floor area), openings and orientation are approximate. No details are guaranteed, they cannot be relied upon for any purpose and they do not form part of any agreement. No liability is taken for any error, omission or misstatement. A party must rely upon its own inspection(s). Powered by [www.focalagent.com](http://www.focalagent.com)

## Important Information

Note while we endeavour to make our sales details accurate and reliable, if there is any point which is of particular interest to you, please contact the office and we will be pleased to confirm the position for you. We have not personally tested any apparatus, equipment, fixtures, fittings or services and cannot verify they are in working order or fit for their purposes. Nothing in these particulars is intended to indicate that carpets or curtains, furnishings or fittings, electrical goods (whether wired or not). Gas fires or light fittings or any other fixtures not expressly included form part of the property offered for sale. This computer generated Floorplan, if applicable, is intended as a general guide to the layout and design of the property. It is not to scale and should not be relied upon for dimensions. Tenure: We cannot confirm the tenure of the property as we have not had access to the legal documents. The buyer is advised to obtain verification from their solicitor or surveyor.

Peter Alan Limited is registered in England and Wales under company number 2073153, Registered Office is Cumbria House, 16-20 Hockliffe Street, Leighton Buzzard, Bedfordshire, LU7 1GN. VAT Registration Number is 500 2481 05. For activities relating to regulated mortgages and non-investment insurance contracts, Peter Alan Limited is an appointed representative of Connells Limited which is authorised and regulated by the Financial Conduct Authority. Connells Limited's Financial Services Register number is 302221. Most buy-to-let