



Afal Sur, offers in excess of £425,000

- CUL DE SAC LOCATION
- 3 DOUBLE BEDROOMS
- DETACHED
- GARAGE
- LANDSCAPED GARDENS
- EPC Rating: C



 3  2  2



About the property

A beautifully presented detached home with landscaped gardens and attractive views. Accommodation comprising of 3 double bedrooms. Living room open to dining room. Kitchen. Family bathroom. Study/dressing room. En suite to master bedroom. Garage. Cul de sac location. No chain.

Accommodation

Entrance Hall

Via front door to hallway with access to garage. Study and master bedroom.

Bedroom 1

13' 1" x 12' 6" (3.99m x 3.81m)

Window to front. Radiator. Carpet. Dressing area with range of wardrobes.

En suite - window to side. Tiled floor. Walk in shower, W.C pedestal wash hand basin inset to vanity unit.

Study 6' 3" x 6' (1.91m x 1.83m)

Versatile room for use as study, Dressing room. Cot room etc.

Garage

18' 2" x 10' 7" (5.54m x 3.23m)

Single garage with up and over doors.



Storage

Landing

Living Room

19' 6" max x 12' 6" (5.94m max x 3.81m)

Window to front. Radiator. Carpet. Gas fire inset to surround.

Dining Room

12' 1" max x 9' 4" (3.68m max x 2.84m)

Laminate flooring. Radiator. Doors leading to garden

Kitchen

15' 11" max x 10' max (4.85m max x 3.05m max)

Range of base and wall units with complimentary work surfaces over. Fitted oven, hob, extractor hood. Tiled flooring. Space for washing machine and fridge freezer. Door providing access to rear garden.

Bedroom 2

10' 4" x 11' 2" (3.15m x 3.40m)

Window to front. Radiator. Fitted carpet.

Bedroom 3

11' 7" x 10' 7" (3.53m x 3.23m)

Window to rear. Radiator. Fitted carpet.

Bathroom

Window to side. Tiled floor. Radiator. Panelled bath with shower over. W.C. Wash hand basin inset to vanity unit.

Outside

To the front - low maintenance front garden with driveway leading to garage.

To the rear - fence and hedge boundaries. Mature shrubs. Patio area. Additional areas with artificial grass laid.

01446 733224

barry@peteralan.co.uk

Floorplan

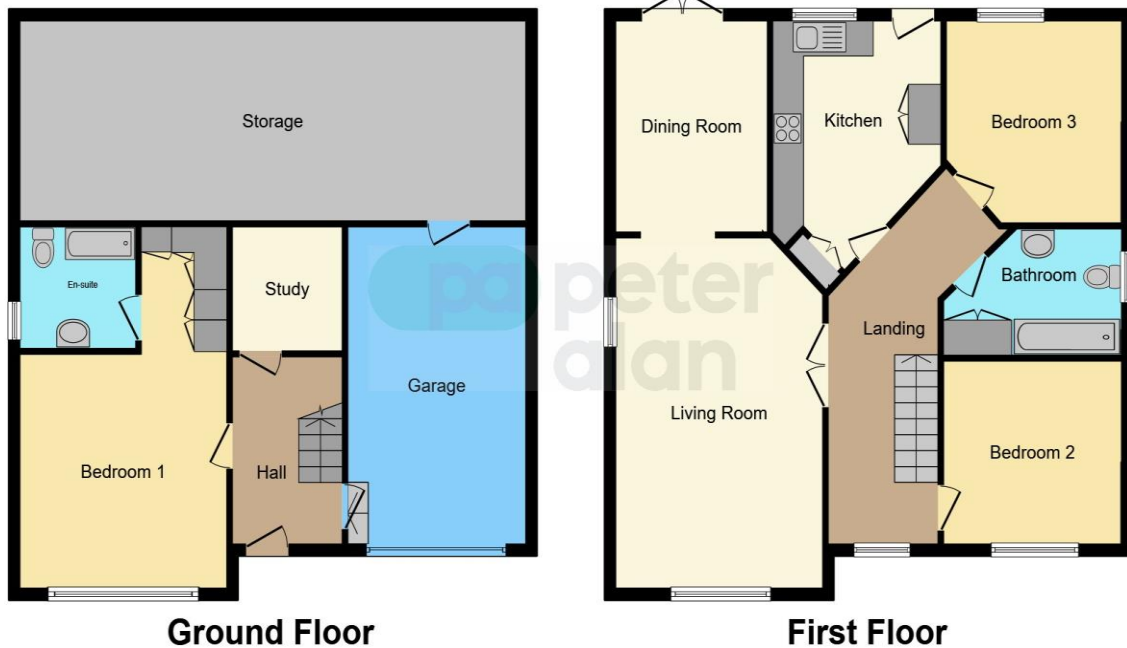

This floorplan is for illustrative purposes only and is not drawn to scale. Measurements, floor-areas, openings and orientations are approximate. They should not be relied upon for any purpose and do not form any part of an agreement. No liability is taken for any error or mis-statement. All parties must rely on their own inspections.

Important Information

Note while we endeavour to make our sales details accurate and reliable, if there is any point which is of particular interest to you, please contact the office and we will be pleased to confirm the position for you. We have not personally tested any apparatus, equipment, fixtures, fittings or services and cannot verify they are in working order or fit for their purposes. Nothing in these particulars is intended to indicate that carpets or curtains, furnishings or fittings, electrical goods (whether wired or not). Gas fires or light fittings or any other fixtures not expressly included form part of the property offered for sale. This computer generated Floorplan, if applicable, is intended as a general guide to the layout and design of the property. It is not to scale and should not be relied upon for dimensions. Tenure: We cannot confirm the tenure of the property as we have not had access to the legal documents. The buyer is advised to obtain verification from their solicitor or surveyor.

Peter Alan Limited is registered in England and Wales under company number 2073153, Registered Office is Cumbria House, 16-20 Hockliffe Street, Leighton Buzzard, Bedfordshire, LU7 1GN. VAT Registration Number is 500 2481 05. For activities relating to regulated mortgages and non-investment insurance contracts, Peter Alan Limited is an appointed representative of Connells Limited which is authorised and regulated by the Financial Conduct Authority. Connells Limited's Financial Services Register number is 302221. Most buy-to-let