



Aberdulais Road, offers over £250,000

- Council Tax Band D
- Very Large Rear Garden
- Off Road Parking for Three Cars
- Close to Heath Hospital
- Three Good Size Bedrooms
- EPC Rating: C



3 1 1



About the property

A huge private rear garden comes with this improved three bedroom family semi-detached home with plenty of off road parking situated close to the Heath Hospital, Cardiff city centre, M4 motorway, Llandaff North and Whitchurch village.

Accommodation

Entrance Porch

Lounge

10' 7" x 17' 8" (3.23m x 5.38m)

Kitchen / Diner

9' x 21' 2" (2.74m x 6.45m)

Laundry

4' 1" x 20' 10" (1.24m x 6.35m)

Landing



Wet Room

6' 1" x 9' 7" (1.85m x 2.92m)

Bedroom One

12' 2" x 10' to wardrobe door (3.71m x 3.05m to wardrobe door)

Bedroom Two

8' 10" x 10' 10" (2.69m x 3.30m)

Bedroom Three

9' 2" x 8' 4" max (2.79m x 2.54m max)

Outside / Large Rear Garden

Parking For Three Cars

Note

Please note that this property is of non standard construction.

02920 612328

whitchurch@peteralan.co.uk

Floorplan

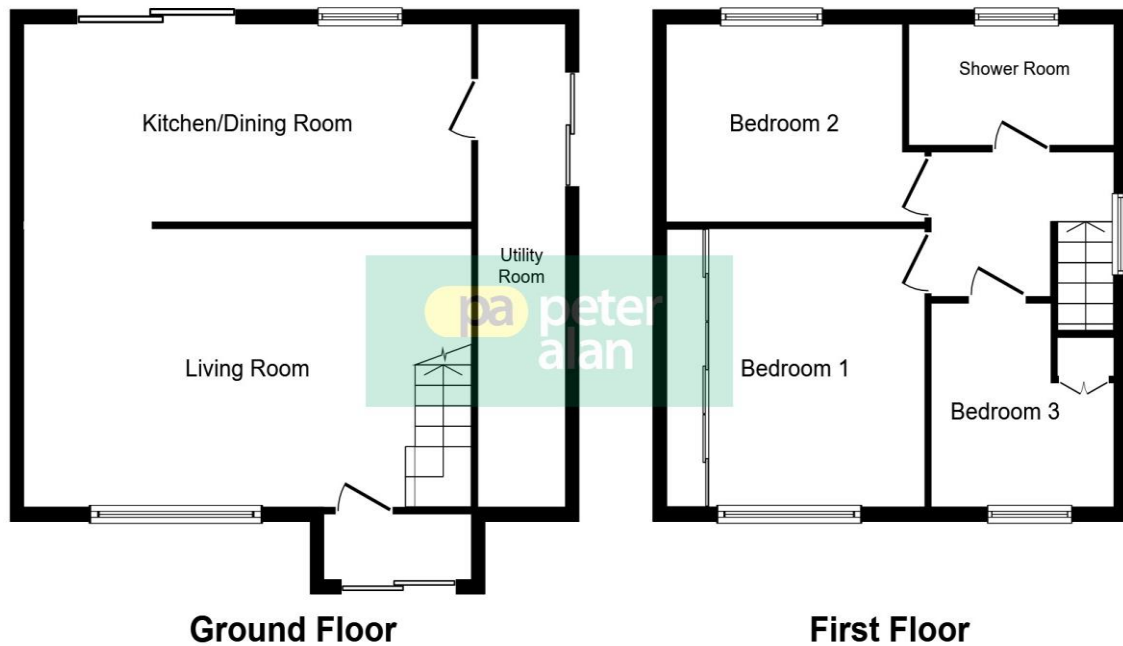

This plan is for illustration purposes only and may not be representative of the property. Plan not to scale.

Powered by audioagent.com

Important Information

Note while we endeavour to make our sales details accurate and reliable, if there is any point which is of particular interest to you, please contact the office and we will be pleased to confirm the position for you. We have not personally tested any apparatus, equipment, fixtures, fittings or services and cannot verify they are in working order or fit for their purposes. Nothing in these particulars is intended to indicate that carpets or curtains, furnishings or fittings, electrical goods (whether wired or not). Gas fires or light fittings or any other fixtures not expressly included form part of the property offered for sale. This computer generated Floorplan, if applicable, is intended as a general guide to the layout and design of the property. It is not to scale and should not be relied upon for dimensions. Tenure: We cannot confirm the tenure of the property as we have not had access to the legal documents. The buyer is advised to obtain verification from their solicitor or surveyor.

Peter Alan Limited is registered in England and Wales under company number 2073153, Registered Office is Cumbria House, 16-20 Hockliffe Street, Leighton Buzzard, Bedfordshire, LU7 1GN. VAT Registration Number is 500 2481 05. For activities relating to regulated mortgages and non-investment insurance contracts, Peter Alan Limited is an appointed representative of Connells Limited which is authorised and regulated by the Financial Conduct Authority. Connells Limited's Financial Services Register number is 302221. Most buy-to-let