



Pinecrest Drive, £315,000

- Council Tax Band - F
- No Chain
- En-suite Shower Room
- Utility Room
- Two reception rooms
- EPC Rating: C



 3  2  2



About the property

The property briefly comprises an entrance hall, lounge, separate dining room, modern fitted kitchen, utility room, master bedroom with en-suite, a further 2 bedrooms plus family bathroom. Further benefits include gas central heating, double glazing and generous off road parking..





Accommodation

Hallway

Entered via a white Upvc double glazed door. Wood flooring. Staircase to first floor. Access to lounge, kitchen & dining room.

Dining Room

14' 7" x 7' 6" (4.45m x 2.29m)

Laminate flooring. Textured ceiling. Upvc double glazed window to the front. Radiator. Power points.

Lounge

15' 4" x 12' 11" (4.67m x 3.94m)

Upvc double glazed window to the front. 2 Radiators. Power points.

Kitchen

12' 11" x 7' 1" (3.94m x 2.16m)

Vinyl flooring. A range of base and wall units incorporating marble rounded edge work surfaces. 'Stoves' stainless steel cooker with extractor fan over. A ½ stainless steel sink and drainer unit. Space for low level fridge. 2 Upvc double glazed window to rear. Tiled splashback areas.

Utility Room

7' 6" x 7' 6" (2.29m x 2.29m)

Vinyl flooring. Rounded edge marble work surface with space and plumbing for dishwasher, washing machine and tumble dryer. 'Baxi' condensing boiler. Power points.

First Floor Landing

Carpeted flooring. Loft access.

Master Bedroom

13' x 10' 9" (3.96m x 3.28m)

Carpeted flooring. Upvc double glazed window. Storage cupboard. Radiator. Power points.

En-Suite

A white suite comprises enclosed shower cubicle with electric shower, pedestal wash hand basin, closed coupled w c. Extractor fan. Vinyl flooring. Upvc double glazed window to front. Radiator.

Bedroom 2

15' 4" x 7' 6" (4.67m x 2.29m)

Carpeted flooring. Angled Upvc double glazed window to the rear. Radiator. Coving to ceiling. Power points.

Bedroom 3

11' 10" x 6' 10" (3.61m x 2.08m)

Carpeted flooring. Upvc double glazed window to the rear. Radiator. Power points.

Family Bathroom

A white suite comprises a panelled bath with shower over. Pedestal wash hand basin, close coupled wc.

Floorplan

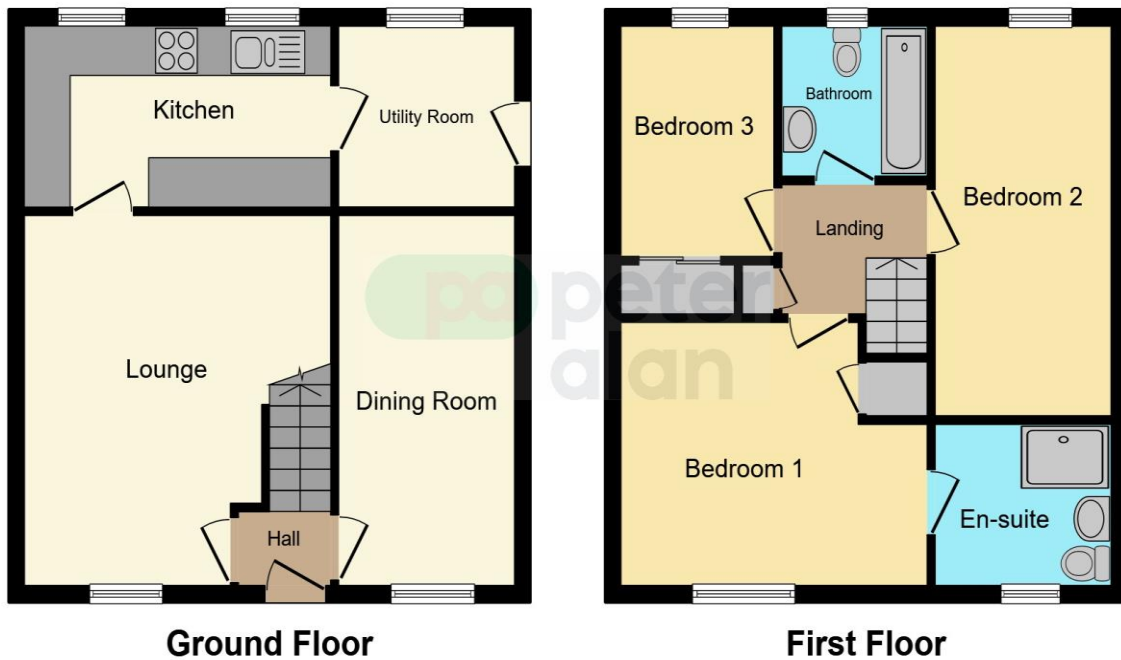

This floorplan is for illustrative purposes only and is not drawn to scale. Measurements, floor-areas, openings and orientations are approximate. They should not be relied upon for any purpose and do not form any part of an agreement. No liability is taken for any error or mis-statement. All parties must rely on their own inspections.

Important Information

Note while we endeavour to make our sales details accurate and reliable, if there is any point which is of particular interest to you, please contact the office and we will be pleased to confirm the position for you. We have not personally tested any apparatus, equipment, fixtures, fittings or services and cannot verify they are in working order or fit for their purposes. Nothing in these particulars is intended to indicate that carpets or curtains, furnishings or fittings, electrical goods (whether wired or not). Gas fires or light fittings or any other fixtures not expressly included form part of the property offered for sale. This computer generated Floorplan, if applicable, is intended as a general guide to the layout and design of the property. It is not to scale and should not be relied upon for dimensions. Tenure: We cannot confirm the tenure of the property as we have not had access to the legal documents. The buyer is advised to obtain verification from their solicitor or surveyor.

Peter Alan Limited is registered in England and Wales under company number 2073153, Registered Office is Cumbria House, 16-20 Hockliffe Street, Leighton Buzzard, Bedfordshire, LU7 1GN. VAT Registration Number is 500 2481 05. For activities relating to regulated mortgages and non-investment insurance contracts, Peter Alan Limited is an appointed representative of Connells Limited which is authorised and regulated by the Financial Conduct Authority. Connells Limited's Financial Services Register number is 302221. Most buy-to-let