



offers over
leasehold **£210,000**

Seager Drive, Cardiff CF11 7FE

- EPC Rating: C
- THREE BEDROOM
- FANTASTIC VIEWS
- PARKING
- EN-SUITE





About The Property

****THREE BEDROOM MAISONETTE IN WINDSOR QUAY boasting FANTASTIC VIEWS across THE BAY, allocated PARKING and a DRESSING ROOM and EN-SUITE off the main bedroom****

Accommodation

Hallway

Lounge/ Diner

19' 2" max x 19' 1" max (5.84m max x 5.82m max)

Kitchen

10' 11" max x 11' 5" max (3.33m max x 3.48m max)

Bedroom One

14' 7" max x 12' 1" max (4.45m max x 3.68m max)

Dressing Room

4' 3" x 6' 9" (1.30m x 2.06m)

En-Suite

Bedroom Two

10' 8" max x 12' 11" max (3.25m max x 3.94m max)

Bedroom Three

15' 8" x 7' 3" (4.78m x 2.21m)

Bathroom

Peter Alan - Canton

02920 397171
canton@peteralan.co.uk
peteralan.co.uk



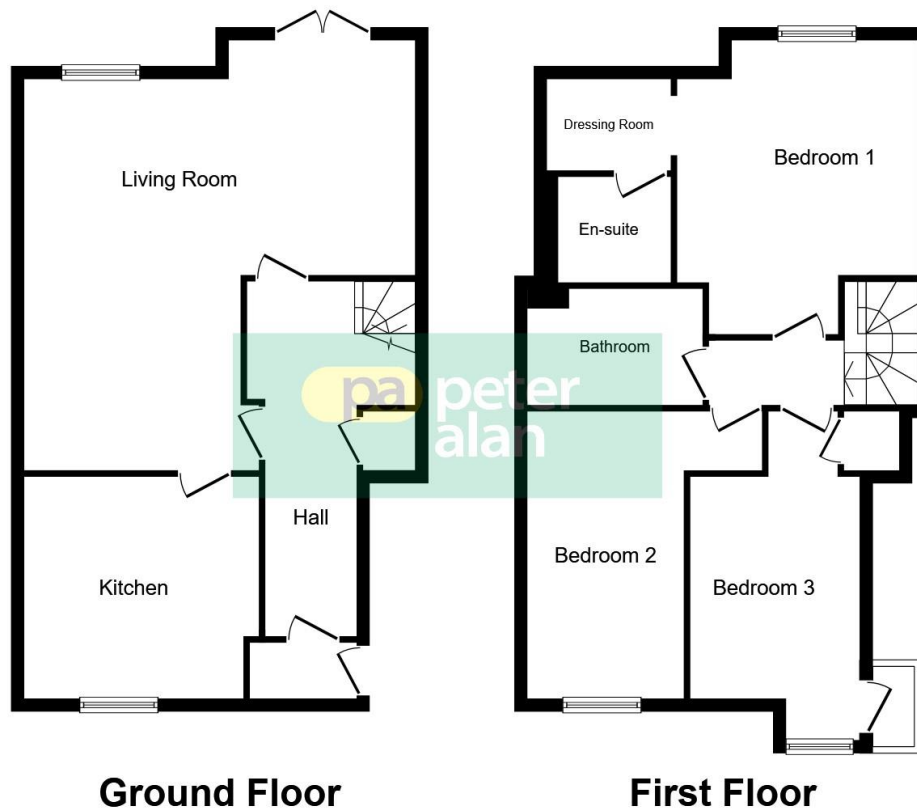

Ground Floor

First Floor

This floor plan is for illustrative purposes only. It is not drawn to scale. Any measurements, floor areas (including any total floor area), openings and orientation are approximate. No details are guaranteed, they cannot be relied upon for any purpose and they do not form part of any agreement. No liability is taken for any error, omission or misstatement. A party must rely upon its own inspection(s). Plan produced for Peter Alan. Powered by www.focalagent.com

Important Information

Note while we endeavour to make our sales details accurate and reliable, if there is any point which is of particular interest to you, please contact the office and we will be pleased to confirm the position for you. We have not personally tested any apparatus, equipment, fixtures, fittings or services and cannot verify they are in working order or fit for their purposes. Nothing in these particulars is intended to indicate that carpets or curtains, furnishings or fittings, electrical goods (whether wired or not). Gas fires or light fittings or any other fixtures not expressly included form part of the property offered for sale. This computer generated Floorplan, if applicable, is intended as a general guide to the layout and design of the property. It is not to scale and should not be relied upon for dimensions. Tenure: We cannot confirm the tenure of the property as we have not had access to the legal documents. The buyer is advised to obtain verification from their solicitor or surveyor.

Lease details are currently being compiled. For further information please contact the branch. Please note additional fees could be incurred for items such as leasehold packs.

