



Hastings Crescent, offers in the region of £410,000

- Large Family Home
- Chain Free
- Great Location
- Four Bedrooms
- Annexe
- Private Garden
- Off Road Parking
- Close to St Johns College
- EPC Rating: D



 4  2  2



About the property

This impressive four bedroom detached family home provides versatile living space, just a short walk from St Johns College, fronting a quiet road, well away from busy passing traffic, yet convenient for access to Old St Mellons Village

Accommodation

Entrance

Enter via the door to front into the hallway with stairs to first floor. Carpet.

Study

7' x 7' 4" (2.13m x 2.24m) Double glazed window to front. The study is fully fitted. Radiator, Carpet.

Cloak Room

Double glazed frosted window to side. Low level WC. Wash hand basin. Tiled floor. Radiator.

Lounge

16' 6" x 14' 1" (5.03m x 4.29m) Double glazed bay window to front and a double glazed window to side. Laminate floor. Doors to dining room. Radiator.

Dining Room

9' 7" x 9' 6" (2.92m x 2.90m)

Double glazed doors to rear. Radiator, Carpet.



Bedroom One

14' 2" x 9' 8" (4.32m x 2.95m) Double glazed window to front. Built in wardrobe. Radiator. Access to the en-suite.

En- Suite

Double glazed frosted window to front. Shower cubicle. Low level WC. Wash hand basin. Tiled splash backs.

Bedroom Two

11' 5" x 11' (3.48m x 3.35m) Double glazed window to rear. Carpet. Radiator.

Lounge/kitchen

13' 2" x 9' 4" (4.01m x 2.84m)

Double glazed doors to front into the entrance with small kitchen area and open plan lounge. Laminate floor. Door to bedroom.

ANNEXE

Bedroom

14' 6" x 9' 4" (4.42m x 2.84m)

Built in wardrobe. Carpet. Access to the shower room.

Kitchen

16' 5" x 9' 6" (5.00m x 2.90m) Two double glazed windows to rear. Wall and base units. Ceramic sink with mixer tap. Bosch dishwasher. Electric oven and gas hob with extract fan over. Tiled splashbacks. Space for a table and chairs. Tiled floor. Radiator. Access to the utility room.

Utility Room

7' 6" x 5' 7" (2.29m x 1.70m) Door to rear. Base units. Samsung washer/dryer. Tiled splashbacks. Space for a fridge freezer. Ceramic sink.

02920 792888

rumney@peteralan.co.uk

Floorplan

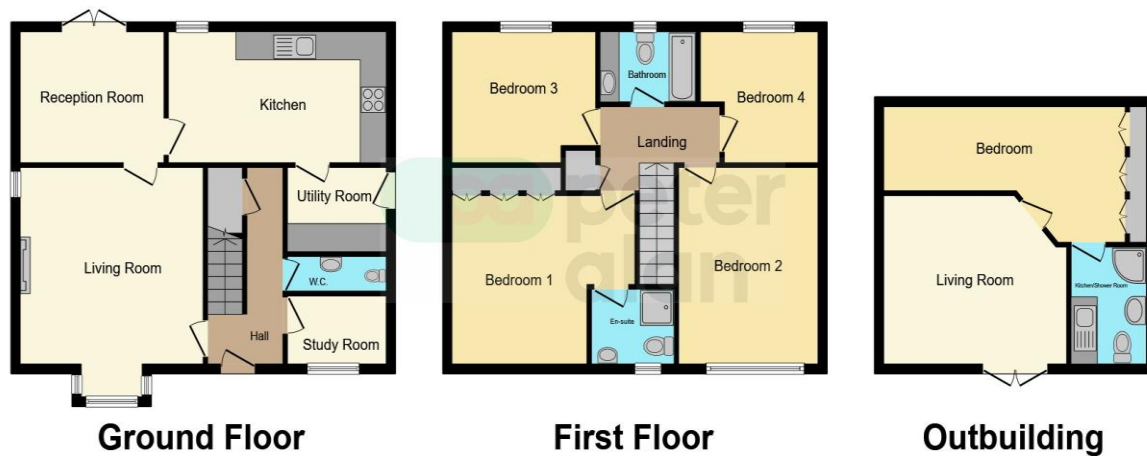

This floorplan is for illustrative purposes only and is not drawn to scale. Measurements, floor-areas, openings and orientations are approximate. They should not be relied upon for any purpose and do not form any part of an agreement. No liability is taken for any error or mis-statement. All parties must rely on their own inspections.

Important Information

Note while we endeavour to make our sales details accurate and reliable, if there is any point which is of particular interest to you, please contact the office and we will be pleased to confirm the position for you. We have not personally tested any apparatus, equipment, fixtures, fittings or services and cannot verify they are in working order or fit for their purposes. Nothing in these particulars is intended to indicate that carpets or curtains, furnishings or fittings, electrical goods (whether wired or not). Gas fires or light fittings or any other fixtures not expressly included form part of the property offered for sale. This computer generated Floorplan, if applicable, is intended as a general guide to the layout and design of the property. It is not to scale and should not be relied upon for dimensions. Tenure: We cannot confirm the tenure of the property as we have not had access to the legal documents. The buyer is advised to obtain verification from their solicitor or surveyor.

Peter Alan Limited is registered in England and Wales under company number 2073153. Registered Office is Cumbria House, 16-20 Hockliffe Street, Leighton Buzzard, Bedfordshire, LU7 1GN. VAT Registration Number is 500 2481 05. For activities relating to regulated mortgages and non-investment insurance contracts, Peter Alan Limited is an appointed representative of Connells Limited which is authorised and regulated by the Financial Conduct Authority. Connells Limited's Financial Services Register number is 302221. Most buy-to-let