



Twmbarlwm Close, offers over £160,000

- Two Bedrooms
- Off road parking
- Front and rear garden
- Modern kitchen
- Council tax band B
- EPC Rating: C



 2  1  1



About the property

Welcome to this charming, terraced property that is currently available for sale. The home is tastefully and neutrally decorated, making it a blank canvas, ready for you to make your mark.

The property boasts a comfortable living space with a delightful reception room that offers a tranquil view of the front garden. This room is perfect for cozy evenings in or entertaining guests. The house also comes with a modern kitchen, bathed in natural light. It has all the modern appliances you would need, ensuring a delightful cooking experience.

When it comes to rest and relaxation, the property offers two well-lit bedrooms. The master bedroom is a haven of calm and light, making it the perfect place to unwind after a long day.

The home's unique features include a parking space and a lovely garden. These outdoor spaces provide opportunities for relaxation, gardening, or a safe play area for children.

Located in a peaceful neighbourhood with strong community ties, this home is ideal for families, couples, and sharers alike. The area is well-served by public transport links and local amenities, with nearby parks adding to the charm of the location.

In summary, this terraced property promises a peaceful, comfortable, and convenient lifestyle. Make it your home and be part of a warm and welcoming community.



Accommodation

Agent Note

Agents Note: The Land Registry title has yet to be updated with the Vendor's details. Please ask the branch for more details.

Entrance Hallway

Living Room

12' 8" x 11' 9" (3.86m x 3.58m)

Kitchen

14' 11" x 7' 9" (4.55m x 2.36m)

Bedroom One

12' 5" x 12' 3" (3.78m x 3.73m)

Bedroom Two

8' 6" x 8' 5" (2.59m x 2.57m)

Bathroom

01633 221892

newport@peteralan.co.uk

Floorplan

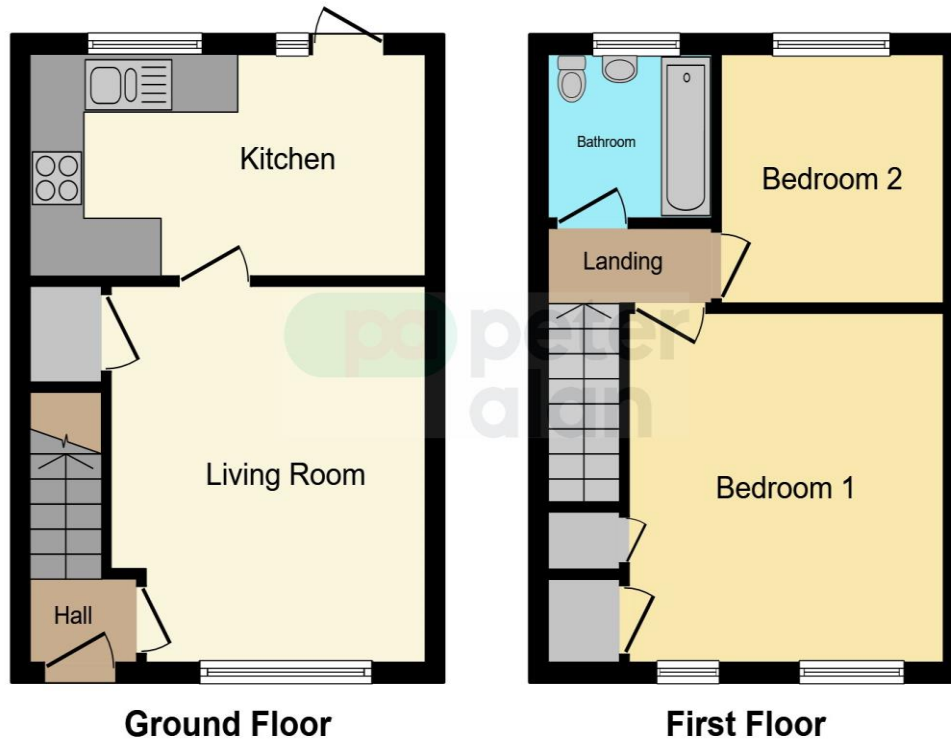

This floor plan is for illustrative purposes only. It is not drawn to scale. Any measurements, floor areas (including any total floor area), openings and orientation are approximate. No details are guaranteed, they cannot be relied upon for any purpose and they do not form part of any agreement. No liability is taken for any error, omission or misstatement. A party must rely upon its own inspection(s). Powered by www.focalagent.com



Important Information

Note while we endeavour to make our sales details accurate and reliable, if there is any point which is of particular interest to you, please contact the office and we will be pleased to confirm the position for you. We have not personally tested any apparatus, equipment, fixtures, fittings or services and cannot verify they are in working order or fit for their purposes. Nothing in these particulars is intended to indicate that carpets or curtains, furnishings or fittings, electrical goods (whether wired or not). Gas fires or light fittings or any other fixtures not expressly included form part of the property offered for sale. This computer generated Floorplan, if applicable, is intended as a general guide to the layout and design of the property. It is not to scale and should not be relied upon for dimensions. Tenure: We cannot confirm the tenure of the property as we have not had access to the legal documents. The buyer is advised to obtain verification from their solicitor or surveyor.

Peter Alan Limited is registered in England and Wales under company number 2073153, Registered Office is Cumbria House, 16-20 Hockliffe Street, Leighton Buzzard, Bedfordshire, LU7 1GN. VAT Registration Number is 500 2481 05. For activities relating to regulated mortgages and non-investment insurance contracts, Peter Alan Limited is an appointed representative of Connells Limited which is authorised and regulated by the Financial Conduct Authority. Connells Limited's Financial Services Register number is 302221. Most buy-to-let