



Channel View, £260,000

- No Chain
- Three bedrooms
- Single garage
- Sought-after location
- Council tax band E
- EPC Rating: Awaited



 3  1  2



About the property

For sale is a semi-detached house, nestled in a sought-after location, offering an attractive opportunity for first-time buyers, investors, and families. The property, in need of modernising, presents a unique chance to create a bespoke family home.

The house boasts three bedrooms: a spacious master bedroom, a second double bedroom and a well-sized single room. All rooms are bathed in natural light, providing a warm and inviting atmosphere.

The property comes with two reception rooms, both featuring large windows that let in plenty of natural light. The feature fireplace in the first reception room adds a touch of traditional charm. The second reception room offers a delightful view of the garden, promising a serene and peaceful setting for family gatherings or quiet afternoons.

The house also features a kitchen that benefits from an abundance of natural light. With two bathrooms, morning routines will be a breeze for larger families.

Externally, the property benefits from a single garage and parking facilities. The garden is a perfect size for children to play in or for summer BBQs.

The location is exceptional, with public transport links, local schools, and amenities all within walking distance. Moreover, the nearby green spaces offer ample opportunity for leisure and outdoor activities.

This property is in council tax band E. It also includes additional features such as a fireplace and parking.



Accommodation

Living Room

13' 1" x 13' 5" (3.99m x 4.09m)

Dining Room

9' 5" x 9' 8" (2.87m x 2.95m)

Kitchen

9' 2" x 8' 5" (2.79m x 2.57m)

Bedroom 1

11' 2" x 13' 5" (3.40m x 4.09m)

Bedroom 2

12' 5" x 9' 8" (3.78m x 2.95m)

Bedroom 3

10' 5" x 8' 2" (3.17m x 2.49m)

01633 221892

newport@peteralan.co.uk

Floorplan



Ground Floor

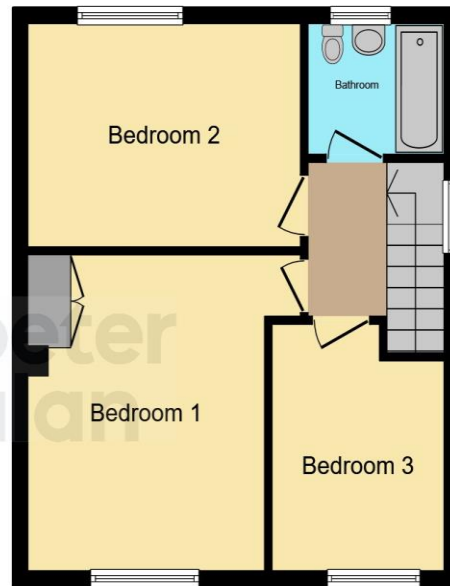

First Floor

This floor plan is for illustrative purposes only. It is not drawn to scale. Any measurements, floor areas (including any total floor area), openings and orientation are approximate. No details are guaranteed, they cannot be relied upon for any purpose and they do not form part of any agreement. No liability is taken for any error, omission or misstatement. A party must rely upon its own inspection(s). Powered by www.focalagent.com



Important Information

Note while we endeavour to make our sales details accurate and reliable, if there is any point which is of particular interest to you, please contact the office and we will be pleased to confirm the position for you. We have not personally tested any apparatus, equipment, fixtures, fittings or services and cannot verify they are in working order or fit for their purposes. Nothing in these particulars is intended to indicate that carpets or curtains, furnishings or fittings, electrical goods (whether wired or not). Gas fires or light fittings or any other fixtures not expressly included form part of the property offered for sale. This computer generated Floorplan, if applicable, is intended as a general guide to the layout and design of the property. It is not to scale and should not be relied upon for dimensions. Tenure: We cannot confirm the tenure of the property as we have not had access to the legal documents. The buyer is advised to obtain verification from their solicitor or surveyor.

Peter Alan Limited is registered in England and Wales under company number 2073153, Registered Office is Cumbria House, 16-20 Hockliffe Street, Leighton Buzzard, Bedfordshire, LU7 1GN. VAT Registration Number is 500 2481 05. For activities relating to regulated mortgages and non-investment insurance contracts, Peter Alan Limited is an appointed representative of Connells Limited which is authorised and regulated by the Financial Conduct Authority. Connells Limited's Financial Services Register number is 302221. Most buy-to-let