



Brinell Square, £265,000

- Off Road Parking
- Two Reception Rooms
- Four Bedrooms
- Sought After Location
- Close to Local Amenities
- Council Tax Band - E
- EPC Rating: Awaited



 3  2  2



About the property

For sale is a beautifully presented and immaculate semi-detached town house, situated in a peaceful location, surrounded by green spaces, nearby parks and plentiful walking and cycling routes. The strong local community, schools, and amenities just a short distance away, make this property the ideal home for families, couples, or sharers seeking a tranquil lifestyle.

This exceptional property boasts four bedrooms, a modern kitchen, and two spacious reception rooms. The master bedroom is a true delight with an en-suite and flooded with natural light. The second bedroom is a comfortable double, the third is notably spacious, and the fourth is a cozy single room.

The kitchen is fitted with modern appliances and benefits from abundant natural light, making it a delightful space for cooking and dining. The first reception room is airy and bright, featuring large windows. The second reception room is uniquely designed with a Juliet Balcony that invites in an abundance of light and fresh air.

Additionally, there are some unique features to this property that add to its appeal. There is a practical downstairs WC and a study on the ground floor, perfect for those working from home. The property also includes a car port and a beautifully maintained garden which offers a peaceful outdoor space to enjoy.

This property is a perfect blend of style, comfort and functionality, making it a truly welcoming home.



Accommodation

Entrance Hall

Dining Room

9' 4" x 6' 10" (2.84m x 2.08m)

Kitchen

8' 4" x 8' (2.54m x 2.44m)

Wc

Study

9' 4" x 6' 9" (2.84m x 2.06m)

Living Room

13' 10" x 11' 2" (4.22m x 3.40m)

Bedroom One

13' 10" x 8' 11" (4.22m x 2.72m)

Ensuite

Bedroom Two

13' 10" x 9' 1" (4.22m x 2.77m)

Bedroom Three

11' 3" x 6' 8" (3.43m x 2.03m)

Bedroom Four

8' 7" x 6' 9" (2.62m x 2.06m)

Bathroom

01633 221892

newport@peteralan.co.uk

Floorplan

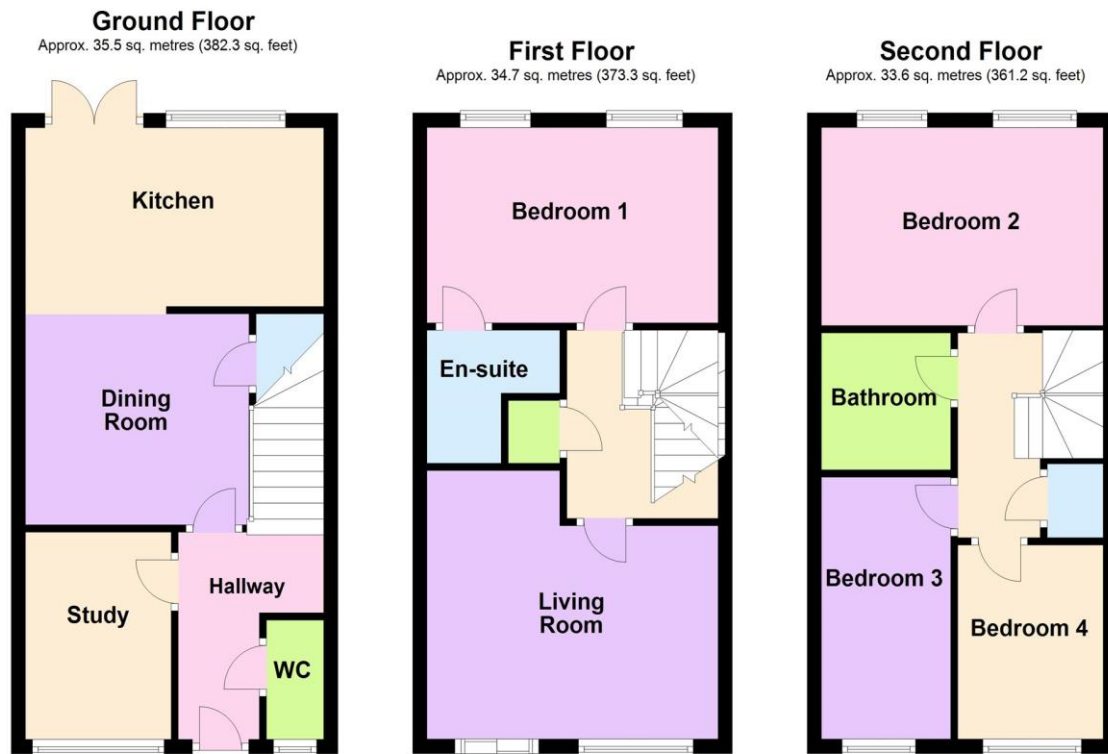

Total area: approx. 103.8 sq. metres (1116.8 sq. feet)

This is inaccurate. For visual pleasure only
Plan produced using PlanUp.

Important Information

Note while we endeavour to make our sales details accurate and reliable, if there is any point which is of particular interest to you, please contact the office and we will be pleased to confirm the position for you. We have not personally tested any apparatus, equipment, fixtures, fittings or services and cannot verify they are in working order or fit for their purposes. Nothing in these particulars is intended to indicate that carpets or curtains, furnishings or fittings, electrical goods (whether wired or not). Gas fires or light fittings or any other fixtures not expressly included form part of the property offered for sale. This computer generated Floorplan, if applicable, is intended as a general guide to the layout and design of the property. It is not to scale and should not be relied upon for dimensions. Tenure: We cannot confirm the tenure of the property as we have not had access to the legal documents. The buyer is advised to obtain verification from their solicitor or surveyor.

Peter Alan Limited is registered in England and Wales under company number 2073153, Registered Office is Cumbria House, 16-20 Hockliffe Street, Leighton Buzzard, Bedfordshire, LU7 1GN. VAT Registration Number is 500 2481 05. For activities relating to regulated mortgages and non-investment insurance contracts, Peter Alan Limited is an appointed representative of Connells Limited which is authorised and regulated by the Financial Conduct Authority. Connells Limited's Financial Services Register number is 302221. Most buy-to-let

