



Somerton Road, £110,000

- No Onwards Chain
- Freehold
- Rear Garden
- Excellent Transport Links
- Close to local amenities
- Council Tax Band - C
- EPC Rating: D



 3  1  1



About the property

Welcome to this charming end of terrace property that's bursting with potential and eagerly awaiting its new owners. Currently listed for sale, this home is a canvas ready to be transformed, making it an excellent opportunity for those who enjoy a renovation project.

The heart of the home offers a spacious reception room adorned with large windows that invite an abundance of natural light, creating a warm and welcoming atmosphere. Whether you're planning a cosy movie night or hosting a festive gathering, this room is flexible to cater to your needs.

Adjacent to the reception room is the kitchen, blessed with a good deal of natural light. It's the perfect space to try out new recipes or enjoy a morning coffee while planning your day.

Upstairs, you'll find three cosy bedrooms. The master bedroom offers sufficient space for a large bed and additional furnishings. The second bedroom is a generous double room, and the third a single room, offering flexibility for families, couples, or sharers.

Stepping outside, a delightful garden awaits, promising endless possibilities for those with a green thumb or dreams of creating an outdoor haven.

The location is a real highlight, nestled in an area with excellent public transport links, nearby schools, and local amenities. The strong local community vibe, coupled with the walking and cycling routes, ensures you'll feel right at home in no time.



Accommodation

Entrance

Living Room

16' 6" max x 12' 1" max (5.03m max x 3.68m max)

Kitchen Diner

15' 9" max x 11' 5" max (4.80m max x 3.48m max)

Bedroom One

11' 6" max x 10' 6" max (3.51m max x 3.20m max)

Bedroom Two

11' 7" max x 7' 7" max (3.53m max x 2.31m max)

Bedroom Three

11' 5" x 5' 9" (3.48m x 1.75m)

Bathroom

01633 221892

newport@peteralan.co.uk

Floorplan

GROUND FLOOR
381 sq.ft. (35.4 sq.m.) approx.

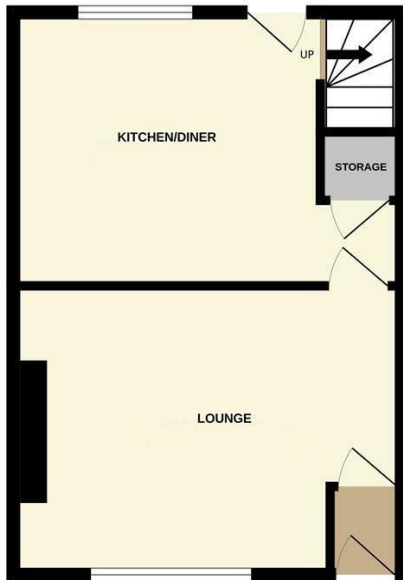

1ST FLOOR
378 sq.ft. (35.1 sq.m.) approx.



TOTAL FLOOR AREA : 759 sq.ft. (70.5 sq.m.) approx.

Whilst every attempt has been made to ensure the accuracy of the floorplan contained here, measurements of doors, windows, rooms and any other items are approximate and no responsibility is taken for any error, omission or mis-statement. This plan is for illustrative purposes only and should be used as such by any prospective purchaser. The services, systems and appliances shown have not been tested and no guarantee as to their operability or efficiency can be given.
Made with Metropix 62023

Important Information

Note while we endeavour to make our sales details accurate and reliable, if there is any point which is of particular interest to you, please contact the office and we will be pleased to confirm the position for you. We have not personally tested any apparatus, equipment, fixtures, fittings or services and cannot verify they are in working order or fit for their purposes. Nothing in these particulars is intended to indicate that carpets or curtains, furnishings or fittings, electrical goods (whether wired or not). Gas fires or light fittings or any other fixtures not expressly included form part of the property offered for sale. This computer generated Floorplan, if applicable, is intended as a general guide to the layout and design of the property. It is not to scale and should not be relied upon for dimensions. Tenure: We cannot confirm the tenure of the property as we have not had access to the legal documents. The buyer is advised to obtain verification from their solicitor or surveyor.

Peter Alan Limited is registered in England and Wales under company number 2073153, Registered Office is Cumbria House, 16-20 Hockliffe Street, Leighton Buzzard, Bedfordshire, LU7 1GN. VAT Registration Number is 500 2481 05. For activities relating to regulated mortgages and non-investment insurance contracts, Peter Alan Limited is an appointed representative of Connells Limited which is authorised and regulated by the Financial Conduct Authority. Connells Limited's Financial Services Register number is 302221. Most buy-to-let

