



## Brigantine Grove, £190,000

- No Onwards Chain
- Downstairs WC
- Rear Garden
- Off Road Parking
- Close to local Amenities
- Council Tax D
- EPC Rating: C



 2  1  1



## About the property

Welcome to this charming terraced property, now available for sale. This home is in a neutrally decorated condition, ready for you to put your personal touch. It offers a cosy and comfortable living environment, perfect for families or couples seeking their dream home.

The property boasts two bedrooms, one master and one single, perfect for a small family or for accommodating guests. The master bedroom is a highlight, offering space and comfort in a relaxing setting, while the single room is perfect for a child or an office space.

The kitchen is a wonderful feature of this home it also offers dining space. This creates a homely atmosphere where you can enjoy meals or spend quality time with family.

In addition to the bedrooms and the kitchen, the property features a single reception room. This space can be used as a lounge, a dining area, or anything else you might need.

Unique features of this property include a parking space and a garden, adding to the property's appeal. The garden is an ideal spot for relaxing, entertaining, or enjoying some outdoor activities.

Location-wise, the property is ideally situated with great public transport links, nearby schools, local amenities, parks, and strong local community. For those who enjoy walking or cycling, there are plenty of routes to explore.



## Accommodation

**Hallway**

**Living Room**

14' 4" x 13' 2" ( 4.37m x 4.01m )

**Kitchen**

14' 4" x 8' 3" ( 4.37m x 2.51m )

**Wc**

**Bedroom One**

12' 6" x 11' 5" ( 3.81m x 3.48m )

**Bedroom Two**

10' x 8' 3" ( 3.05m x 2.51m )

**Bathroom**

**Outside**

01633 221892

newport@peteralan.co.uk

## Floorplan

Approximate Gross Internal Area :-  
62 sq m / 667 sq ft

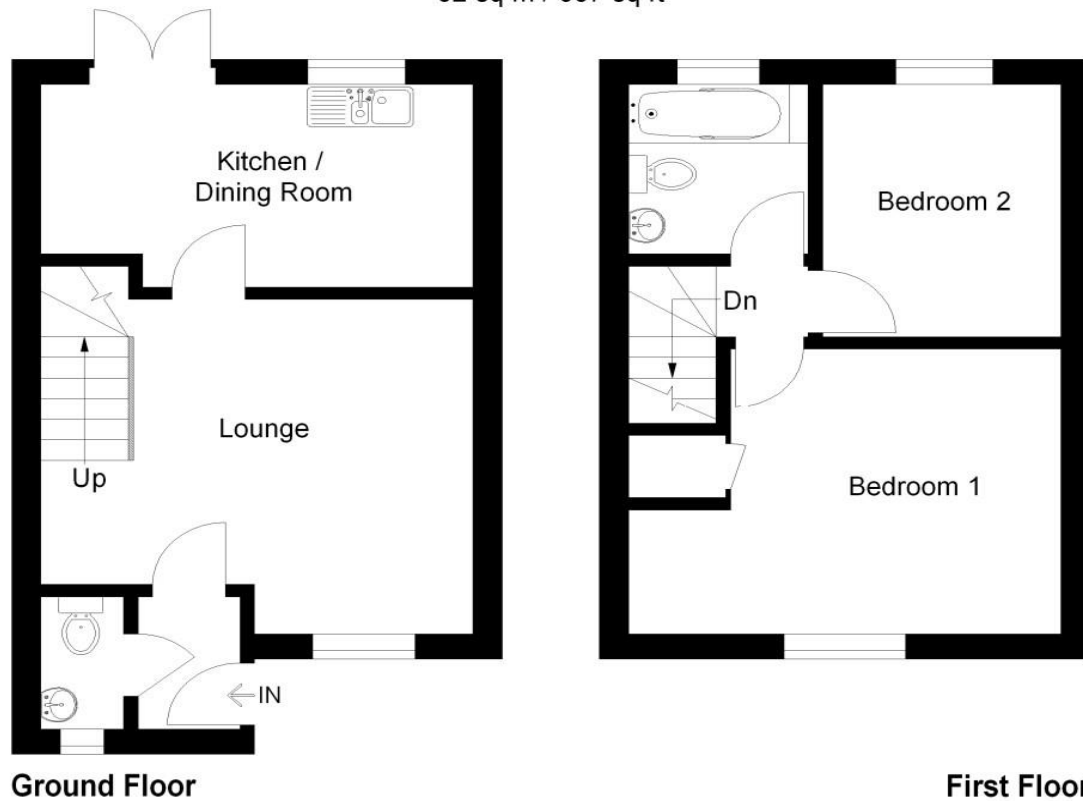

Illustration For Identification Purposes Only. Not To Scale

## Important Information

Note while we endeavour to make our sales details accurate and reliable, if there is any point which is of particular interest to you, please contact the office and we will be pleased to confirm the position for you. We have not personally tested any apparatus, equipment, fixtures, fittings or services and cannot verify they are in working order or fit for their purposes. Nothing in these particulars is intended to indicate that carpets or curtains, furnishings or fittings, electrical goods (whether wired or not). Gas fires or light fittings or any other fixtures not expressly included form part of the property offered for sale. This computer generated Floorplan, if applicable, is intended as a general guide to the layout and design of the property. It is not to scale and should not be relied upon for dimensions. Tenure: We cannot confirm the tenure of the property as we have not had access to the legal documents. The buyer is advised to obtain verification from their solicitor or surveyor.

Peter Alan Limited is registered in England and Wales under company number 2073153, Registered Office is Cumbria House, 16-20 Hockliffe Street, Leighton Buzzard, Bedfordshire, LU7 1GN. VAT Registration Number is 500 2481 05. For activities relating to regulated mortgages and non-investment insurance contracts, Peter Alan Limited is an appointed representative of Connells Limited which is authorised and regulated by the Financial Conduct Authority. Connells Limited's Financial Services Register number is 302221. Most buy-to-let

