



Langton Court Charles offers in the region of £120,000

- Council Tax - Band B
- Sold With Sitting Tenant
- LEASEHOLD
- Share of Freehold
- Walking Distance to Train and Bus Stations
- Ideal for Investors
- Chain Free
- EPC Rating: D





About the property

Welcome to this charming flat that's up for grabs and sold with tenants in situ! This delightful property is a recently renovated, open-plan gem with a neutral decor that offers a blank canvas for you to make your own. It's the perfect place for couples or sharers looking for their new cosy home.

The flat boasts a comfortable master bedroom, inviting you to relax after a long day. You'll also find a large, newly refurbished bathroom complete with a heated towel rail, perfect for those chilly mornings. The open-plan kitchen is fitted with all the modern appliances you could need, and its recent refurbishment means it's ready for you to cook up a storm!

The open-plan reception room is the heart of this home, offering a welcoming space to unwind and entertain. As for energy efficiency, the flat has an EPC rating of D and falls within council tax band B.

Located in an urban area with a strong local community, this flat is ideally situated. Public transport links, nearby schools, and local amenities are just a stone's throw away. Plus, nearby parks, walking routes, and cycling paths offer a breath of fresh air in the city.

This flat is not just a property, but a lifestyle choice. Offering a unique blend of style, convenience, and community, this could be the perfect new home for you. Don't miss out on this wonderful opportunity!



pa peter
alan
Land & New Homes

Accommodation

Entrance Hallway

Living Room

13' 8" x 14' (4.17m x 4.27m)

Bathroom

Master Bedroom

11' 4" x 13' 4" (3.45m x 4.06m)

01633 221892

newport@peteralan.co.uk

Floorplan

One bedroom apartment

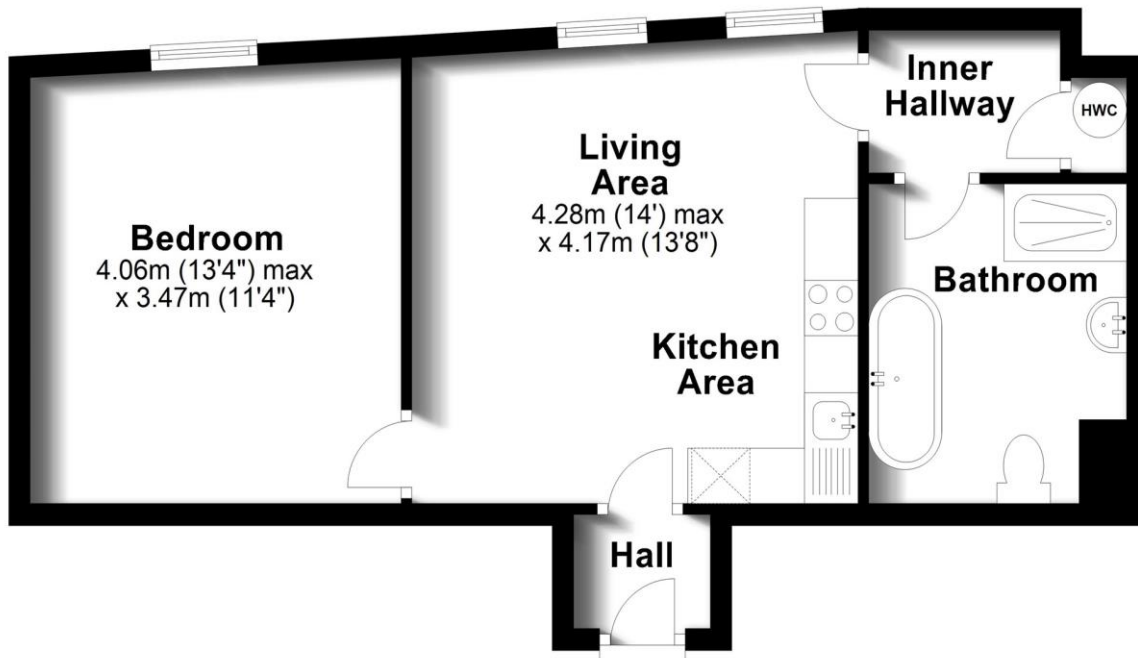

Total area: approx. 43.0 sq. metres (462.9 sq. feet)

Important Information

Note while we endeavour to make our sales details accurate and reliable, if there is any point which is of particular interest to you, please contact the office and we will be pleased to confirm the position for you. We have not personally tested any apparatus, equipment, fixtures, fittings or services and cannot verify they are in working order or fit for their purposes. Nothing in these particulars is intended to indicate that carpets or curtains, furnishings or fittings, electrical goods (whether wired or not). Gas fires or light fittings or any other fixtures not expressly included form part of the property offered for sale. This computer generated Floorplan, if applicable, is intended as a general guide to the layout and design of the property. It is not to scale and should not be relied upon for dimensions. Tenure: We cannot confirm the tenure of the property as we have not had access to the legal documents. The buyer is advised to obtain verification from their solicitor or surveyor.

Peter Alan Limited is registered in England and Wales under company number 2073153. Registered Office is Cumbria House, 16-20 Hockliffe Street, Leighton Buzzard, Bedfordshire, LU7 1GN. VAT Registration Number is 500 2481 05. For activities relating to regulated mortgages and non-investment insurance contracts, Peter Alan Limited is an appointed representative of Connells Limited which is authorised and regulated by the Financial Conduct Authority. Connells Limited's Financial Services Register number is 302221. Most buy-to-let

pa peter
alan