



Farmwood Close, Guide price £130,000

- Sale by Modern Auction (T&Cs apply)
- Subject to an undisclosed Reserve Price
- Buyers fees apply
- Council Tax - Band D
- Chain Free
- Three Bedrooms
- Close to the M4
- Semi Detached
- EPC Rating: D



 3  1  2



About the property

A three bedroom semi-detached Home living accommodation briefly comprising, to the ground floor: Entrance Hallway, Living Room opening to Dining Room and Kitchen. On the first floor: 3 Bedrooms & Bathroom. Outside to the front, pathway leads up to the front door. To the rear: a tiered garden with a mixture of patio area and lawn area.

Situated just off Chepstow Road is this three bedroom, semi-detached family home, located close to all local amenities, popular schools, bus routes, shopping at Newport Retail Park, world class leisure facilities at the Celtic Manor Resort whilst also having the easiest of access to junction 24 of the M4 making it perfect for commuting.

Accommodation

Auctioneer's Comments

This property is offered through Modern Method of Auction. Should you view, offer or bid your data will be shared with the Auctioneer, iamsold Limited. This method requires both parties to complete the transaction within 56 days, allowing buyers to proceed with mortgage finance (subject to lending criteria, affordability and survey).

The buyer is required to sign a reservation agreement and make payment of a non-refundable Reservation Fee of 4.5% of the purchase price including VAT, subject to a minimum of £6600.00 including VAT. This fee is paid in addition to purchase price and will be considered as part of the chargeable consideration for the property in the calculation for stamp duty liability. Buyers will be required to complete an identification process with iamsold and provide proof of how the purchase would be funded.

The property has a Buyer Information Pack containing documents about the property. The documents may not tell you everything you need to know, so you must complete your own due diligence before bidding. A sample of the Reservation Agreement and terms and conditions are contained within this pack. The buyer will also make payment of £300 inc VAT towards the preparation cost of the pack.



Entrance Hallway Enter via uPVC door, fitted carpet throughout and stairs to first floor.

Living Room 13' 3" x 10' 1" (4.04m x 3.07m) uPVC window to front. radiator and fitted carpet throughout.

Dining Room 9' 1" x 10' 6" (2.77m x 3.20m) uPVC window to rear, radiator and fitted carpet throughout.

Kitchen 12' 1" x 9' 2" (3.68m x 2.79m) uPVC window to rear and door to side. Fitted kitchen with matching wall and base units, inset sink space for a free standing cooker.

Bedroom One 13' 2" x 10' 1" (4.01m x 3.07m) uPVC window to front and fitted carpet throughout.

Bedroom Two 12' 4" x 10' 6" (3.76m x 3.20m) uPVC window rear and fitted carpet throughout.

Bedroom Three 8' 1" x 8' 2" (2.46m x 2.49m) uPVC window to front and fitted carpet throughout.

Bathroom White suite comprising of low level w.c. pedestal sink, bath, frosted window and radiator

The estate agent and auctioneer may recommend the services of other providers to you, in which they will be paid for the referral. These services are optional, and you will be advised of any payment, in writing before any services are accepted. Listing is subject to a start price and undisclosed reserve price that can change.

Floorplan

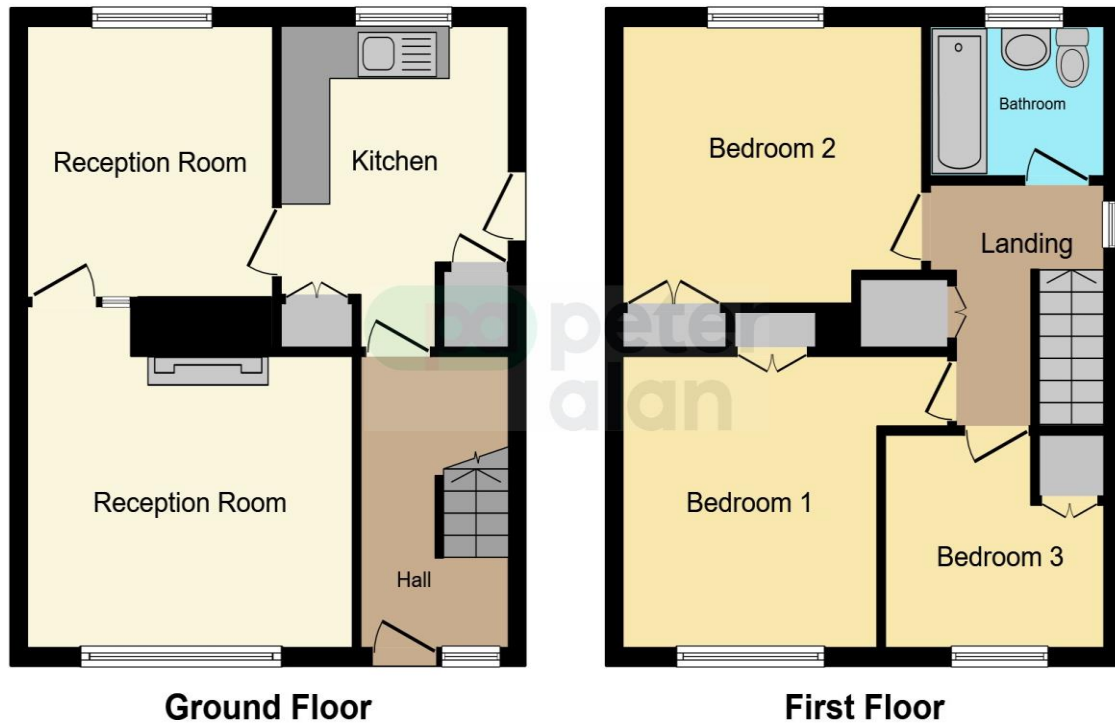

This floorplan is for illustrative purposes only and is not drawn to scale. Measurements, floor-areas, openings and orientations are approximate. They should not be relied upon for any purpose and do not form any part of an agreement. No liability is taken for any error or mis-statement. All parties must rely on their own inspections.

Important Information

Note while we endeavour to make our sales details accurate and reliable, if there is any point which is of particular interest to you, please contact the office and we will be pleased to confirm the position for you. We have not personally tested any apparatus, equipment, fixtures, fittings or services and cannot verify they are in working order or fit for their purposes. Nothing in these particulars is intended to indicate that carpets or curtains, furnishings or fittings, electrical goods (whether wired or not). Gas fires or light fittings or any other fixtures not expressly included form part of the property offered for sale. This computer generated Floorplan, if applicable, is intended as a general guide to the layout and design of the property. It is not to scale and should not be relied upon for dimensions. Tenure: We cannot confirm the tenure of the property as we have not had access to the legal documents. The buyer is advised to obtain verification from their solicitor or surveyor.