



Greenwood Drive offers over £210,000

- Sought After, Family Friendly Area
- Ideal First Time Purchase
- No On Going Chain
- Deceptively Spacious
- Sizable Driveway
- EPC Rating: D



3 1 2



About the property

A well presented, lovingly maintained and deceptively spacious, ideal family home or first time purchase nestled into the popular, family friendly, Cimla Area. Available for sale with no on going chain, boasting convenient links to well renowned schools including Gnoll & Crynallt Primary, Cefn Saeson Community Comprehensive and Neath College. Great for commuters with links to the A465, M4 Corridor and a main line train station within Neath Town Centre. The home is approached through a sizable paved driveway, with an adjacent lawn space, and side access available through to an enclosed rear garden consisting of a terraced patio, lawn space and brick built shed. Internally, the property comprises of an entrance porch, generous dining room with stairs to the landing, a Lounge with views down the valley and a fitted kitchen. The first floor houses three bedrooms, access to the loft space and the family bathroom. Internal viewings are highly recommended to truly appreciate this lovely home!

Accommodation

Entrance Porch

Lounge

16' 3" x 12' 1" (4.95m x 3.68m)

Dining Room

14' 1" x 15' 2" max (4.29m x 4.62m max)

Kitchen

14' 1" x 7' 1" (4.29m x 2.16m)

Landing



Bedroom One

14' 1" max x 9' 7" (4.29m max x 2.92m)

Bedroom Two

12' 5" x 9' 7" (3.78m x 2.92m)

Bedroom Three

9' 6" x 6' 6" (2.90m x 1.98m)

Bathroom

Driveway + front & Rear Gardens

Floorplan



Ground Floor

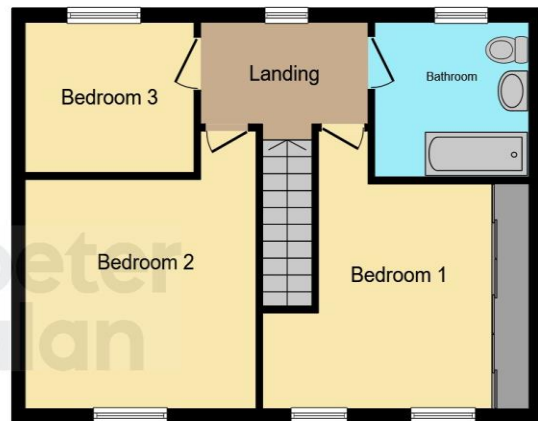

First Floor

This floor plan is for illustrative purposes only. It is not drawn to scale. Any measurements, floor areas (including any total floor area), openings and orientation are approximate. No details are guaranteed, they cannot be relied upon for any purpose and they do not form part of any agreement. No liability is taken for any error, omission or misstatement. A party must rely upon its own inspection(s). Powered by www.focalagent.com

Important Information

Note while we endeavour to make our sales details accurate and reliable, if there is any point which is of particular interest to you, please contact the office and we will be pleased to confirm the position for you. We have not personally tested any apparatus, equipment, fixtures, fittings or services and cannot verify they are in working order or fit for their purposes. Nothing in these particulars is intended to indicate that carpets or curtains, furnishings or fittings, electrical goods (whether wired or not). Gas fires or light fittings or any other fixtures not expressly included form part of the property offered for sale. This computer generated Floorplan, if applicable, is intended as a general guide to the layout and design of the property. It is not to scale and should not be relied upon for dimensions. Tenure: We cannot confirm the tenure of the property as we have not had access to the legal documents. The buyer is advised to obtain verification from their solicitor or surveyor.

Peter Alan Limited is registered in England and Wales under company number 2073153, Registered Office is Cumbria House, 16-20 Hockliffe Street, Leighton Buzzard, Bedfordshire, LU7 1GN. VAT Registration Number is 500 2481 05. For activities relating to regulated mortgages and non-investment insurance contracts, Peter Alan Limited is an appointed representative of Connells Limited which is authorised and regulated by the Financial Conduct Authority. Connells Limited's Financial Services Register number is 302221. Most buy-to-let