



Old Road offers in the region of £190,000

- Immaculately Presented
- Walk In Wardrobe
- Utility Room
- Low Maintenance Patio Areas
- Modern Fitted Kitchen & Bathrooms
- EPC Rating: C



 2  1  1



About the property

The Perfect Family Home! A deceptively spacious, three bedrooms dwelling nestled beside the woodland on Old Road, Neath! With excellent links to local amenities including frequently running buses, well renowned schools, such as Ysgol Tyle'r Ynn and Ysgol Carreg Hir, and Neath Town Centre with high street stores, main line train station, bars and restaurants. Also well situated for commuters with great access to the M4 corridor and A465!

The home is approached through a low maintenance courtyard to the front with side access available through to the rear garden, with steps up to laid patio, stepping stones, fenced-off decking and wildflower beds. Internally, the property comprises of an entrance hallway, with stairs to the landing and doors through to a spacious lounge, with fitted media wall, a kitchen diner and utility room. The first floor houses stairs to the second floor landing, the family bathroom and two bedrooms of which the master features a further bedroom opened up to a walk in wardrobe. The loft space has been converted to our third bedroom with a skylight window and restricted head height in some spaces. Internal viewings are highly recommended to truly appreciate this lovely home.





Accommodation

Entrance Hallway

Lounge

14' 3" x 13' Max (4.34m x 3.96m Max)

Kitchen Diner

13' 6" Plus Recess x 8' 7" (4.11m Plus Recess x 2.62m)

Utility Room

6' 3" x 5' 1" (1.91m x 1.55m)

Landing

Bedroom One

10' 9" x 10' 8" (3.28m x 3.25m)

Dressing Room

12' 7" x 8' 3" (3.84m x 2.51m)

Bedroom Two

8' 9" x 7' 6" (2.67m x 2.29m)

Bathroom

Converted Loft Room

11' 7" Plus Recess x 12' 2" (3.53m Plus Recess x 3.71m)

Front & Rear Gardens

Floorplan

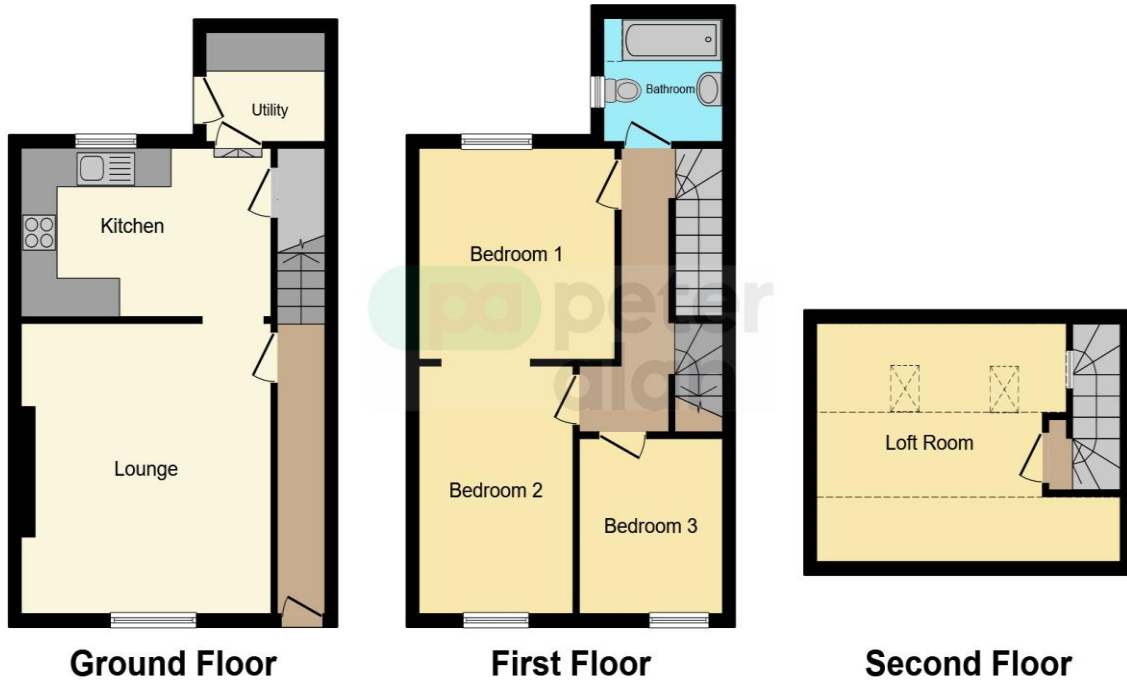

This floor plan is for illustrative purposes only. It is not drawn to scale. Any measurements, floor areas (including any total floor area), openings and orientation are approximate. No details are guaranteed, they cannot be relied upon for any purpose and they do not form part of any agreement. No liability is taken for any error, omission or misstatement. A party must rely upon its own inspection(s). Powered by www.focalagent.com

Important Information

Note while we endeavour to make our sales details accurate and reliable, if there is any point which is of particular interest to you, please contact the office and we will be pleased to confirm the position for you. We have not personally tested any apparatus, equipment, fixtures, fittings or services and cannot verify they are in working order or fit for their purposes. Nothing in these particulars is intended to indicate that carpets or curtains, furnishings or fittings, electrical goods (whether wired or not). Gas fires or light fittings or any other fixtures not expressly included form part of the property offered for sale. This computer generated Floorplan, if applicable, is intended as a general guide to the layout and design of the property. It is not to scale and should not be relied upon for dimensions. Tenure: We cannot confirm the tenure of the property as we have not had access to the legal documents. The buyer is advised to obtain verification from their solicitor or surveyor.

Peter Alan Limited is registered in England and Wales under company number 2073153, Registered Office is Cumbria House, 16-20 Hockliffe Street, Leighton Buzzard, Bedfordshire, LU7 1GN. VAT Registration Number is 500 2481 05. For activities relating to regulated mortgages and non-investment insurance contracts, Peter Alan Limited is an appointed representative of Connells Limited which is authorised and regulated by the Financial Conduct Authority. Connells Limited's Financial Services Register number is 302221. Most buy-to-let