



Ynys Cadwyn, offers in the region of £170,000

- No On Going Chain
- Sizable Driveway
- Multiple Living Spaces
- Extension From Kitchen
- Recently Refurbished
- EPC Rating: D



3 1 2



About the property

A lovingly maintained and recently Refurbished, ideal family home or first-time purchase now available with no on-going chain within the village location of Glynneath, Neath Port Talbot! Boasting excellent links to Welsh and English-speaking primary schools, the Brecon Beacons National Park and the M4 Corridor via the A465!

The home is approached through a gated driveway and lawned garden to the front with side access available through to an enclosed, partially paved garden at the rear. Internally, the property comprises of an open entrance hallway with dining area and double doors to the garden, stairs leading to the landing and flowing through to the lounge and modern fitted kitchen. The first floor houses all three bedrooms, access to the loft space and the family shower room!

Internal viewings are highly recommended to truly appreciate the home!





Accommodation

Entrance Hallway

Dining Area

11' Plus Recess x 9' 6" (3.35m Plus Recess x 2.90m)

Lounge

14' x 11' 5" Max (4.27m x 3.48m Max)

Kitchen

13' 3" x 10' 7" Max (4.04m x 3.23m Max)

Landing

Bedroom One

11' 6" Max x 12' 2" Max (3.51m Max x 3.71m Max)

Bedroom Two

11' Max x 10' (3.35m Max x 3.05m)

Bedroom Three

9' 6" x 7' 3" (2.90m x 2.21m)

Shower Room

Front & Rear Garden

Floorplan

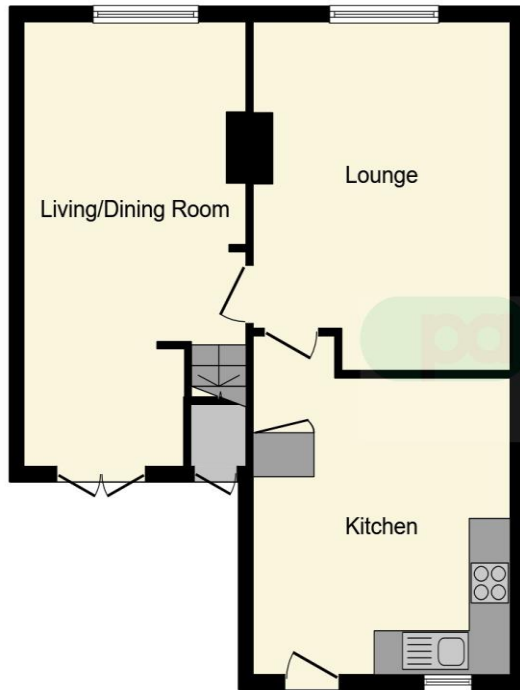

Ground Floor



First Floor

This floor plan is for illustrative purposes only. It is not drawn to scale. Any measurements, floor areas (including any total floor area), openings and orientation are approximate. No details are guaranteed, they cannot be relied upon for any purpose and they do not form part of any agreement. No liability is taken for any error, omission or misstatement. A party must rely upon its own inspection(s). Powered by www.focalagent.com

Important Information

Note while we endeavour to make our sales details accurate and reliable, if there is any point which is of particular interest to you, please contact the office and we will be pleased to confirm the position for you. We have not personally tested any apparatus, equipment, fixtures, fittings or services and cannot verify they are in working order or fit for their purposes. Nothing in these particulars is intended to indicate that carpets or curtains, furnishings or fittings, electrical goods (whether wired or not). Gas fires or light fittings or any other fixtures not expressly included form part of the property offered for sale. This computer generated Floorplan, if applicable, is intended as a general guide to the layout and design of the property. It is not to scale and should not be relied upon for dimensions. Tenure: We cannot confirm the tenure of the property as we have not had access to the legal documents. The buyer is advised to obtain verification from their solicitor or surveyor.

Peter Alan Limited is registered in England and Wales under company number 2073153, Registered Office is Cumbria House, 16-20 Hockliffe Street, Leighton Buzzard, Bedfordshire, LU7 1GN. VAT Registration Number is 500 2481 05. For activities relating to regulated mortgages and non-investment insurance contracts, Peter Alan Limited is an appointed representative of Connells Limited which is authorised and regulated by the Financial Conduct Authority. Connells Limited's Financial Services Register number is 302221. Most buy-to-let