



Olive Branch Crescent, £150,000

- Ideal Family Home or First Time Purchase
- Recently Refurbished
- Landscaped Rear Garden
- Council Tax Band - B
- Two Reception Rooms
- EPC Rating: D



3 1 1



About the property

A lovingly maintained and well presented ideal family home in a very sought after location! Conveniently located for access to local shops through Neath Town centre and schools including Llansawel Primary school and Ysgol Gynradd Gymraeg Tyle'r Ynn. Perfect for commuters providing great links to public transport and the M4 corridor.

Internally, the property comprises of an entrance hallway with stairs to the first floor and doors leading into the lounge, fitted with a feature fireplace, and kitchen. Fitted with wall and base units, integrated appliances such as a fridge freezer, cooker, hood and hob with a door into the dining room boasting a patio door into the rear garden. The first floor features the family bathroom and three generous bedrooms, of which two have fitted wardrobes, and fitted carpets throughout. Internal viewings are highly recommended.

Accommodation

Entrance Hall

Lounge

13' 9" x 11' 1" (4.19m x 3.38m)

Kitchen

10' 6" x 9' 6" (3.20m x 2.90m)

Dining Room

9' 1" x 10' 4" (2.77m x 3.15m)



Bedroom One

9' 9" x 11' 1" (2.97m x 3.38m)

Bedroom Two

10' 8" x 11' 2" (3.25m x 3.40m)

Bedroom Three

6' 4" x 8' 4" (1.93m x 2.54m)

Bathroom

Front & Rear Gardens

Floorplan

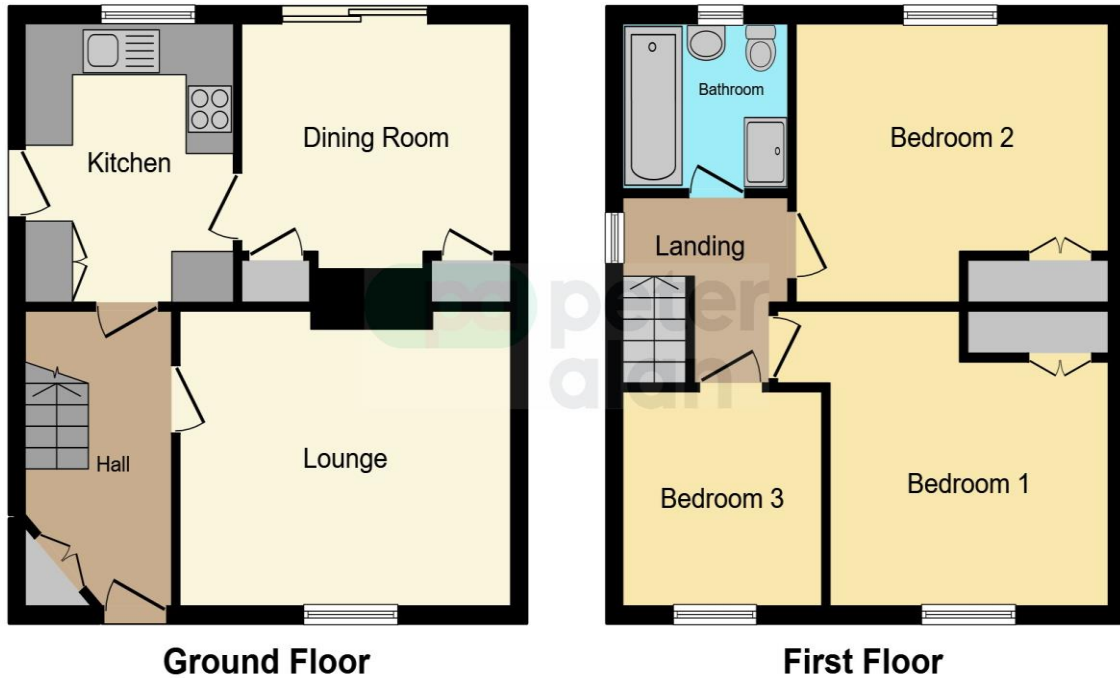

This floor plan is for illustrative purposes only. It is not drawn to scale. Any measurements, floor areas (including any total floor area), openings and orientation are approximate. No details are guaranteed, they cannot be relied upon for any purpose and they do not form part of any agreement. No liability is taken for any error, omission or misstatement. A party must rely upon its own inspection(s). Powered by www.focalagent.com

Important Information

Note while we endeavour to make our sales details accurate and reliable, if there is any point which is of particular interest to you, please contact the office and we will be pleased to confirm the position for you. We have not personally tested any apparatus, equipment, fixtures, fittings or services and cannot verify they are in working order or fit for their purposes. Nothing in these particulars is intended to indicate that carpets or curtains, furnishings or fittings, electrical goods (whether wired or not). Gas fires or light fittings or any other fixtures not expressly included form part of the property offered for sale. This computer generated Floorplan, if applicable, is intended as a general guide to the layout and design of the property. It is not to scale and should not be relied upon for dimensions. Tenure: We cannot confirm the tenure of the property as we have not had access to the legal documents. The buyer is advised to obtain verification from their solicitor or surveyor.

Peter Alan Limited is registered in England and Wales under company number 2073153, Registered Office is Cumbria House, 16-20 Hockliffe Street, Leighton Buzzard, Bedfordshire, LU7 1GN. VAT Registration Number is 500 2481 05. For activities relating to regulated mortgages and non-investment insurance contracts, Peter Alan Limited is an appointed representative of Connells Limited which is authorised and regulated by the Financial Conduct Authority. Connells Limited's Financial Services Register number is 302221. Most buy-to-let