



Cwmfelin Road, offers over £340,000

- Well presented family home
- Solar panels
- Garage
- Off road Parking
- Recently fitted windows and doors
- Large rear garden
- Great Location!
- EPC Rating: C



 3  1  2



About the property

Welcome to this stunning 3-bedroom detached house complete with solar panels and recently fitted windows. This ideal property has a huge enclosed rear garden perfect for the hot weather ahead as well as off-street parking. Close to shops and amenities. New price off £340,000, viewing recommended!!

Accommodation

Kitchen

15' 2" x 11' 4" (4.62m x 3.45m)

UPVC window to rear. Matching wall and base units. integrated appliances. Original hard wood flooring.

Living Room

11' x 10' (3.35m x 3.05m)

UPVC window to the front. Archway into kitchen. Original wooden flooring.

Lounge



22' 9" x 11' 5" (6.93m x 3.48m)

UPVC window to front, UPVC door leading to garden.
Original wood flooring.

Bedroom 1

17' 6" x 13' 2" (5.33m x 4.01m)

UPVC window to front. Original hard wood flooring.

Bedroom 2

11' 6" x 10' 2" (3.51m x 3.10m)

UPVC window to rear. Original hard wood flooring.

Bedroom 3

13' 2" x 9' 4" (4.01m x 2.84m)

UPVC window to front. Original hard wood flooring.

Bathroom

UPVC window to rear. Bath with shower over, hand basin,
W.C, walk in shower.

Floorplan

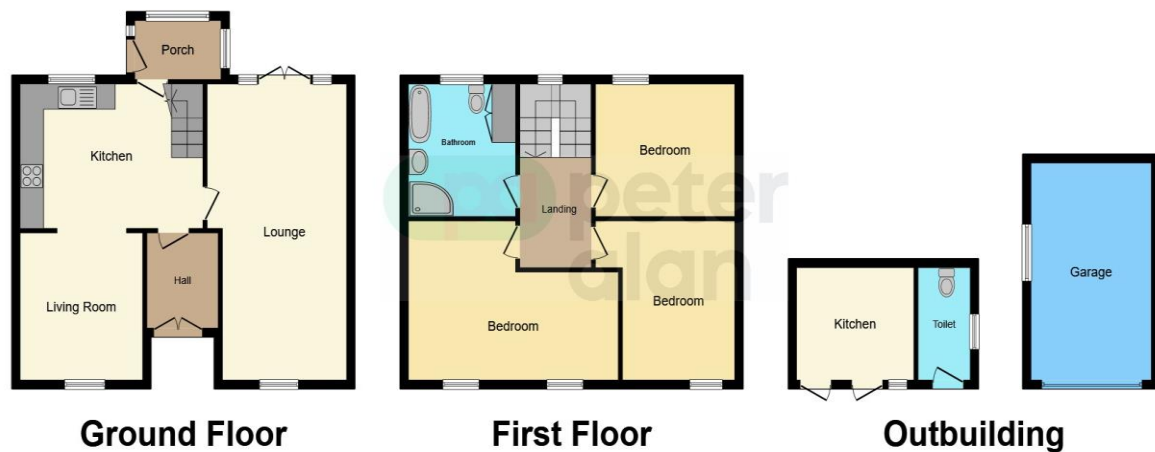

This floorplan is for illustrative purposes only and is not drawn to scale. Measurements, floor-areas, openings and orientations are approximate. They should not be relied upon for any purpose and do not form any part of an agreement. No liability is taken for any error or mis-statement. All parties must rely on their own inspections.

Important Information

Note while we endeavour to make our sales details accurate and reliable, if there is any point which is of particular interest to you, please contact the office and we will be pleased to confirm the position for you. We have not personally tested any apparatus, equipment, fixtures, fittings or services and cannot verify they are in working order or fit for their purposes. Nothing in these particulars is intended to indicate that carpets or curtains, furnishings or fittings, electrical goods (whether wired or not). Gas fires or light fittings or any other fixtures not expressly included form part of the property offered for sale. This computer generated Floorplan, if applicable, is intended as a general guide to the layout and design of the property. It is not to scale and should not be relied upon for dimensions. Tenure: We cannot confirm the tenure of the property as we have not had access to the legal documents. The buyer is advised to obtain verification from their solicitor or surveyor.

Peter Alan Limited is registered in England and Wales under company number 2073153, Registered Office is Cumbria House, 16-20 Hockliffe Street, Leighton Buzzard, Bedfordshire, LU7 1GN. VAT Registration Number is 500 2481 05. For activities relating to regulated mortgages and non-investment insurance contracts, Peter Alan Limited is an appointed representative of Connells Limited which is authorised and regulated by the Financial Conduct Authority. Connells Limited's Financial Services Register number is 302221. Most buy-to-let