



Upper Thomas Street, £140,000

- Council Tax Band B
- No onward chain
- Investment opportunity
- Close to town centre
- Great transport links
- EPC Rating: E



 4  1  3



About the property

A terraced house in a popular location in Merthyr Tydfil, ideally suited for investors or families. It boasts three bedrooms and one bathroom, along with three reception rooms and a single kitchen. This house provides ample living space, however, it is in need of modernising, making it a fantastic opportunity for those looking to put their own stamp on a property. Being sold with no onward chain.

The property contains a unique feature, an attic room that could be utilised as additional living space or for storage purposes. The main bathroom is a comfortable shower room located conveniently on the lower ground floor. Further enhancing the practicality of the layout is the kitchen which is situated on the lower ground floor, ensuring that all the essential facilities are easily accessible.

The third reception room provides access to a garden and it could serve as an ideal dining room, providing a lovely view and natural light while enjoying meals. This makes for a pleasant dining experience, especially during the summer months.

The property is advantageously located close to the town centre, with public transport links, nearby schools, and local amenities all within easy reach.



Accommodation

Hall

8' 9" max x 11' 8" max (2.67m max x 3.56m max)

Reception 1

11' 3" max x 14' 5" max (3.43m max x 4.39m max)

Reception 2

10' 7" max x 12' 2" max (3.23m max x 3.71m max)

Kitchen

9' 7" max x 10' 9" max (2.92m max x 3.28m max)

Dining Room

Landing

Shower Room

Bedroom 1

13' 1" max x 11' 6" max (3.99m max x 3.51m max)

Bedroom 2

Bedroom 3

9' max x 7' max (2.74m max x 2.13m max)

Attic Room

15' 1" max x 18' max (4.60m max x 5.49m max)
Restricted head height

01685 722223

merthytydfil@peteralan.co.uk

Floorplan



Lower Ground Floor

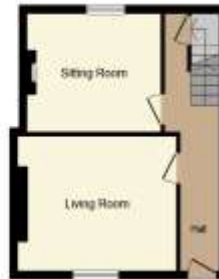

Ground Floor

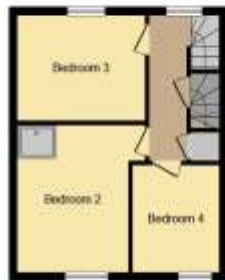

First Floor



Second Floor

This floor plan is for illustrative purposes only. It is not drawn to scale. Any measurements, floor areas (including any total floor area), openings and orientation are approximate. No details are guaranteed, they cannot be relied upon for any purpose and they do not form part of any agreement. No liability is taken for any error, omission or misstatement. A party must rely upon its own inspection(s). Powered by www.focalagent.com



Important Information

Note while we endeavour to make our sales details accurate and reliable, if there is any point which is of particular interest to you, please contact the office and we will be pleased to confirm the position for you. We have not personally tested any apparatus, equipment, fixtures, fittings or services and cannot verify they are in working order or fit for their purposes. Nothing in these particulars is intended to indicate that carpets or curtains, furnishings or fittings, electrical goods (whether wired or not). Gas fires or light fittings or any other fixtures not expressly included form part of the property offered for sale. This computer generated Floorplan, if applicable, is intended as a general guide to the layout and design of the property. It is not to scale and should not be relied upon for dimensions. Tenure: We cannot confirm the tenure of the property as we have not had access to the legal documents. The buyer is advised to obtain verification from their solicitor or surveyor.

Peter Alan Limited is registered in England and Wales under company number 2073153, Registered Office is Cumbria House, 16-20 Hockliffe Street, Leighton Buzzard, Bedfordshire, LU7 1GN. VAT Registration Number is 500 2481 05. For activities relating to regulated mortgages and non-investment insurance contracts, Peter Alan Limited is an appointed representative of Connells Limited which is authorised and regulated by the Financial Conduct Authority. Connells Limited's Financial Services Register number is 302221. Most buy-to-let