



Maes Y Haf, offers over £145,000

- Council Tax Band B
- Driveway
- Well-presented
- Rear garden
- Close to local amenities
- Good transport links
- EPC Rating: D



 3
  1
  2



About the property

A well-presented semi-detached house in a popular location in Maes -y-Haf, Rhymney. This property is ideally situated with easy access to public transport links, nearby schools, local amenities, and walking routes.

The house boasts a generous layout, including three well-proportioned bedrooms. At the heart of this home is the open-plan living/dining room which provides direct access to the garden, allowing a seamless indoor-outdoor living experience. The property also features a functional kitchen, equipped to cater to all your culinary needs. A single bathroom services the home.

One of the unique features of this property is the beautiful garden, providing a safe and private space for outdoor activities. There is also a driveway for off-street parking and a loft space offering additional storage.

This property is ideally suited for first-time buyers or families, promising a comfortable lifestyle and potential for personalisation. If you're seeking a quality home in a convenient location, this property could be the perfect find for you.



Accommodation

Hall

Living/Dining Room

Kitchen

9' 6" Max x 9' 6" Max (2.90m Max x 2.90m Max)

Landing

Bathroom

Bedroom 1

9' 8" Max x 11' 5" Plus door recess (2.95m Max x 3.48m Plus door recess)

Bedroom 2

Irregular Shaped Room x (x)

Bedroom 3

Loft Room

01685 722223

merthytydfil@peteralan.co.uk

Floorplan

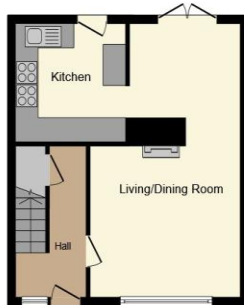

Ground Floor



First Floor

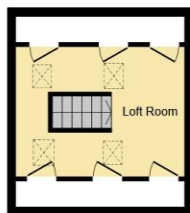

Second Floor



Outbuilding

This floor plan is for illustrative purposes only. It is not drawn to scale. Any measurements, floor areas (including any total floor area), openings and orientation are approximate. No details are guaranteed, they cannot be relied upon for any purpose and they do not form part of any agreement. No liability is taken for any error, omission or misstatement. A party must rely upon its own inspection(s). Powered by www.focalagent.com

Important Information

Note while we endeavour to make our sales details accurate and reliable, if there is any point which is of particular interest to you, please contact the office and we will be pleased to confirm the position for you. We have not personally tested any apparatus, equipment, fixtures, fittings or services and cannot verify they are in working order or fit for their purposes. Nothing in these particulars is intended to indicate that carpets or curtains, furnishings or fittings, electrical goods (whether wired or not). Gas fires or light fittings or any other fixtures not expressly included form part of the property offered for sale. This computer generated Floorplan, if applicable, is intended as a general guide to the layout and design of the property. It is not to scale and should not be relied upon for dimensions. Tenure: We cannot confirm the tenure of the property as we have not had access to the legal documents. The buyer is advised to obtain verification from their solicitor or surveyor.

Peter Alan Limited is registered in England and Wales under company number 2073153, Registered Office is Cumbria House, 16-20 Hockliffe Street, Leighton Buzzard, Bedfordshire, LU7 1GN. VAT Registration Number is 500 2481 05. For activities relating to regulated mortgages and non-investment insurance contracts, Peter Alan Limited is an appointed representative of Connells Limited which is authorised and regulated by the Financial Conduct Authority. Connells Limited's Financial Services Register number is 302221. Most buy-to-let

pa peter
alan