



## Coronation Terrace, £110,000

- Council tax band B
- No onward chain
- In need of modernisation
- Rear garden
- Sought after location
- EPC Rating: Awaited



 3  1  1



## About the property

Presenting for sale, this terraced property that presents a fantastic opportunity for families, couples, or investors. Although in need of modernisation, this property holds immense potential to be transformed into a dream home or an impressive investment asset.

Internally, the property boasts a generous layout, featuring one open-plan reception room that offers an excellent space for relaxation and entertaining. The kitchen provides ample scope for refurbishment, making it an ideal canvas for those looking to create a space that mirrors their personal taste and style. Further complementing the specifications of this home are three bedrooms, offering plenty of room to grow and adapt with changing needs.

The property comes complete with a shower room with separate toilet, providing an added layer of convenience. It's noteworthy to mention that the property is offered with no onward chain. Externally, the property features a rear garden

The location of this property is truly desirable, benefiting from nearby public transport links and local amenities for everyday needs. Plus, the proximity to local schools makes it an excellent choice for families.



## Accommodation

### Hall

10' 4" Max x 7' 2" Max ( 3.15m Max x 2.18m Max )

### Living Room

21' Max x 11' 9" Plus alcove ( 6.40m Max x 3.58m Plus alcove )

### Kitchen

13' 3" Max x 8' 8" Max ( 4.04m Max x 2.64m Max )

### Hall

### Shower Room

### Toilet

### Landing

### Bedroom 1

12' 6" Max x 7' 9" Max ( 3.81m Max x 2.36m Max )

### Bedroom 2

9' 6" Max x 9' 9" Max ( 2.90m Max x 2.97m Max )

### Bedroom 3

01685 722223

merthyrdfil@peteralan.co.uk

## Floorplan

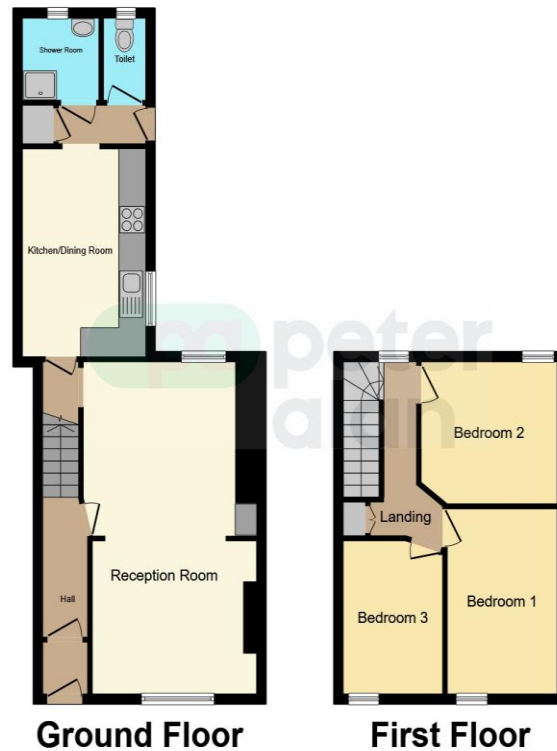

This floor plan is for illustrative purposes only. It is not drawn to scale. Any measurements, floor areas (including any total floor area), openings and orientation are approximate. No details are guaranteed, they cannot be relied upon for any purpose and they do not form part of any agreement. No liability is taken for any error, omission or misstatement. A party must rely upon its own inspection(s). Powered by [www.focalagent.com](http://www.focalagent.com)

## Important Information

Note while we endeavour to make our sales details accurate and reliable, if there is any point which is of particular interest to you, please contact the office and we will be pleased to confirm the position for you. We have not personally tested any apparatus, equipment, fixtures, fittings or services and cannot verify they are in working order or fit for their purposes. Nothing in these particulars is intended to indicate that carpets or curtains, furnishings or fittings, electrical goods (whether wired or not). Gas fires or light fittings or any other fixtures not expressly included form part of the property offered for sale. This computer generated Floorplan, if applicable, is intended as a general guide to the layout and design of the property. It is not to scale and should not be relied upon for dimensions. Tenure: We cannot confirm the tenure of the property as we have not had access to the legal documents. The buyer is advised to obtain verification from their solicitor or surveyor.

Peter Alan Limited is registered in England and Wales under company number 2073153, Registered Office is Cumbria House, 16-20 Hockliffe Street, Leighton Buzzard, Bedfordshire, LU7 1GN. VAT Registration Number is 500 2481 05. For activities relating to regulated mortgages and non-investment insurance contracts, Peter Alan Limited is an appointed representative of Connells Limited which is authorised and regulated by the Financial Conduct Authority. Connells Limited's Financial Services Register number is 302221. Most buy-to-let

