



Nantymoed, Troedryhiw

£135,000

- Council tax band A
- No onward chain
- Split-level living
- Mature rear garden
- Close to local amenities
- Nearby walking routes
- EPC Rating: D



4 1 1



About the property

Presenting a delightful, semi-detached property now available for purchase. The property is ready to welcome new owners with no onward chain. This charming home boasts four bedrooms, providing ample space for both families and couples. With a single, well-sized shower room, comfort and convenience are guaranteed.

The heart of the home is its single reception room, a welcoming space promising warmth and relaxation. The property offers a functional kitchen, equipped and ready for all culinary adventures.

Unique to this property is its split-level design, providing an interesting dynamic and flow throughout the home. Complementing this, a private garden invites outdoor enjoyment.

Located in a highly sought-after area with excellent public transport links, this property offers easy access to local amenities, schools, and parks. Active residents will appreciate the nearby walking and cycling routes, promoting a healthy lifestyle amidst natural beauty.



Accommodation

Hall

Kitchen

9' 8" Max x 10' 8" Max (2.95m Max x 3.25m Max)

Living Room

14' 8" Max x 14' 3" Max (4.47m Max x 4.34m Max)

Shower Room

Bedroom 3/Sitting Room

13' 1" Max x 6' 4" Max (3.99m Max x 1.93m Max)

Landing 2

Bedroom 1

9' 1" Max x 14' 3" Max (2.77m Max x 4.34m Max)

Bedroom 2

8' 6" Max x 14' 1" Max (2.59m Max x 4.29m Max)

Bedroom 4

6' 8" Max x 10' 8" Max (2.03m Max x 3.25m Max)

01685 722223

merthyrdfil@peteralan.co.uk

Floorplan

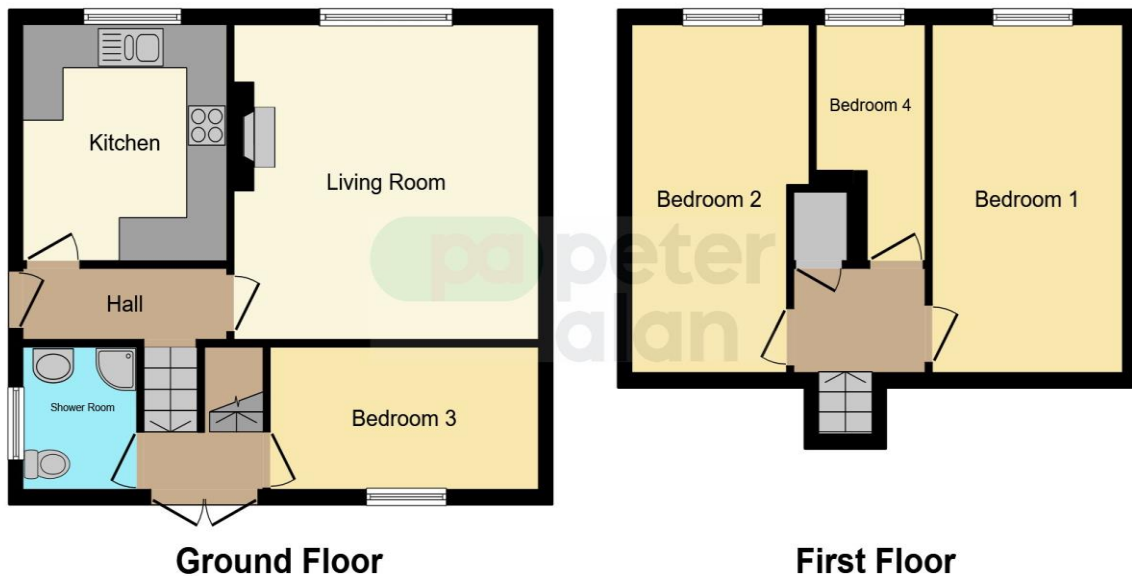

This floor plan is for illustrative purposes only. It is not drawn to scale. Any measurements, floor areas (including any total floor area), openings and orientation are approximate. No details are guaranteed, they cannot be relied upon for any purpose and they do not form part of any agreement. No liability is taken for any error, omission or misstatement. A party must rely upon its own inspection(s). Powered by www.focalagent.com

Important Information

Note while we endeavour to make our sales details accurate and reliable, if there is any point which is of particular interest to you, please contact the office and we will be pleased to confirm the position for you. We have not personally tested any apparatus, equipment, fixtures, fittings or services and cannot verify they are in working order or fit for their purposes. Nothing in these particulars is intended to indicate that carpets or curtains, furnishings or fittings, electrical goods (whether wired or not). Gas fires or light fittings or any other fixtures not expressly included form part of the property offered for sale. This computer generated Floorplan, if applicable, is intended as a general guide to the layout and design of the property. It is not to scale and should not be relied upon for dimensions. Tenure: We cannot confirm the tenure of the property as we have not had access to the legal documents. The buyer is advised to obtain verification from their solicitor or surveyor.

Peter Alan Limited is registered in England and Wales under company number 2073153, Registered Office is Cumbria House, 16-20 Hockliffe Street, Leighton Buzzard, Bedfordshire, LU7 1GN. VAT Registration Number is 500 2481 05. For activities relating to regulated mortgages and non-investment insurance contracts, Peter Alan Limited is an appointed representative of Connells Limited which is authorised and regulated by the Financial Conduct Authority. Connells Limited's Financial Services Register number is 302221. Most buy-to-let

pa peter
alan