



Cyfarthfa Mews, offers over £270,000

- Council Tax Band - C
- No onward chain
- Sought after location
- Off-road parking
- Set over three floors
- Close to local amenities and transport links
- EPC Rating: C



 4  2  1



About the property

A four-bedroom property set in a popular residential area of Cyfarthfa Mews, Merthyr Tydfil. This property would make a perfect family home.

Set over three floors, the ground floor comprises of entrance hall, W.C, spacious reception room, open plan kitchen/ diner and utility room. To the first floor there are three bedrooms and a family bathroom. To the second floor is the master bedroom with en-suite and walk-in-wardrobe. The property also provides off road. The property also boasts a garden with patio and lawn area.

The property is ideally located within close proximity to Cyfarthfa Park, Cyfarthfa Retail Park and Trago Mills, Merthyr Tydfil town centre and close to popular attractions such as Bike Park Wales, Brecon Beacons National Park. Road links include A470 and A465 Heads of the Valleys Road, perfect for commuting.

Early viewing highly recommended to avoid disappointment and to fully appreciate all this property has to offer.



Accommodation

Hallway

14' 5" Max x 10' 4" Max (4.39m Max x 3.15m Max)

W.C

Bedroom 1

Reception Room

12' Max x 15' Max (3.66m Max x 4.57m Max)

18' 8" Max x 10' 5" Max (5.69m Max x 3.17m Max)

Walk-In-Wardrobe Area

Kitchen/Diner

En-Suite

24' 1" Max x 9' 2" Max (7.34m Max x 2.79m Max)

Utility Room

Landing

Bathroom

Bedroom 4

7' 9" Max x 8' 3" Max (2.36m Max x 2.51m Max)

Bedroom 3

10' 8" Max x 8' 3" Max (3.25m Max x 2.51m Max)

Bedroom 2

Floorplan



Ground Floor

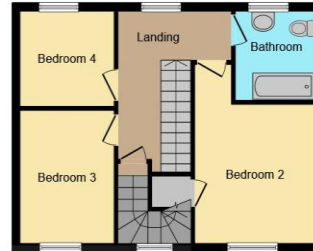

First Floor

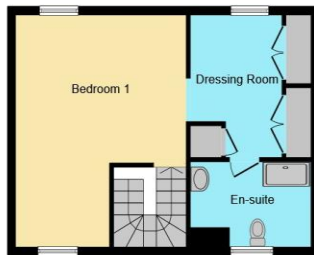

Second Floor

This floor plan is for illustrative purposes only. It is not drawn to scale. Any measurements, floor areas (including any total floor area), openings and orientation are approximate. No details are guaranteed, they cannot be relied upon for any purpose and they do not form part of any agreement. No liability is taken for any error, omission or misstatement. A party must rely upon its own inspection(s). Powered by www.focalagent.com

Important Information

Note while we endeavour to make our sales details accurate and reliable, if there is any point which is of particular interest to you, please contact the office and we will be pleased to confirm the position for you. We have not personally tested any apparatus, equipment, fixtures, fittings or services and cannot verify they are in working order or fit for their purposes. Nothing in these particulars is intended to indicate that carpets or curtains, furnishings or fittings, electrical goods (whether wired or not). Gas fires or light fittings or any other fixtures not expressly included form part of the property offered for sale. This computer generated Floorplan, if applicable, is intended as a general guide to the layout and design of the property. It is not to scale and should not be relied upon for dimensions. Tenure: We cannot confirm the tenure of the property as we have not had access to the legal documents. The buyer is advised to obtain verification from their solicitor or surveyor.

Peter Alan Limited is registered in England and Wales under company number 2073153, Registered Office is Cumbria House, 16-20 Hockliffe Street, Leighton Buzzard, Bedfordshire, LU7 1GN. VAT Registration Number is 500 2481 05. For activities relating to regulated mortgages and non-investment insurance contracts, Peter Alan Limited is an appointed representative of Connells Limited which is authorised and regulated by the Financial Conduct Authority. Connells Limited's Financial Services Register number is 302221. Most buy-to-let