



Brynteg, Treharris offers over £135,000

- Tax band B
- No onward chain
- Well presented
- Over three floors
- Great location
- Side access
- EPC Rating: D



 2  1  2



About the property

A well presented two bedroom end terrace house in a great location. Close to local amenities and transport links. Viewing highly recommended to appreciate all this property has to offer. No onward chain.

Set over three floors, the entrance level comprises of the reception room and dining room, to the lower ground level is a kitchen. The lower level also provides access to the rear garden. The first floor comprises of two bedrooms and family bathroom. Side access.

Set in an ideal location close to transport links such as the A470 and popular bus routes and within close proximity to local amenities.



Accommodation

Hall

Stairs to lower ground floor and first floor. Door to dining room and living room.

Dining Room

10' 8" x 10' 2" Max (3.25m x 3.10m Max)
Window to front.

Living Room

Irregular Shaped Room x (x)
Window to rear.

Kitchen

12' 6" Max x 10' 4" Max (3.81m Max x 3.15m Max)
Door to rear garden. Door to cupboard. Fitted cupboards. Window to rear.

Landing

Doors to all bedrooms and bathroom.

Bedroom 1

9' 7" x 16' 5" Max (2.92m x 5.00m Max)
Double windows to front.

Bedroom 2

11' 7" x 8' 9" (3.53m x 2.67m)
Window to rear.

Bathroom

Window to rear. Fitted bath, wash basin and toilet.

Floorplan



Lower Ground Floor



Ground Floor

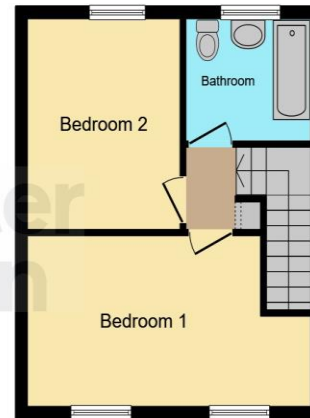

First Floor

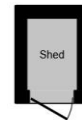

Outbuilding

This floorplan is for illustrative purposes only and is not drawn to scale. Measurements, floor-areas, openings and orientations are approximate. They should not be relied upon for any purpose and do not form any part of an agreement. No liability is taken for any error or mis-statement. All parties must rely on their own inspections.

Important Information

Note while we endeavour to make our sales details accurate and reliable, if there is any point which is of particular interest to you, please contact the office and we will be pleased to confirm the position for you. We have not personally tested any apparatus, equipment, fixtures, fittings or services and cannot verify they are in working order or fit for their purposes. Nothing in these particulars is intended to indicate that carpets or curtains, furnishings or fittings, electrical goods (whether wired or not). Gas fires or light fittings or any other fixtures not expressly included form part of the property offered for sale. This computer generated Floorplan, if applicable, is intended as a general guide to the layout and design of the property. It is not to scale and should not be relied upon for dimensions. Tenure: We cannot confirm the tenure of the property as we have not had access to the legal documents. The buyer is advised to obtain verification from their solicitor or surveyor.

Peter Alan Limited is registered in England and Wales under company number 2073153, Registered Office is Cumbria House, 16-20 Hockliffe Street, Leighton Buzzard, Bedfordshire, LU7 1GN. VAT Registration Number is 500 2481 05. For activities relating to regulated mortgages and non-investment insurance contracts, Peter Alan Limited is an appointed representative of Connells Limited which is authorised and regulated by the Financial Conduct Authority. Connells Limited's Financial Services Register number is 302221. Most buy-to-let