



Suffolk Place, £135,000

- 1 bedroom ground floor flat
- Close proximity to Porthcawl Town Centre
- Close to Porthcawl Sea Front
- Council Tax Band B
- Ideal buy to let or first time buy.
- EPC Rating: D





About the property

Situated in the highly sought-after location of Suffolk Place, this spacious and light-filled one-bedroom ground floor flat is perfectly positioned within walking distance of Porthcawl Town Centre and just moments from the beautiful seafront. The property is offered for sale with no ongoing chain, making it an ideal purchase for first-time buyers or those looking for a smart buy-to-let investment.

The accommodation is well-proportioned throughout and begins with a welcoming entrance hall that leads into a generous lounge area. This bright and airy space features French doors opening out onto a private rear courtyard garden, creating a lovely indoor-outdoor flow that's ideal for relaxing or entertaining. From the lounge, a door leads through to the front-facing master bedroom, which benefits from a charming bay window that fills the room with natural light.

To the rear of the property, there is a spacious and functional kitchen with ample room for appliances and storage. Beyond the kitchen, a secondary hallway provides additional access to the rear courtyard garden and leads to a well-appointed bathroom.

This well-located flat combines space, comfort, and convenience, all within easy reach of local shops, cafes,



Accommodation

Entrance Hall

Lounge

9' 3" max x 13' 2" max (2.82m max x 4.01m max)

Bedroom

8' 8" max x 11' 2" max (2.64m max x 3.40m max)

Kitchen

9' 8" x 11' 3" (2.95m x 3.43m)

Rear Hallway

Bathroom

01656 771600

porthcawl@peteralan.co.uk

Floorplan

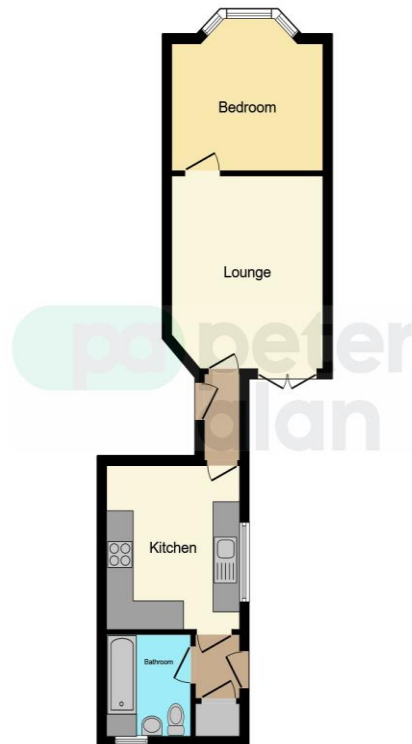

This floor plan is for illustrative purposes only. It is not drawn to scale. Any measurements, floor areas (including any total floor area), openings and orientation are approximate. No details are guaranteed, they cannot be relied upon for any purpose and they do not form part of any agreement. No liability is taken for any error, omission or misstatement. A party must rely upon its own inspection(s). Powered by www.focalagent.com



Important Information

Note while we endeavour to make our sales details accurate and reliable, if there is any point which is of particular interest to you, please contact the office and we will be pleased to confirm the position for you. We have not personally tested any apparatus, equipment, fixtures, fittings or services and cannot verify they are in working order or fit for their purposes. Nothing in these particulars is intended to indicate that carpets or curtains, furnishings or fittings, electrical goods (whether wired or not). Gas fires or light fittings or any other fixtures not expressly included form part of the property offered for sale. This computer generated Floorplan, if applicable, is intended as a general guide to the layout and design of the property. It is not to scale and should not be relied upon for dimensions. Tenure: We cannot confirm the tenure of the property as we have not had access to the legal documents. The buyer is advised to obtain verification from their solicitor or surveyor.

Peter Alan Limited is registered in England and Wales under company number 2073153, Registered Office is Cumbria House, 16-20 Hockliffe Street, Leighton Buzzard, Bedfordshire, LU7 1GN. VAT Registration Number is 500 2481 05. For activities relating to regulated mortgages and non-investment insurance contracts, Peter Alan Limited is an appointed representative of Connells Limited which is authorised and regulated by the Financial Conduct Authority. Connells Limited's Financial Services Register number is 302221. Most buy-to-let