



Anglesey Way, £450,000

- Four Bedroom Detached Bungalow
- Garage and Driveway to the side
- Corner plot with wrap around Garden
- Council Tax Band F
- Close to Rest Bay
- EPC Rating: D



 4  2  2



About the property

Offered for sale is this beautifully presented four-bedroom detached bungalow, ideally located in a highly sought-after area, just a short distance from the Blue Flag-awarded Rest Bay beach and the charming, historic village of Nottage.

The spacious accommodation comprises a welcoming hallway leading into a bright and airy lounge/diner, perfect for relaxing or entertaining. From here, you'll find access to a well-equipped kitchen and a conservatory that overlooks the rear garden. The property also boasts four generously sized bedrooms and a modern family bathroom.

Externally, the bungalow enjoys a wrap-around garden, with a lawned area to the front and a private, low-maintenance courtyard garden to the rear. Additional benefits include off-road parking and a garage.

This fantastic home offers comfortable, versatile living in an enviable coastal location. Viewing is highly recommended to fully appreciate everything this property has to offer.



Accommodation

Entrance Hall

Lounge - 13' 1" x 15' 9" plus bay (3.99m x 4.80m plus bay)

Dining Room - 9' 8" x 9' 9" (2.95m x 2.97m)

Kitchen - 9' 8" x 9' 9" (2.95m x 2.97m)

Utility Room - 2' 6" x 4' 8" (0.76m x 1.42m)

W.C.

Conservatory - 9' 8" x 9' 9" (2.95m x 2.97m)

Bedroom One - 14' 5" x 10' 2" (4.39m x 3.10m)

Bedroom Two - 9' 1" max x 11' 5" max (2.77m max x 3.48m max)

Bedroom Three - 8' 9" x 7' 3" (2.67m x 2.21m)

Bedroom Four - 9' 1" x 6' 4" (2.77m x 1.93m)

Bathroom

Externally

Garage

01656 771600

bridgend@peteralan.co.uk

Floorplan

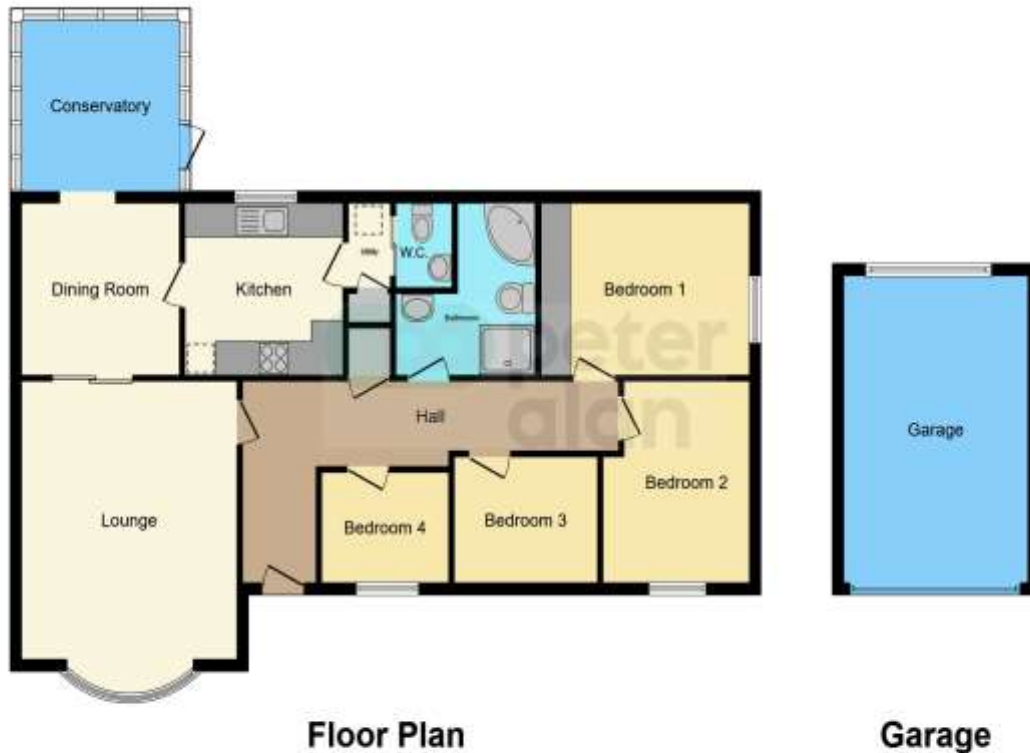

This floor plan is for illustrative purposes only. It is not drawn to scale. Any measurements, floor areas (including any total floor area), openings and orientation are approximate. No details are guaranteed, they cannot be relied upon for any purpose and they do not form part of any agreement. No liability is taken for any error, omission or misstatement. A party must rely upon its own inspection(s). Powered by www.focalagent.com

Important Information

Note while we endeavour to make our sales details accurate and reliable, if there is any point which is of particular interest to you, please contact the office and we will be pleased to confirm the position for you. We have not personally tested any apparatus, equipment, fixtures, fittings or services and cannot verify they are in working order or fit for their purposes. Nothing in these particulars is intended to indicate that carpets or curtains, furnishings or fittings, electrical goods (whether wired or not). Gas fires or light fittings or any other fixtures not expressly included form part of the property offered for sale. This computer generated Floorplan, if applicable, is intended as a general guide to the layout and design of the property. It is not to scale and should not be relied upon for dimensions. Tenure: We cannot confirm the tenure of the property as we have not had access to the legal documents. The buyer is advised to obtain verification from their solicitor or surveyor.

Peter Alan Limited is registered in England and Wales under company number 2073153, Registered Office is Cumbria House, 16-20 Hockliffe Street, Leighton Buzzard, Bedfordshire, LU7 1GN. VAT Registration Number is 500 2481 05. For activities relating to regulated mortgages and non-investment insurance contracts, Peter Alan Limited is an appointed representative of Connells Limited which is authorised and regulated by the Financial Conduct Authority. Connells Limited's Financial Services Register number is 302221. Most buy-to-let

pa peter
alan