



The Jennings

£230,000

- Harbour Location
- Loft Style Apartment
- One Bedroom
- Views Over Promenade & Coastline
- Allocated Parking Area
- EPC Rating: D





About the property

Discover a remarkable opportunity to own a high-specification apartment in the iconic Jennings Building, a landmark situated at Porthcawl Harbour. This prime residence is just moments away from the vibrant town center-home to award-winning restaurants, a picturesque promenade, boutique shops, and beautiful beaches.

Upon entry, residents enjoy a secure communal entrance accessed via stairs or lift. Inside, the apartment welcomes you with a refined entrance hallway featuring a cloakroom and a versatile storage cupboard, complete with dedicated space for a washing machine. A thoughtfully positioned study adds to the convenience and functionality of the layout.

The open-plan living area is a true highlight, boasting a vaulted ceiling accented by exposed beams and stone walls, and offering stunning views along the promenade and coastline. The kitchen is elegantly appointed with built-in appliances and sleek granite worktops, perfect for both everyday living and entertaining.

A private mezzanine bedroom enhances the appeal, featuring a generous walk-in wardrobe and an en-suite shower room, with a chic glass balustrade that overlooks the living area. To complete this exquisite offering, the apartment includes allocated parking for your convenience.



Accommodation

Entrance Hall

Cloakroom

Study

6' 4" x 9' 2" (1.93m x 2.79m)

Kitchen/Living

14' 7" x 18' 6" (4.45m x 5.64m)

Bedroom One

11' 2" x 13' 1" (3.40m x 3.99m)

01656 771600

porthcawl@peteralan.co.uk

Floorplan

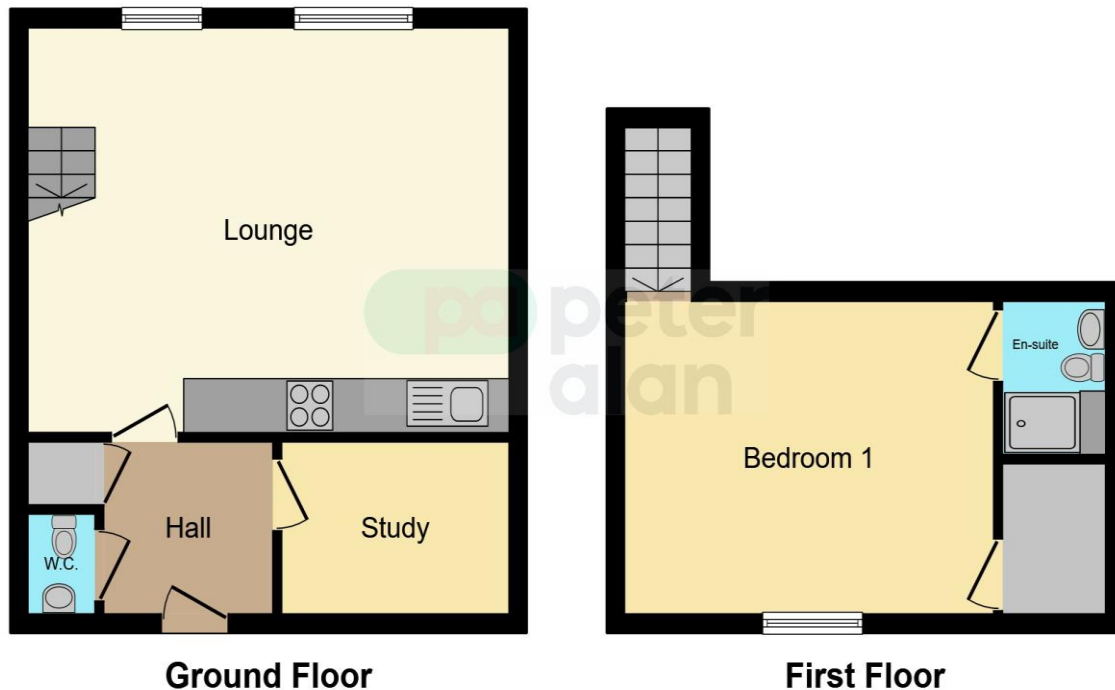

This floor plan is for illustrative purposes only. It is not drawn to scale. Any measurements, floor areas (including any total floor area), openings and orientation are approximate. No details are guaranteed, they cannot be relied upon for any purpose and they do not form part of any agreement. No liability is taken for any error, omission or misstatement. A party must rely upon its own inspection(s). Powered by www.focalagent.com



Important Information

Note while we endeavour to make our sales details accurate and reliable, if there is any point which is of particular interest to you, please contact the office and we will be pleased to confirm the position for you. We have not personally tested any apparatus, equipment, fixtures, fittings or services and cannot verify they are in working order or fit for their purposes. Nothing in these particulars is intended to indicate that carpets or curtains, furnishings or fittings, electrical goods (whether wired or not). Gas fires or light fittings or any other fixtures not expressly included form part of the property offered for sale. This computer generated Floorplan, if applicable, is intended as a general guide to the layout and design of the property. It is not to scale and should not be relied upon for dimensions. Tenure: We cannot confirm the tenure of the property as we have not had access to the legal documents. The buyer is advised to obtain verification from their solicitor or surveyor.

Peter Alan Limited is registered in England and Wales under company number 2073153, Registered Office is Cumbria House, 16-20 Hockliffe Street, Leighton Buzzard, Bedfordshire, LU7 1GN. VAT Registration Number is 500 2481 05. For activities relating to regulated mortgages and non-investment insurance contracts, Peter Alan Limited is an appointed representative of Connells Limited which is authorised and regulated by the Financial Conduct Authority. Connells Limited's Financial Services Register number is 302221. Most buy-to-let