



Bryn- Eithen School

£210,000

- Beautiful garden for outdoor activities
- Three spacious reception rooms
- Cosy sanctuary with fireplace
- Council Tax B
- EPC Rating: D



 3
  2
  3



About the property

A charming semi-detached property in good condition, nestled in an area with schools, green spaces, walking and cycling routes. This home is ideally suited for families seeking a harmonious blend of character and convenience. The property boasts three spacious reception rooms, each one showcasing unique features. Reception room one is a cosy sanctuary with a fireplace, high ceilings, and beautiful wood floors. The second reception room is a light-filled haven, thanks to large windows, and features high ceilings perfect for tranquil relaxation. The third reception room, similarly adorned with a fireplace and high ceilings, presents an inviting space for family gatherings.

The property also enjoys three double bedrooms, offering ample space for rest and relaxation. The bathroom is a spa-like retreat with a luxurious free-standing bath, perfect for unwinding after a long day.

The exterior of the home is equally impressive. The property is graced with an extensive garden that offers a perfect setting for outdoor activities and alfresco dining. The beautiful panoramic view adds to the serenity of the property, making it a true sanctuary for its inhabitants.



Accommodation

Sitting Room

12' 6" x 9' 8" (3.81m x 2.95m)

Lounge

13' 6" 13 x 13' 1" (4.11m 13 x 3.99m)

Kitchen

7' 9" x 9' 2" (2.36m x 2.79m)

Dining Room

12' 1" x 9' 9" (3.68m x 2.97m)

Bedroom 1

12' 6" x 12' 5" (3.81m x 3.78m)

Bedroom 2

12' 7" x 9' (3.84m x 2.74m)

Bedroom 3

11' 1" x 9' 5" (3.38m x 2.87m)

Agents Note

It is our understanding that the Property is not registered at the Land Registry which is the case with a significant proportion of land across England and

Wales. Your conveyancer will take the necessary steps and advise you as to time-frames for registration.

01656 736136

maesteg@peteralan.co.uk

Floorplan

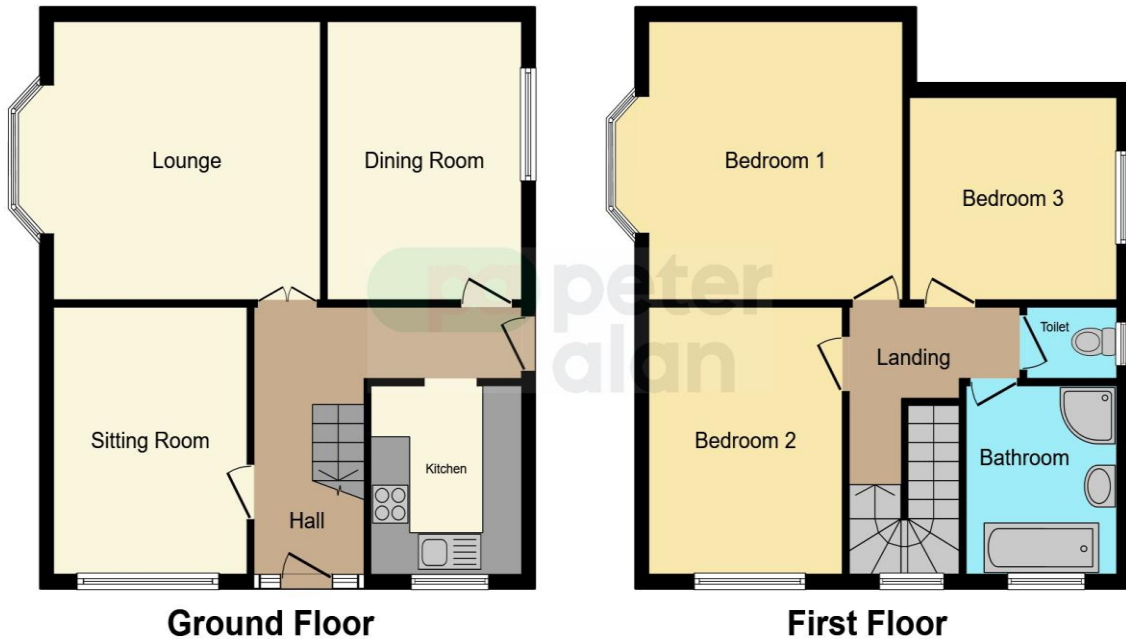

This floor plan is for illustrative purposes only. It is not drawn to scale. Any measurements, floor areas (including any total floor area), openings and orientation are approximate. No details are guaranteed, they cannot be relied upon for any purpose and they do not form part of any agreement. No liability is taken for any error, omission or misstatement. A party must rely upon its own inspection(s). Powered by www.focalagent.com



Important Information

Note while we endeavour to make our sales details accurate and reliable, if there is any point which is of particular interest to you, please contact the office and we will be pleased to confirm the position for you. We have not personally tested any apparatus, equipment, fixtures, fittings or services and cannot verify they are in working order or fit for their purposes. Nothing in these particulars is intended to indicate that carpets or curtains, furnishings or fittings, electrical goods (whether wired or not). Gas fires or light fittings or any other fixtures not expressly included form part of the property offered for sale. This computer generated Floorplan, if applicable, is intended as a general guide to the layout and design of the property. It is not to scale and should not be relied upon for dimensions. Tenure: We cannot confirm the tenure of the property as we have not had access to the legal documents. The buyer is advised to obtain verification from their solicitor or surveyor.

Peter Alan Limited is registered in England and Wales under company number 2073153, Registered Office is Cumbria House, 16-20 Hockliffe Street, Leighton Buzzard, Bedfordshire, LU7 1GN. VAT Registration Number is 500 2481 05. For activities relating to regulated mortgages and non-investment insurance contracts, Peter Alan Limited is an appointed representative of Connells Limited which is authorised and regulated by the Financial Conduct Authority. Connells Limited's Financial Services Register number is 302221. Most buy-to-let