



Queens Road, £360,000

- Council Tax - Band D
- Within walking distance to Penarth town centre
- Close to local schools
- Three Bedrooms
- Fantastic transportation links
- EPC Rating: D



 3  2  2



About the property

This substantial, three-bedroom, Victorian terraced home offers spacious accommodation for a family. Ideally located just a short distance from all the bars, amenities, shops and cafes in Penarth Town Centre.

Entered to the ground floor with access to a modern kitchen, WC and a spacious lounge/diner with pleasant views toward Cardiff Bay. To the lower ground floor are two generous bedrooms and the bathroom. To the first floor is a further bedroom with en-suite. And the sitting room. Front and rear gardens.



Accommodation

Downstairs Cloakroom

Comprising wash hand basin and W.C.

Lounge

12' 10" max x 10' 9" (3.91m max x 3.28m)

Kitchen

10' 8" x 8' 11" (3.25m x 2.72m)

Modern fitted kitchen with double oven and induction hob, fitted dishwasher, washing machine.

Top Floor

Sitting Room

16' 6" max x 12' 4" (5.03m max x 3.76m)

Full height picture window affording views over Cardiff Bay.

Entrance Hall

Entered via front entrance door from the street, doors leading to living room and kitchen.

Bedroom One

10' x 9' 11" (3.05m x 3.02m)

With two built-in wardrobes.

Ensuite Shower Room

Modern three piece suite with window to front.

Lower Ground Floor

Bedroom Two

10' 8" x 9' 8" max (3.25m x 2.95m max)

Bedroom Three

10' 7" x 9' 8" max (3.23m x 2.95m max)

Bathroom

Modern white three piece suite comprising bath with shower over, W.C. and wash hand basin.

Outside

Rear Garden

Tiered low maintenance garden with a decked seating area. Built-in storage under the decking.

Floorplan

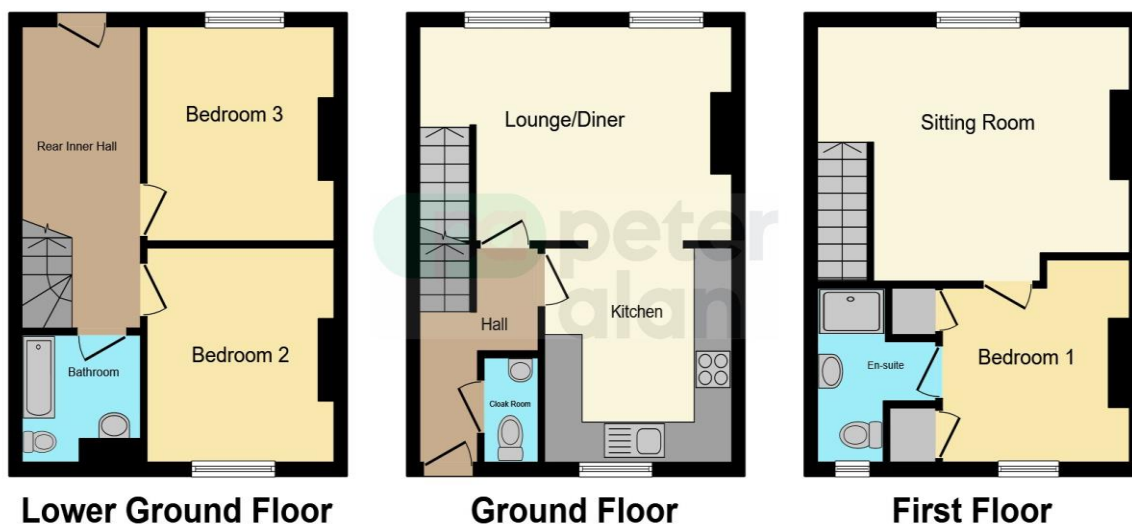

This floor plan is for illustrative purposes only. It is not drawn to scale. Any measurements, floor areas (including any total floor area), openings and orientation are approximate. No details are guaranteed, they cannot be relied upon for any purpose and they do not form part of any agreement. No liability is taken for any error, omission or misstatement. A party must rely upon its own inspection(s). Powered by www.focalagent.com

Important Information

Note while we endeavour to make our sales details accurate and reliable, if there is any point which is of particular interest to you, please contact the office and we will be pleased to confirm the position for you. We have not personally tested any apparatus, equipment, fixtures, fittings or services and cannot verify they are in working order or fit for their purposes. Nothing in these particulars is intended to indicate that carpets or curtains, furnishings or fittings, electrical goods (whether wired or not). Gas fires or light fittings or any other fixtures not expressly included form part of the property offered for sale. This computer generated Floorplan, if applicable, is intended as a general guide to the layout and design of the property. It is not to scale and should not be relied upon for dimensions. Tenure: We cannot confirm the tenure of the property as we have not had access to the legal documents. The buyer is advised to obtain verification from their solicitor or surveyor.

Peter Alan Limited is registered in England and Wales under company number 2073153, Registered Office is Cumbria House, 16-20 Hockliffe Street, Leighton Buzzard, Bedfordshire, LU7 1GN. VAT Registration Number is 500 2481 05. For activities relating to regulated mortgages and non-investment insurance contracts, Peter Alan Limited is an appointed representative of Connells Limited which is authorised and regulated by the Financial Conduct Authority. Connells Limited's Financial Services Register number is 302221. Most buy-to-let