



Whitstable Road, CT2
Canterbury |

 Sandersons



Whitstable Road, CT2

CT2 8DG

£1,900 pcm

To Let

Academic year 2021/2022 - £1,900pcm without bills or £2,400pcm including bills - 5 bedroom student house in a great location for UKC students - 4 double bedrooms and 1 single bedroom - 2 bathrooms

- £1,900pcm without bills or £2,400pcm including bills
- 4 double bedrooms and 1 single bedroom
- 2 bathrooms
- 1.2 miles to UKC
- Security deposit £200 per person



The Property

Academic year 2021/2022. This five bedroom student property is in an ideal location for UKC students. The first bedroom is located on the ground floor, a spacious room with a large bay window. There is a bright living room which opens out into a conservatory. The kitchen comes with an electric oven and hob, a fridge freezer, a washing machine and access into the garden. To the back of the property there is another large bedroom and a small bathroom with a shower unit. Upstairs are two double sized bedrooms and a good sized bathroom. The fifth bedroom is an attic conversion with views over the city. There is permit parking available in the immediate area,

Location

Whitstable Road is located next to the Elliott Footpath and is ideal for UKC students. There is a Sainsbury's Local and other amenities in St Dunstons which is 0.5 miles away. Central Canterbury has a wide variety of retail shops, restaurants, bars and pubs. There is a local gymnasium at Kingsmead Leisure Centre and Canterbury West Station has high speed links to London St Pancras.

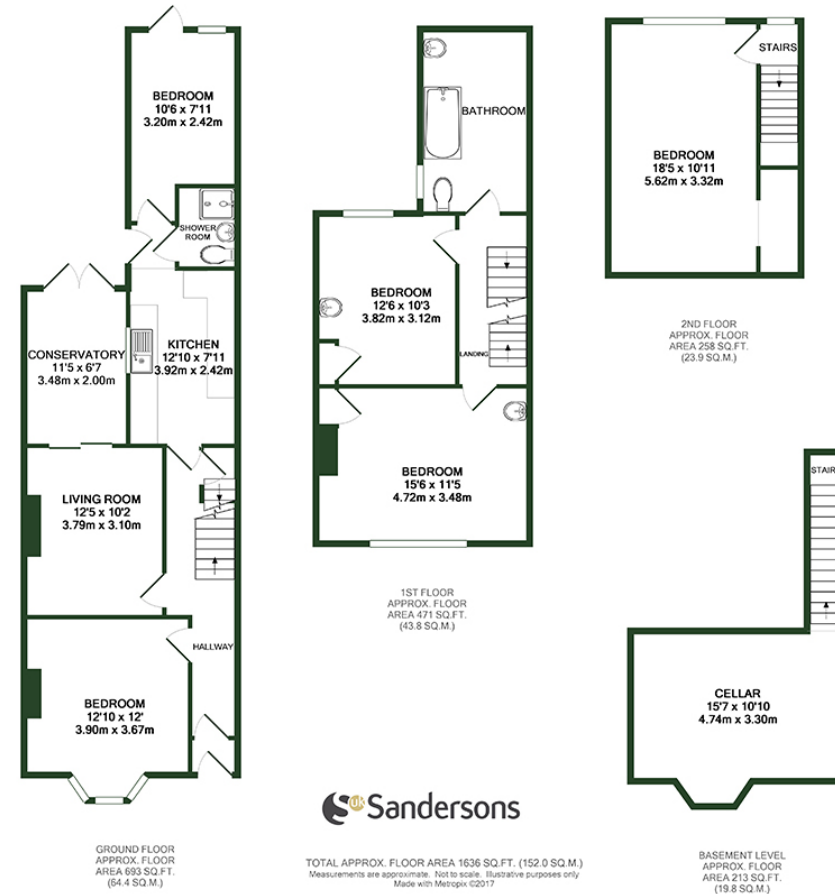

Viewing strictly by appointment through Sandersons UK

Canterbury branch
01227 784 784

canterbury@sandersonsuk.com
26a Castle Street
Canterbury
Kent
CT1 2QD



www.sandersonsuk.com
twitter.com/sandersonsuk
facebook.com/sandersonsuk

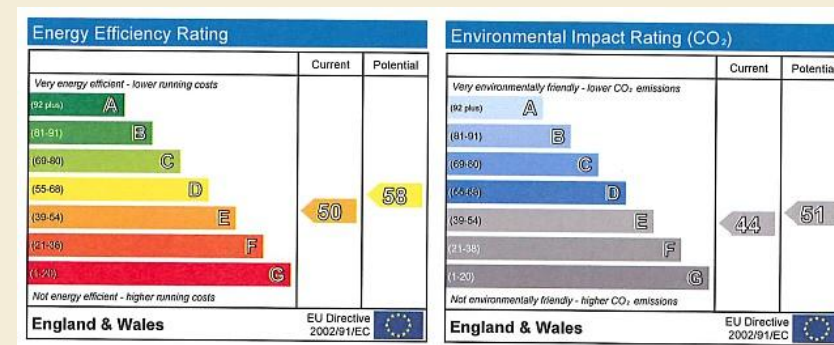

IMPORTANT NOTICE Sandersons UK for themselves and for the Vendors of this property, whose agents they are, give notice that:

1. The particulars are intended to give a fair and substantially correct overall description for the guidance of intending purchasers and do not constitute part of an offer or contract. Prospective purchasers and lessees ought to seek their own professional advice.
2. All descriptions, dimensions, areas, reference to condition and necessary permissions for use and occupation and other details are given in good faith, and are believed to be correct, but any intending purchasers should not rely on them as statements or representations of fact, but must satisfy themselves by inspection or otherwise as to the correctness of each of them.
3. No person in the employment of Sandersons UK has any authority to make or give any representations or warranty whatever in relation to this property on behalf of Sandersons UK, nor enter into any contract on behalf of the Vendor.
4. No responsibility can be accepted for any expenses incurred by intending purchasers in inspecting properties which have been sold, let or withdrawn. All measurements are approximate.