



SAMUEL WOOD

3 Chapel Row, Ludlow, SY8 2NL

£750 Per Month



3 Chapel Row

Ludlow, SY8 2NL



- Attractive terrace cottage
- Living room with wood burner
- Double bedroom
- Storage space in loft
- Large front garden
- Spacious first floor landing
- Bathroom with shower over bath

MANAGED BY SAMUEL WOOD. Charming one-bedroom cottage with wood burner, loft room, modern kitchen and bathroom, plus a large front garden with artificial lawn.

This characterful one-bedroom terrace cottage has been freshly painted throughout and benefits from some new floor coverings. The living room features a parquet floor and wood-burning stove, while the fitted kitchen offers useful cupboard space and room for appliances.

On the first floor, a generous landing provides space for a desk or reading area, alongside a double bedroom and modern bathroom. There is an extra storage space in the loft room. Please note this room can only be used for storage and cannot be used as a bedroom/office or similar

The property enjoys a front garden divided by a pathway, with a sitting area immediately outside the door and a larger enclosed garden beyond. The main garden is of good size and laid with artificial grass, providing a low-maintenance outdoor space.

Chapel Row is set within a mature residential area, convenient for local amenities and transport links.







Directions

Available on a min 12 months tenancy
Unfurnished.
No smoking/vaping.
No Pets.
EPC - C
Council Tax Band – A
Utilities (mains gas, mains electric, mains water, mains drainage)
Parking situation – on street parking





Floor Plans

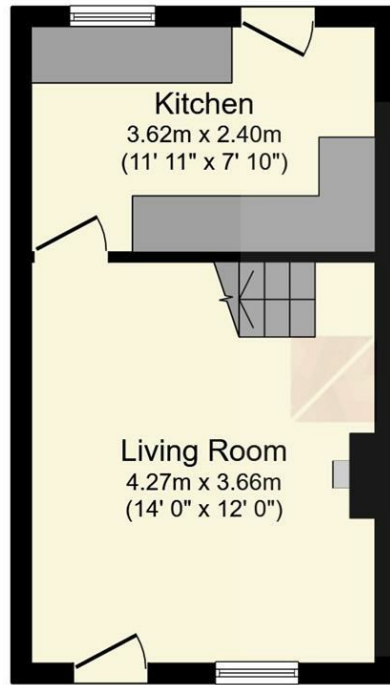

Ground Floor
Floor area 24.8 sq.m. (267 sq.ft.)

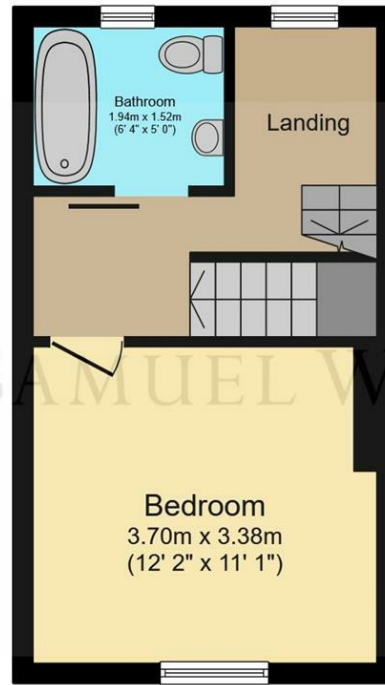

First Floor
Floor area 24.8 sq.m. (267 sq.ft.)



Second Floor
Floor area 12.3 sq.m. (133 sq.ft.)

Total floor area: 61.9 sq.m. (666 sq.ft.)

This floor plan is for illustrative purposes only. It is not drawn to scale. Any measurements, floor areas (including any total floor area), openings and orientations are approximate. No details are guaranteed, they cannot be relied upon for any purpose and do not form any part of any agreement. No liability is taken for any error, omission or misstatement. A party must rely upon its own inspection(s). Powered by www.Propertybox.io

We take every care in preparing our sales details. They are checked and usually verified by the Vendor. We do not guarantee appliances, alarms, electrical fittings, plumbing, showers etc. You must satisfy yourself that they operate correctly. Room sizes are approximate; they are usually taken in metric and converted to imperial. Do not use them to buy carpets or furniture. We cannot verify the tenure, as we do not have access to the legal title; we cannot guarantee boundaries or rights of way so you must take the advice of your legal representative. No person in the employment of or representing Samuel Wood has any authority to make any representation or warranty whatever in relation to this property. If there is any point which is of particular importance to you, please contact the office and we will be pleased to check the information. Do so particularly if contemplating travelling some distance to view. Applicants are advised that the majority of our shots are taken with a wide angle lens.

CONTEMPORARY AGENCY • TRADITIONAL VALUES
2 Shoplatch, Shrewsbury, Shropshire, SY1 1HF
Tel: 01743 272710 | shrewsbury@samuelwood.co.uk