



# SAMUEL WOOD



## Flat 1, Tamberlane House Church Street

Ludlow, Shropshire, SY8 1AP

£800 Per Month



Positioned on the first floor of the historic Tamberlane House, this newly refurbished one bedroom apartment offers a chance to reside in a prime location in Ludlow Town Centre.



CONTEMPORARY AGENCY • TRADITIONAL VALUES

propertymark

MAYFAIR  
OFFICE.CO.UK

rightmove

OnTheMarket.com



Set in the heart of the historical Ludlow Town Centre, this beautifully refurbished property is the perfect display of old meets new, with parts of the property dating back to the 1620's.

Accessed via a shared entrance hall, from the first floor the property consists of: entrance hall, kitchen, living room, bedroom and shower room.

This apartment is one of only two properties in the building.

Viewing highly recommended.

## Area Map



## Floor Plans

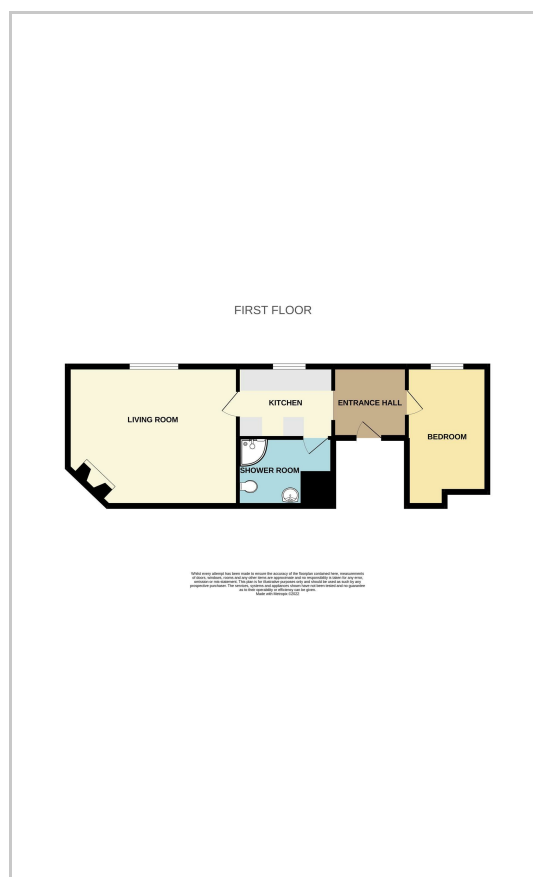

We take every care in preparing our sales details. They are checked and usually verified by the Vendor. We do not guarantee appliances, alarms, electrical fittings, plumbing, showers etc. You must satisfy yourself that they operate correctly. Room sizes are approximate; they are usually taken in metric and converted to imperial. Do not use them to buy carpets or furniture. We cannot verify the tenure, as we do not have access to the legal title; we cannot guarantee boundaries or rights of way so you must take the advice of your legal representative. No person in the employment of or representing Samuel Wood has any authority to make any representation or warranty whatever in relation to this property. If there is any point which is of particular importance to you, please contact the office and we will be pleased to check the information. Do so particularly if contemplating travelling some distance to view. Applicants are advised that the majority of our shots are taken with a wide angle lens.

2 Shoplatch, Shrewsbury, Shropshire, SY1 1HF  
Tel: 01743 272710 | shrewsbury@samuelwood.co.uk

[www.samuelwood.co.uk](http://www.samuelwood.co.uk)