



## 57793e Westminster Road, Selly Oak, Birmingham, B29 7RS

### £1,716 Per Calendar Month

 4 
  2 
  1 
  D

2025/2026 ACADEMIC YEAR Spacious Student Accommodation Suitable for both Students and Professionals

15 -20 minutes' walk to South Gate of Campus  
 8-10 minutes' walk to mainline train service run from Selly Oak and Bristol Road  
 4 minutes' to local shops  
 4 Double Bedroom  
 Fully Furnished  
 Recently redecorated and refurbished.  
 Well-equipped Kitchen  
 Comfortable Living Space  
 Two modern bathroom.  
 Gas Central Heating  
 Security Alarm  
 LOW DEPOSIT: £400/person (based on a group of 4 people)  
 Available: Rent with Built-in Unlimited Bills Package for only £128.90 per person per week

Explore this newly refurbished 4 double bedroom student house on Westminster Road, Selly Oak. Situated in a prime location, it's just an 8-10 minute walk to train services, Bristol Road shopping, and various dining options. The property features modern amenities, including a well-equipped kitchen, comfortable living space, and gas central heating, making it a convenient and cozy choice for students.

Don't miss your chance to view this exceptional property. Schedule a viewing by appointment only with Mason Knight. Your dream home in Selly Oak awaits!

### Viewing

Please contact our MasonKnight Properties Office on 0121 472 5897 if you wish to arrange a viewing appointment for this property or require further information.



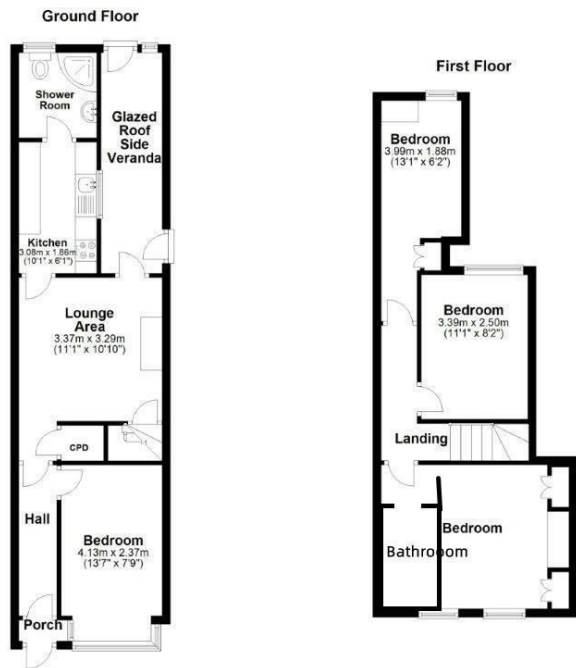

Energy Efficiency Rating			Environmental Impact (CO <sub>2</sub> ) Rating		
	Current	Potential		Current	Potential
Very energy efficient - lower running costs			Very environmentally friendly - lower CO <sub>2</sub> emissions		
(92 plus) <b>A</b>			(92 plus) <b>A</b>		
(81-91) <b>B</b>			(81-91) <b>B</b>		
(69-80) <b>C</b>			(69-80) <b>C</b>		
(55-68) <b>D</b>			(55-68) <b>D</b>		
(38-54) <b>E</b>			(38-54) <b>E</b>		
(21-38) <b>F</b>			(21-38) <b>F</b>		
(1-20) <b>G</b>			(1-20) <b>G</b>		
Not energy efficient - higher running costs			Not environmentally friendly - higher CO <sub>2</sub> emissions		
<b>England &amp; Wales</b>			<b>England &amp; Wales</b>		
EU Directive 2002/91/EC			EU Directive 2002/91/EC		



These particulars, whilst believed to be accurate are set out as a general outline only for guidance and do not constitute any part of an offer or contract. Intending purchasers should not rely on them as statements of representation of fact, but must satisfy themselves by inspection or otherwise as to their accuracy. No person in this firm's employment has the authority to make or give any representation or warranty in respect of the property.