



Central St. Giles Piazza

London, WC2H

£4,000 per month
(£923.08 per week)

A contemporary 2 bedroom property found on the 6th floor of the desirable Central St.Giles development with 24hr concierge. Flooded with natural light the apartment boasts an open plan kitchen reception room leading onto the private winter garden.

CHESTERTONS



Central St. Giles Piazza

London, WC2H

- Private winter garden
- wooden flooring
- lift access
- 24hr concierge



A contemporary 2 bedroom property found on the 6th floor of the desirable Central St.Giles development with 24hr concierge. Flooded with natural light the apartment boasts an openplan kitchen reception room leading onto the private winter garden.

The apartment benefits from oak flooring, floor-to-ceiling windows, and offers bright and very well appointed accommodation with ample storage, 2 bedrooms and shower room.

Ideally situated for the delights of the West End and close proximity to Tottenham Court Road Station providing access to Central and Northern Lines.

Minimum Term: months
Deposit Required: £4,615.38
Local Authority: Camden
Council Tax Band: F
EPC Rating: B
Part Furnished

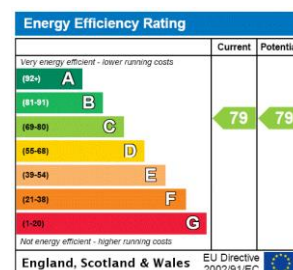

Chestertons Covent Garden Lettings

196 Shaftesbury Avenue
 Covent Garden
 London
 WC2H 8JF
coventgardenlettingsusers@chestertons.co.uk
 02030408400
chestertons.co.uk

Additional tenant charges apply (fees apply to non-AST tenancies only)
 Tenancy Agreement Fee: £300
 References per Tenant/Guarantor: £60
 Inventory check (approx. £100 – £250 inc. VAT)
chestertons.co.uk/property-to-rent/applicable-fees

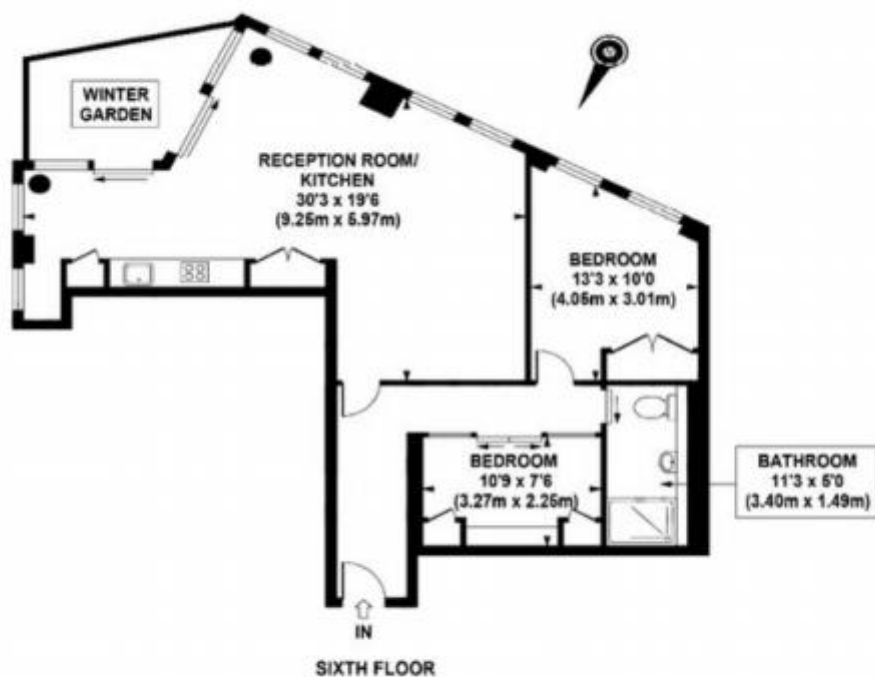

APPROX. GROSS INTERNAL AREA 848 sq.ft / 78.81 sq.m

