



# Bedford Court Mansions

Adeline Place, WC1B

£4,766.67 per month  
(£1,100 per week)

Impressive 3 bedroom apartment found in a desirable period mansion in the heart of Bloomsbury. Comprising of 3 double bedrooms with 2 bathrooms (one en-suite shower room) spacious eat-in Kitchen and large reception room with stylish wooden flooring.



# Bedford Court Mansions

Adeline Place, WC1B

-

HMO max. 3 occupiers allowed - Impressive 3 bedroom apartment found in a desirable period mansion in the heart of Bloomsbury.

Comprising of 3 double bedrooms with 2 bathrooms (one en-suite shower room) spacious eat-in Kitchen and large reception room with stylish wooden flooring.

**Minimum Term:** 12 months  
**Deposit Required:** £5,500.00  
**Local Authority:** London Borough Of Camden  
**Council Tax Band:** G  
**EPC Rating:** C  
**Furnished**

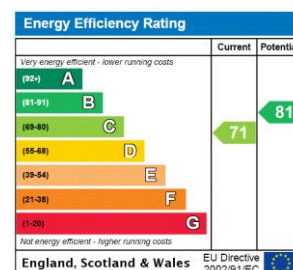

### *Chestertons Covent Garden Lettings*

196 Shaftesbury Avenue  
Covent Garden  
London  
WC2H 8JF  
coventgardenlettingsusers@chestertons.co.uk  
02030408400  
chestertons.co.uk

Additional tenant charges apply (fees apply to non-AST tenancies only)  
Tenancy Agreement Fee: £300  
References per Tenant/Guarantor: £60  
Inventory check (approx. £100 – £250 inc. VAT)  
chestertons.co.uk/property-to-rent/applicable-fees

# Bedford Court Mansions

Approximate Gross Internal Area = 142 sq m / 1528 sq ft

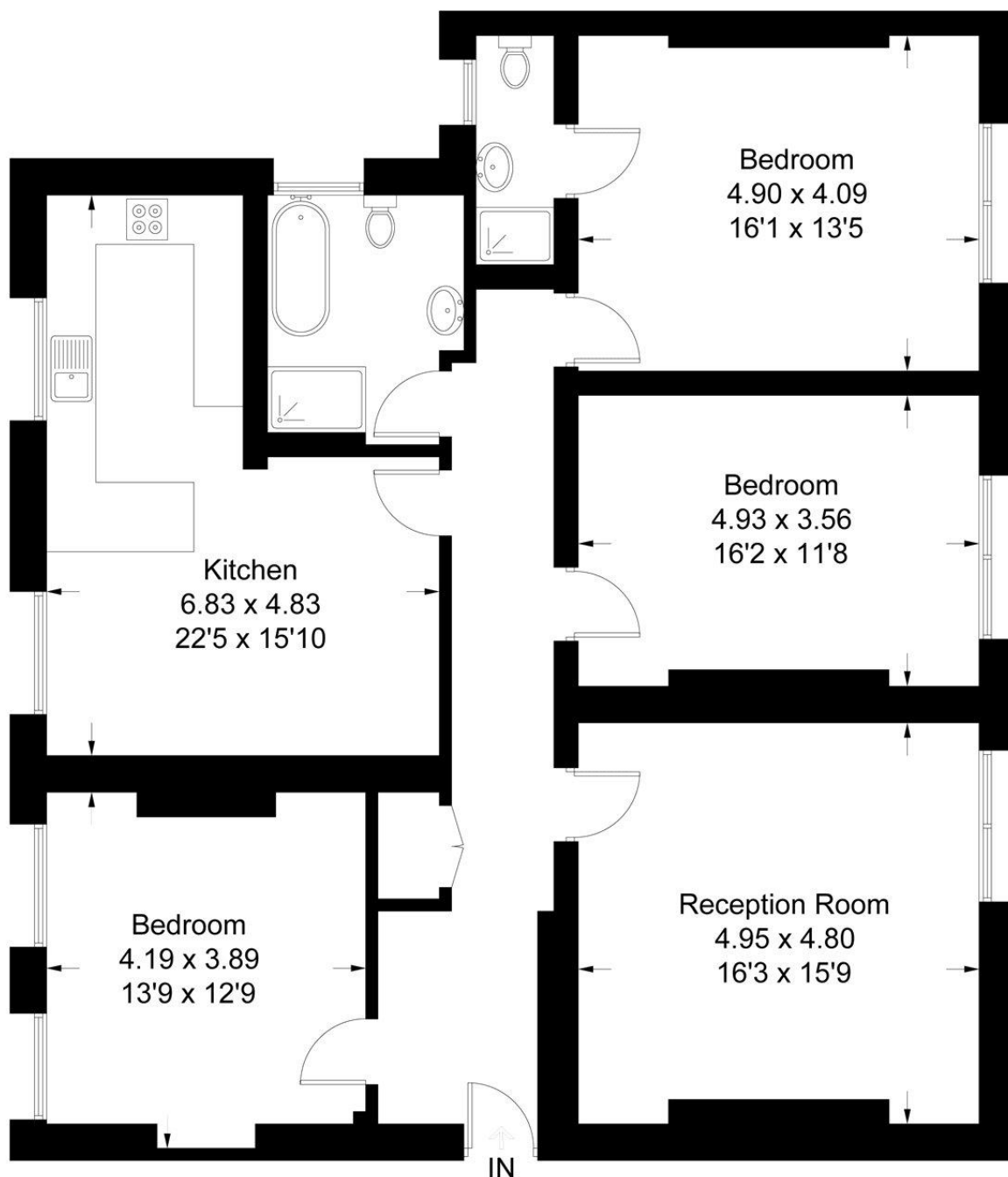

## Lower Ground Floor

This plan is for layout guidance only. Not drawn to scale unless stated. Windows and door openings are approximate. Whilst every care is taken in the preparation of this plan, please check all dimensions, shapes and compass bearings before making any decisions reliant upon them. (ID260337)

