



# Ridgmount Street

Bloomsbury, WC1E

£3,900 per month  
(£900 per week)

This top floor interior designed apartment benefits from air conditioning, wooden flooring, excellent storage, flat screen TVs. Conveniently located for the delights of Fitzrovia & Store Street with access to private gardens.

**CHESTERTONS**



# Ridgmount Street

## Bloomsbury, WC1E

- Brand newly refurbished
- Air conditioning
- High specification finish
- 2 double bedrooms
- Wooden flooring



This top floor interior designed apartment benefits from air conditioning, wooden flooring, excellent storage, flat screen TVs. Conveniently located for the delights of Fitzrovia & Store Street with access to private gardens.

Comprising of a large reception open plan to the kitchen with a dining area, 2 double bedrooms, bathroom with bath tub and separate shower cubicle.

**Minimum Term:** months  
**Deposit Required:** £5,400.00  
**Local Authority:** Camden  
**Council Tax Band:** F  
**EPC Rating:** C  
**Furnished**

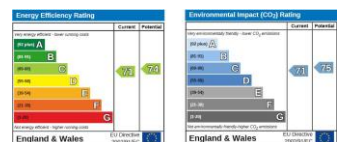

### *Chestertons Covent Garden Lettings*

196 Shaftesbury Avenue  
 Covent Garden  
 London  
 WC2H 8JF  
[coventgardenlettingsusers@chestertons.co.uk](mailto:coventgardenlettingsusers@chestertons.co.uk)  
 02030408400  
[chestertons.co.uk](http://chestertons.co.uk)

Additional tenant charges apply (fees apply to non-AST tenancies only)  
 Tenancy Agreement Fee: £300  
 References per Tenant/Guarantor: £60  
 Inventory check (approx. £100 – £250 inc. VAT)  
[chestertons.co.uk/property-to-rent/applicable-fees](http://chestertons.co.uk/property-to-rent/applicable-fees)

## Ridgmont Street

Approximate Gross Internal Area = 820 sq ft / 76.2 sq m

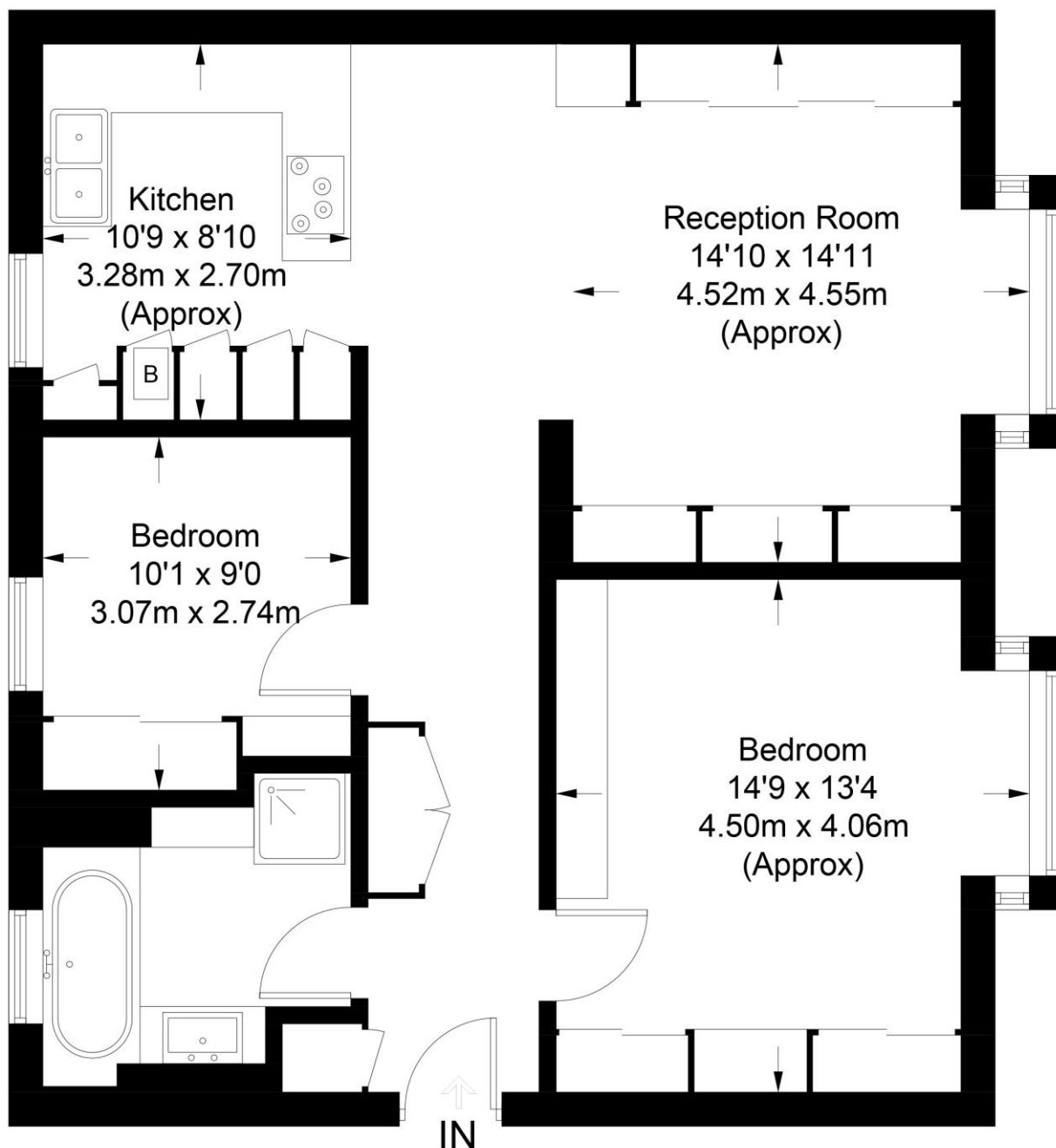

## Second Floor

Not to scale, for guidance only and must not be relied upon as a statement of fact.  
All measurements and areas are approximate only and have been prepared in  
accordance with the current edition of the RICS Code of Measuring Practice.

