



Rosebery Court

Clerkenwell, EC1R

£2,860 per month
(£660 per week)

A bright and well-presented two bedroom apartment situated on the third floor of this modern purpose built development close to Farringdon Station.

CHESTERTONS



Rosebery Court

Clerkenwell, EC1R

- • Two Bedroom apartment
- • Bright Living Area
- • Balcony
- • Separate Kitchen



This fantastic two bedroom apartment benefits from a very central location on Roseberry Avenue. The apartment comprises of large reception room with large windows opening onto a light and bright balcony, separate fully fitted kitchen, two separate double bedrooms, and family bathroom.

Rosebery Court is well located on Roseberry Avenue on the Clerkenwell-Bloomsbury border, within walking distance of Farringdon, Kings Cross St Pancras International and Angel tube stations and very close to Exmouth Market, Sadler's Wells Theatre and the array of restaurants, bistros and cafes in Clerkenwell Road and St John Street. This location is ideal for an easy commute both

Minimum Term: 12 months
Deposit Required: £3,300.00
Local Authority: Islington
Council Tax Band: E
EPC Rating: D
Unfurnished

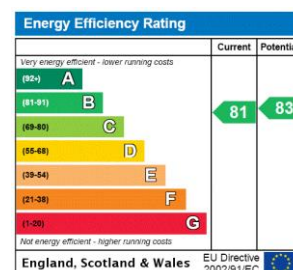

Chestertons Covent Garden Lettings

196 Shaftesbury Avenue
 Covent Garden
 London
 WC2H 8JF
coventgardenlettingsusers@chestertons.co.uk
 02030408400
chestertons.co.uk

Additional tenant charges apply (fees apply to non-AST tenancies only)
 Tenancy Agreement Fee: £300
 References per Tenant/Guarantor: £60
 Inventory check (approx. £100 – £250 inc. VAT)
chestertons.co.uk/property-to-rent/applicable-fees

Rosebery Court, EC1R

Approx. Gross Internal Area 653 Sq Ft - 60.66 Sq M
Approx. Gross Balcony Area 45 Sq Ft - 4.18 Sq M

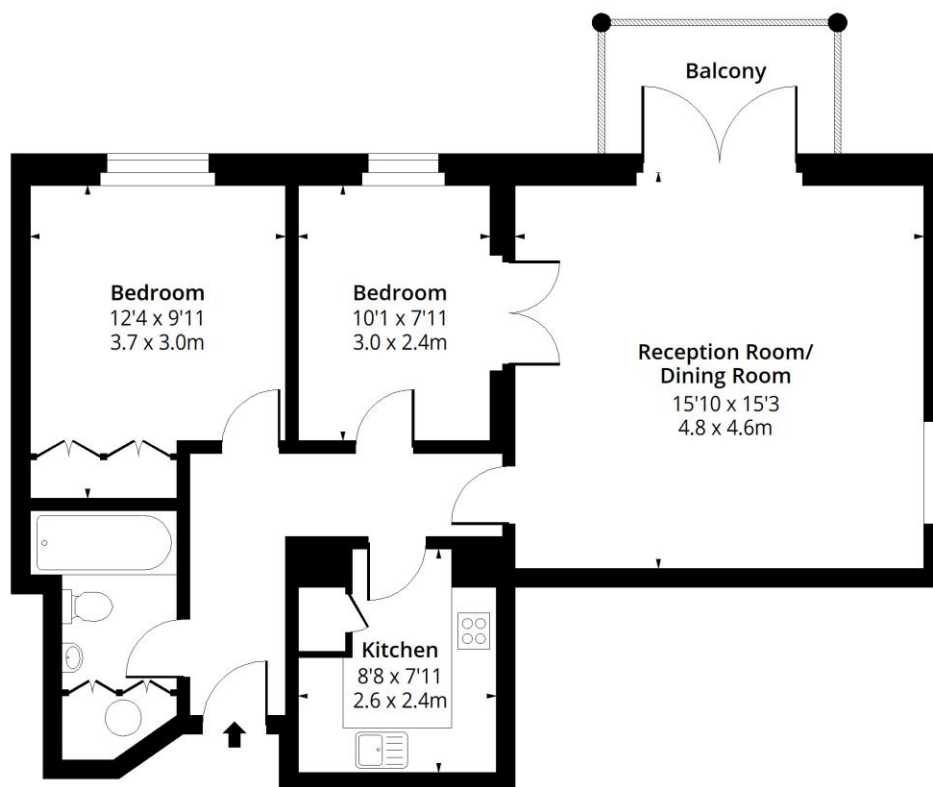

Third Floor

Floor Area 653 Sq Ft - 60.66 Sq M



**Certified
Property
Measurer**

Measured according to RICS IPMS2. Floor plan is for illustrative purposes only and is not to scale. Every attempt has been made to ensure the accuracy of the floor plan shown, however all measurements, fixtures, fittings and data shown are an approximate interpretation for illustrative purposes only. 1 sq m = 10.76 sq feet.

[lpalplus.com](https://www.lpalplus.com)

Date: 7/6/2023



This paper is
100% recyclable