



Bristol House

Southampton Row, WC1B

£2,903.33 per month
(£670 per week)

A stylish apartment set in desirable mansion block located only moments from Bloomsbury Square. The property benefits from exposed brickwork, beautiful parquet flooring and access to a private patio.

VIDEO VIEWING AVAILABLE



Bristol House

Southampton Row, WC1B

- Exposed brickwork
- Parquet flooring
- High ceilings
- Private patio garden
- Excellent location



A stylish one bedroom apartment set in a desirable mansion block located moments from Bloomsbury Square. The property comprises; reception room which is semi open plan to an eat-in kitchen and also has direct access to a large private patio garden, a large double bedroom and a bathroom.

The property further benefits from high ceilings, exposed brickwork, feature fireplaces and beautiful parquet flooring as well as a utility cupboard. Finished to a high standard and conveniently located for the delights of the West End with access to Bedford Square.

Minimum Term: months
Deposit Required: £3,350.00
Local Authority: London Borough Of Camden
Council Tax Band: E
EPC Rating: C
Furnished

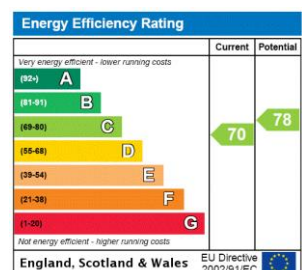

Chestertons Covent Garden Lettings

196 Shaftesbury Avenue
 Covent Garden
 London
 WC2H 8JF
 coventgarden@chestertons.co.uk
 02030408400
 chestertons.co.uk

Additional tenant charges apply (fees apply to non-AST tenancies only)
 Tenancy Agreement Fee: £300
 References per Tenant/Guarantor: £60
 Inventory check (approx. £100 – £250 inc. VAT)
 chestertons.co.uk/property-to-rent/applicable-fees

Bristol House, Southampton Row



 - Ceiling Height

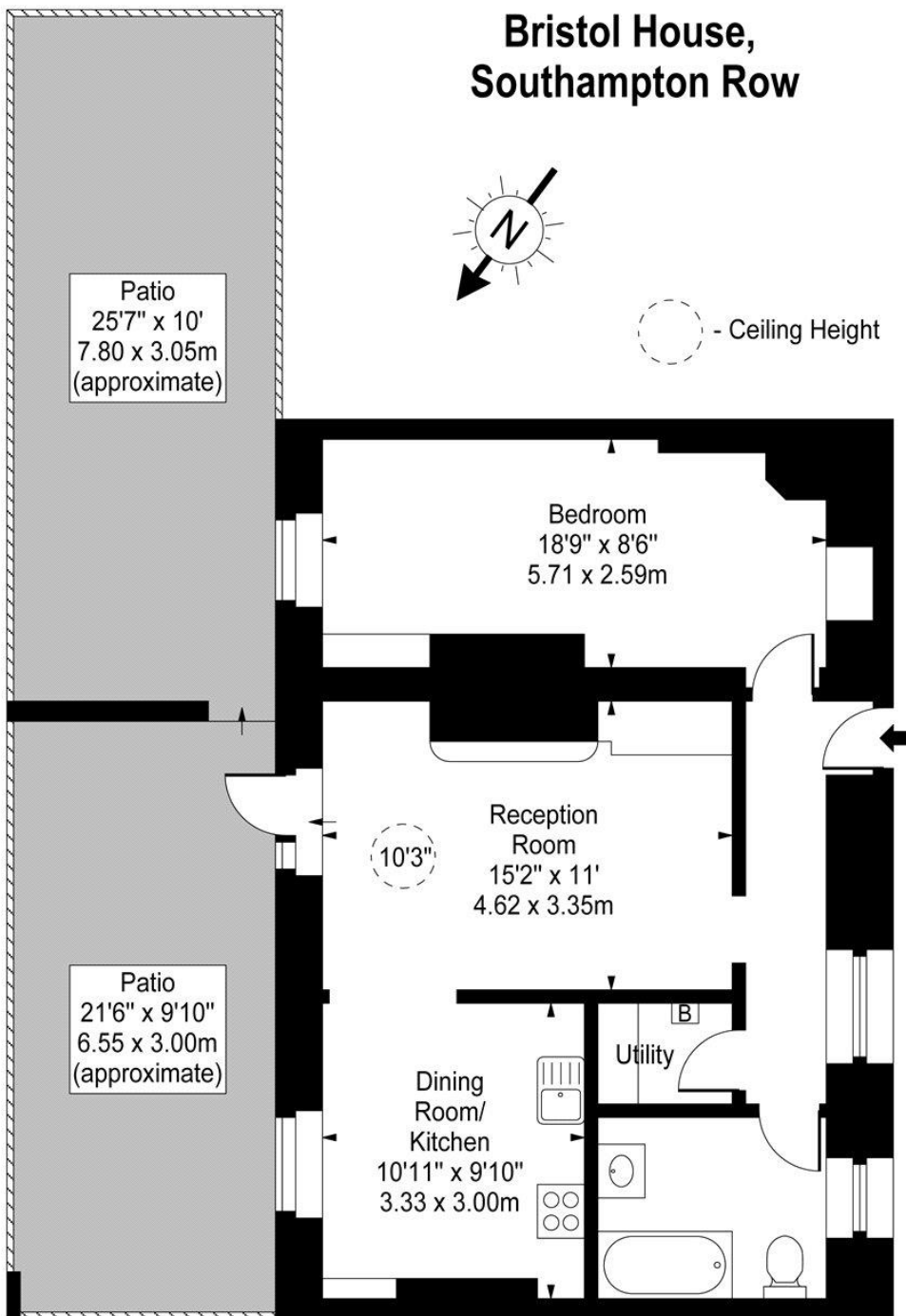

Lower Ground Floor

Approx Gross Internal Area **608 Sq Ft - 56.48 Sq M**

For Illustration Purposes Only - Not To Scale

www.goldlens.co.uk

Ref. No. 009689M

