



# Shaftesbury Avenue

London, WC2H

£2,600 per month  
(£600 per week)

Bright one bedroom situated on an iconic Covent Garden street. Comprising separate galley style kitchen, spacious reception room, double bedroom with excellent storage and bathroom. Finished to high standard throughout. VIDEO VIEWING AVAILABLE.

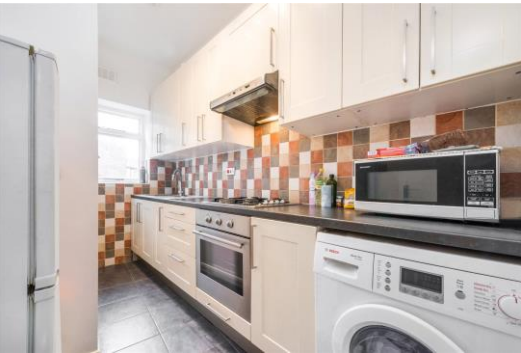

# Shaftesbury Avenue

London, WC2H

- Wooden flooring throughout
- Prime location



Bright one bedroom situated on an iconic Covent Garden street. Comprising separate galley style kitchen, spacious reception room, double bedroom with excellent storage and bathroom. Finished to high standard throughout. VIDEO VIEWING AVAILABLE.

Conveniently located for the delights of the West End and close proximately to Covent Garden and Tottenham Court Road tube stations providing access to Central, Northern and Piccadilly lines.

**Minimum Term:** 6 months  
**Deposit Required:** £0.00  
**Local Authority:** London Borough Of Camden  
**Council Tax Band:** D  
**EPC Rating:** C  
**Furnished**

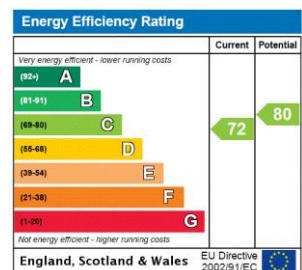

### Chestertons Covent Garden Lettings

196 Shaftesbury Avenue  
 Covent Garden  
 London  
 WC2H 8JF  
 coventgarden@chestertons.co.uk  
 02030408400  
 chestertons.co.uk

Additional tenant charges apply (fees apply to non-AST tenancies only)  
 Tenancy Agreement Fee: £300  
 References per Tenant/Guarantor: £60  
 Inventory check (approx. £100 – £250 inc. VAT)  
 chestertons.co.uk/property-to-rent/applicable-fees

# Shaftesbury Avenue

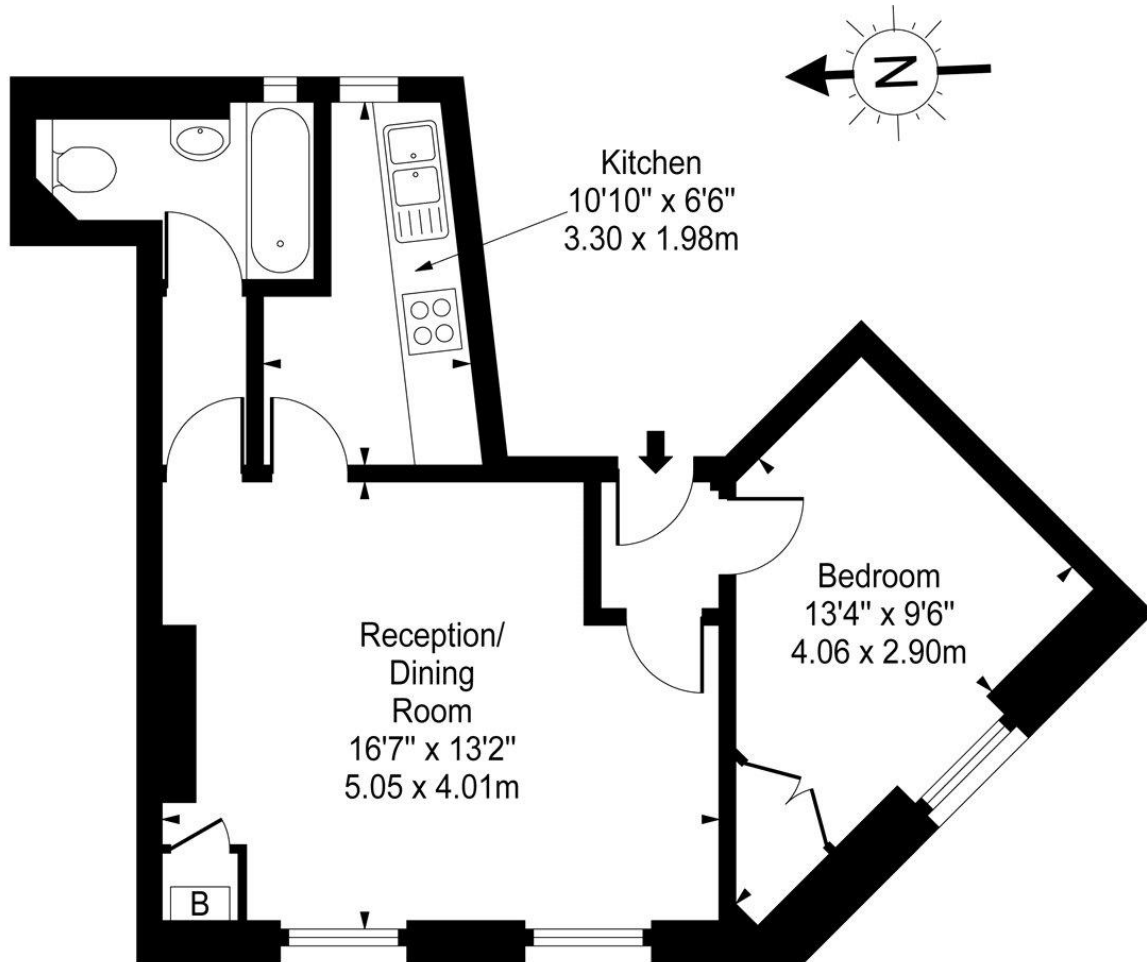

Second Floor

Approx Gross Internal Area **435 Sq Ft - 40.41 Sq M**

For Illustration Purposes Only - Not To Scale

[www.goldlens.co.uk](http://www.goldlens.co.uk)

Ref. No. 008395M

