



Stirling Court

Tavistock Street, WC2E

£2,751.67 per month
(£635 per week)

1 BEDROOM APARTMENT found within this purpose built development located behind The Strand and a short walk for Covent Garden Piazza. Comprising reception, separate eat-in kitchen, double bedroom & bathroom.



Stirling Court

Tavistock Street, WC2E

- Short Let
- 1 Bedroom
- All Bills Included
- Nearest Tube: Covent Garden & Charing Cross

A NEWLY REFURBISHED 1 BEDROOM APARTMENT found within this purpose built development located behind The Strand and a short walk for the Covent Garden Piazza. Comprising reception, separate eat-in kitchen, double bedroom & bathroom.

Minimum Term: 12 months
Deposit Required: £3,175.00
Local Authority: Westminster City Council
Council Tax Band: D
EPC Rating: D
Furnished

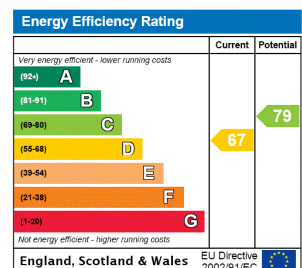

Chestertons Covent Garden Lettings

196 Shaftesbury Avenue
 Covent Garden
 London
 WC2H 8JF
 coventgarden@chestertons.co.uk
 02030408400
 chestertons.co.uk

Additional tenant charges apply (fees apply to non-AST tenancies only)
 Tenancy Agreement Fee: £300
 References per Tenant/Guarantor: £60
 Inventory check (approx. £100 – £250 inc. VAT)
chestertons.co.uk/property-to-rent/applicable-fees

Sterling Court, Tavistock , WC2
Approx. Gross Internal Area 459 Sq Ft - 42.66 Sq M

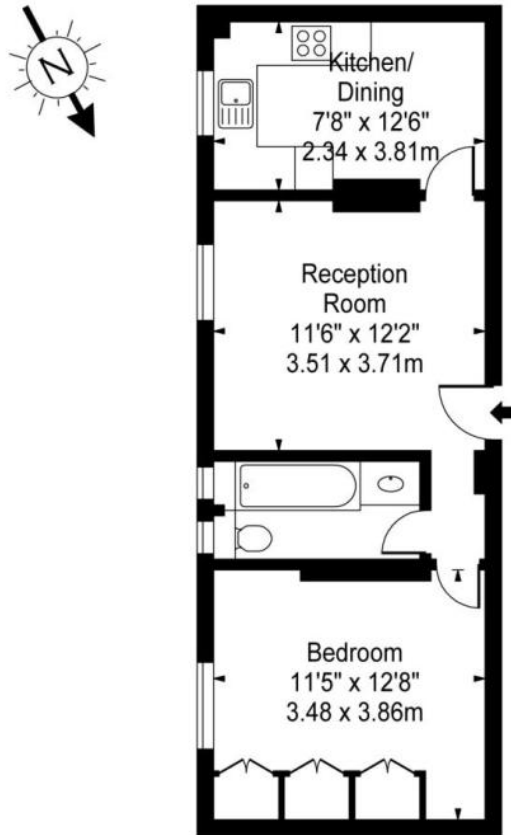

Ground Floor

For Illustration Purposes Only - Not To Scale Floor Plan by www.pixandplans.com Ref: No.6012

This floor plan should be used as a general outline for guidance only and do not constitute in whole or in part an offer or contract. Any intending purchaser or lessee should satisfy themselves by inspection, searches, enquiries and full survey as to the correctness of each statement. Any areas, measurements or distances quoted are approximate and should not be used to value a property or be the basis of any sale or let.