



Rashleigh House

Thanet Street, WC1H

£500 per week
(£2,166.67 pcm)

Perfect for sharers, this 2/3 bedroom apartment boast a separate reception room which can be converted into a 3rd bedroom. Situated on the upper floor of this purpose built mansion block within close proximity to Russell Square.

CHESTERTONS

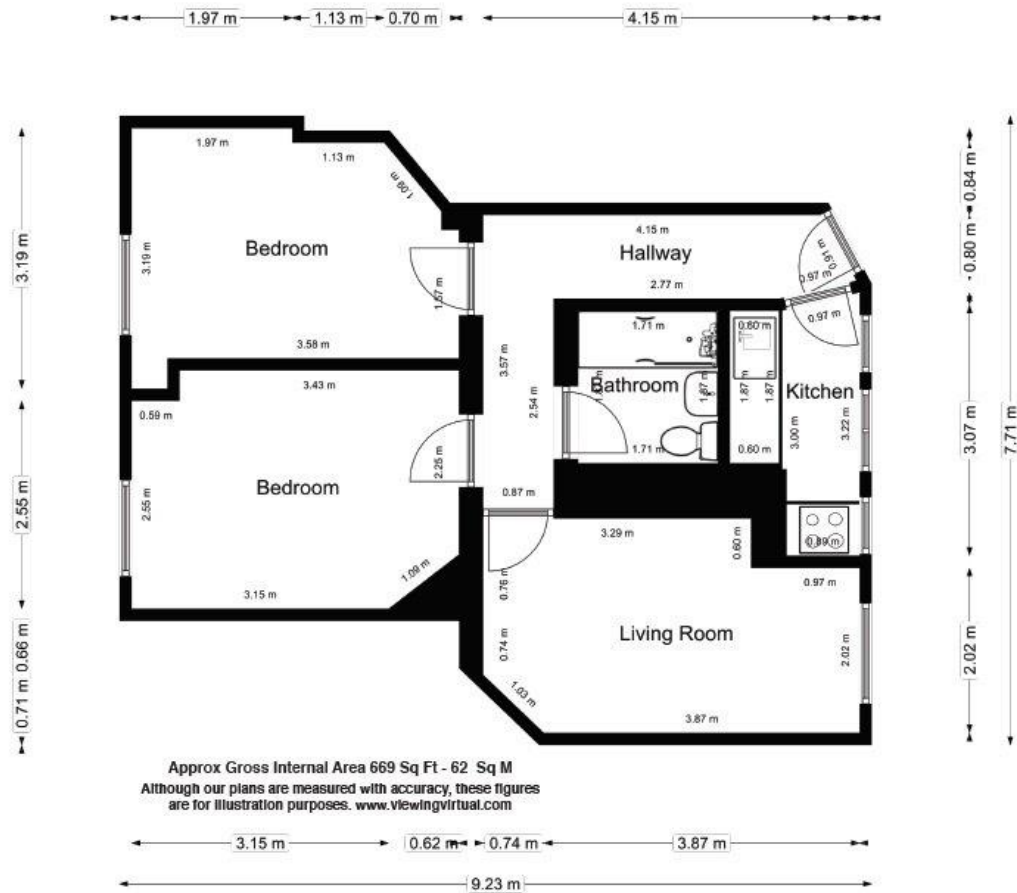

Tenure: Long Let

Furnished

Additional tenant charges apply (fees apply to non-AST tenancies only)

Tenancy Agreement Fee: £300

References per Tenant/Guarantor: £60

Inventory check (approx. £100 – £250 inc. VAT)

chestertons.com/property-to-rent/applicable-fees

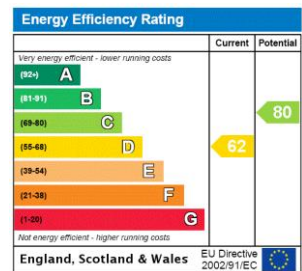

Chestertons Covent Garden Lettings

196 Shaftesbury Avenue

Covent Garden

London

WC2H 8JF

lettings.coventgarden@chestertons.com

02030408400

Chesterton Global Ltd trading as Chestertons for themselves and for the vendor of this property whose agents they are, give notice that (i) these particulars do not constitute any part of an offer or contract, (ii) all statements contained within these particulars are made without responsibility on the part of Chestertons or the vendor, (iii) whilst made in good faith, none of the statements contained within these particulars are to be relied upon as a statement or representation of fact, (iv) any intending purchasers must satisfy themselves by inspection or otherwise as to the correctness of each of the statements contained within these particulars, (v) the vendor does not make or give either Chestertons or any person in their employment any authority to make or give representation or warranty whatsoever in relation to this property. Wide angle lenses may be used. ©Copyright Chestertons | Chesterton Global Ltd | Registered Office 40 Connaught Street, Hyde Park, London W2 2AB Registered Company Number 05334580.



This paper is 100% recyclable