



Carlton Mansions
182 Shaftesbury Avenue, WC2H

CHESTERTONS





2 double bedroom apartment in the heart of Covent Garden.

- **£850 per week (£3,683.33 pcm)**
Additional tenant charges apply (fees apply to non-AST tenancies only)
Tenancy Agreement Fee: £300
References per Tenant/Guarantor: £60
Inventory check (approx. £100 – £250 inc. VAT)
[chestertons.com/property-to-rent/applicable-fees](https://www.chestertons.com/property-to-rent/applicable-fees)

Minimum Term: 12 months
Deposit Required: £4,250.00
Local Authority: London Borough of Camden
Council Tax Band: E
EPC Rating: C
Furnished

Chestertons Covent Garden Lettings
196 Shaftesbury Avenue
Covent Garden
London
WC2H 8JF
lettings.coventgarden@chestertons.com
02030408400

Carlton Mansions,
Shaftesbury Avenue

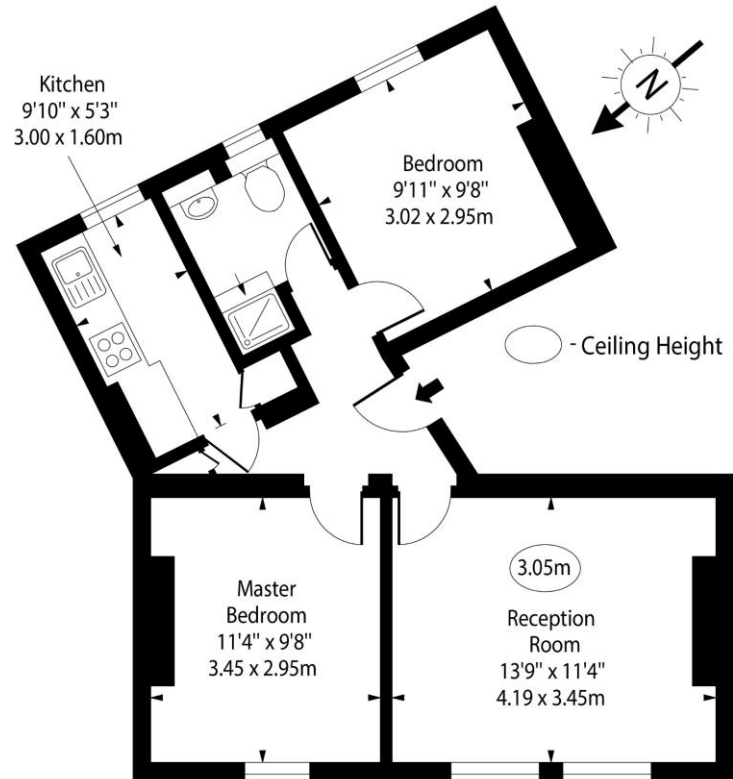

Second Floor

Approx Gross Internal Area 532 Sq Ft - 49.42 Sq M

For Illustration Purposes Only - Not To Scale

www.goldlens.co.uk

Ref. No. 017182E

Chesterton Global Ltd trading as Chestertons for themselves and for the vendor of this property whose agents they are, give notice that (i) these particulars do not constitute any part of an offer or contract, (ii) all statements contained within these particulars are made without responsibility on the part of Chestertons or the vendor, (iii) whilst made in good faith, none of the statements contained within these particulars are to be relied upon as a statement or representation of fact, (iv) any intending purchasers must satisfy themselves by inspection or otherwise as to the correctness of each of the statements contained within these particulars, (v) the vendor does not make or give either Chestertons or any person in their employment any authority to make or give representation or warranty whatsoever in relation to this property. Wide angle lenses may be used. ©Copyright Chestertons | Chesterton Global Ltd | Registered Office 40 Connaught Street, Hyde Park, London W2 2AB Registered Company Number 05334580.



This paper is
100% recyclable